

TECHNICAL INFORMATION



PRODUCT

P 1 / 12

Model No. ▶ JR100D (RJ01*1)/ JR102D

Description ▶ 10.8V Cordless Recipro Saw

*1: Model number for North and Central American countries except Mexico and Guam

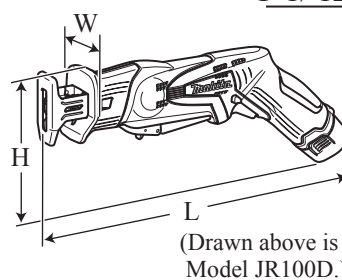

CONCEPT AND MAIN APPLICATIONS

Model JR100D (RJ01*1)/ JR102D are compact and lightweight 10.8V cordless reciprocating saws; JR100D (RJ01*1) is equipped with Toolless blade clamp while JR102D is equipped with Blade clamp for both Recipro saw and Jig saw blades.

Their advantages are:

- Toolless blade clamp for Recipro saw blade (model JR100D [RJ01*1] only)
- Blade clamp compatible with both Recipro saw and Jig saw blades (model JR102D only)
- Compact and lightweight handy body for comfortable operation
- Multi-position switch enables various grip position for versatile operations.

Dimensions: mm (")	
Length (L)	355 (14)
Width (W)	63 (2-1/2)
Height (H)	146 (5-3/4)

These products are available in the following variations.

Model No.	Battery		Charger	Plastic carrying case	Hex wrench	Housing color	Offered to
	type	quantity					
JR100DZ	BL1013 (Li-ion 1.3Ah)	No	No	No	No	Makita-blue	All countries except North and Central American countries (Mexico & Guam are included.)
JR100DWE		2	DC10WA	Yes			
RJ01Z	BL1014 (Li-ion 1.3Ah)	No	No	No	No	Makita-blue	North and Central American countries except Mexico and Guam
RJ01ZW						white	
RJ01		2	DC10WB	Yes	No	Makita-blue	
RJ01W						white	
JR102DZ	BL1013 (Li-ion 1.3Ah)	No	No	No	Yes	Makita-blue	All countries except North and Central American countries (Mexico & Guam are included.)
JR102DWE		2	DC10WA	Yes			

All models also include the accessories listed below in "Standard equipment".

Specification

Model No.		JR100D (RJ01*1)	JR102D
Battery	Cell	Li-ion	
	Voltage: V	10.8, (10.8/12Vmax*2)	
	Capacity: Ah	1.3	
	Energy capacity: Wh	14	
	Charging time (approx.): min.	50 with DC10WA, (DC10WB*2)	
Strokes per minutes: min. ⁻¹ = spm (strokes per minute)		0 - 3,300	
Length of stroke: mm (")		13 (1/2)	
Capacity: mm (")	Wood	50 (2)	
	Pipe: Ø	50 (2)	
Blade clamp type		Toolless	Hex wrench is required.
Jig saw blade compatibility		No	Yes
Switch lock		Lock-off	
Electric brake		Yes	
Variable speed control by trigger		Yes	
LED job light		Yes	
Weight according to EPTA-Procedure 01/2003: kg (lbs)		1.2 (2.6)	1.1 (2.5)

*1: Model number for North and Central American countries except Mexico and Guam

*2: for North and Central American countries except Mexico and Guam

Standard equipment

JR100D (RJ01*1)

[All countries]

Recipro saw blade 100mm (for wood) 1
Recipro saw blade 100mm (for metal) 1

JR102D

[All countries except Sweden, Finland, Estonia]

Recipro saw blade 100mm (for wood) 1
Recipro saw blade 100mm (for metal) 1
Hex wrench 3 1

JR102D

[Sweden, Finland, Estonia]

Jig saw blade B-10 (for wood) 1
Jig saw blade B-18 (for wood) 1
Jig saw blade B-24 (for metal) 1
Hex wrench 3 1

Note: The standard equipment for the tool shown above may vary by country.

Optional accessories

Charger DC10WA (DC10WB for North and Central American countries except Mexico and Guam)

Battery BL1013 (BL1014 for North and Central American countries except Mexico and Guam)

Recipro saw blades, Jig saw blades (for JR102D only)

► Repair

CAUTION: Repair the machine in accordance with “Instruction manual” or “Safety instructions”.

[1] NECESSARY REPAIRING TOOLS

Code No.	Description	Use for
1R132	Nose 15-20	removing Ball bearing 6902ZZ from Gear housing
1R258	V Block	holding Gear housing when removing 6902ZZ.
1R281	Round Bar for Arbor 7-50	removing Ball bearing 6902ZZ from Gear housing

[2] LUBRICATION

Apply **Makita grease N. No.2** to the following portions designated with the black triangles to protect parts and product from unusual abrasion.

Item No.	Description	Portion to lubricate	Amount
⑧	Shoulder pin 5	Whole surface of Pin for smooth twisting of Driving sleeve	a little
②⑥	Slider	To the portion where Slider guide and Collared sleeve contacts	a little
②⑧	Gear complete	① To the teeth portion	5 g
		② To the Pin portion	a little

Fig. 1

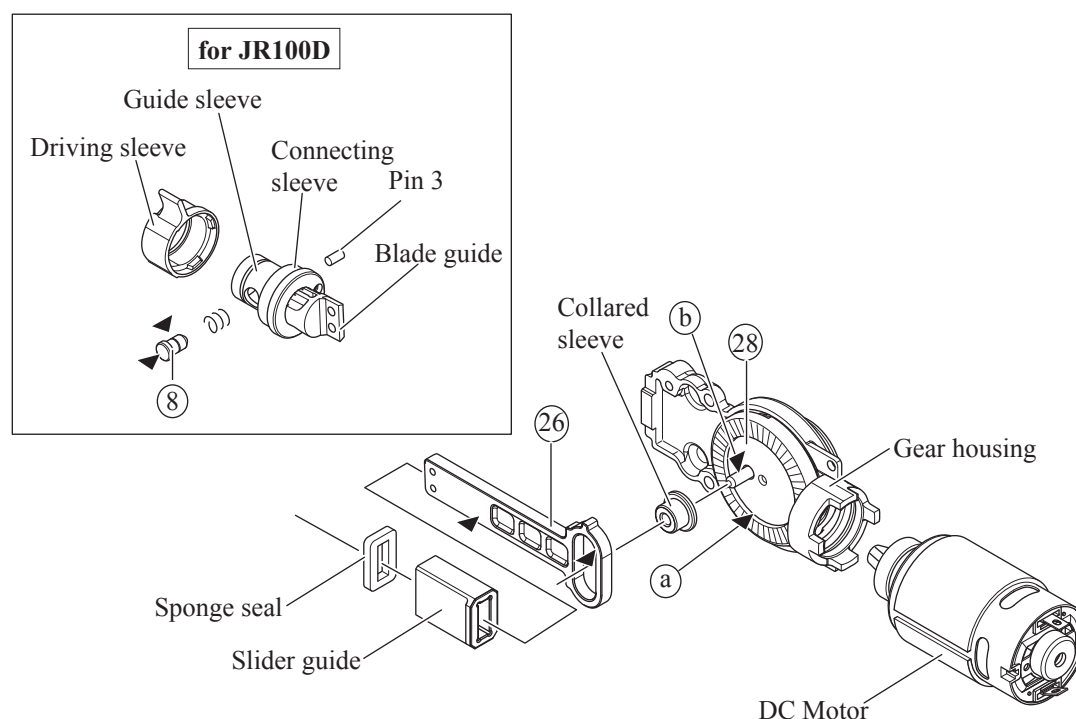

► Repair

[3] DISASSEMBLY/ASSEMBLY

[3] -1. Slider (cont.)

DISASSEMBLING

Fig. 2

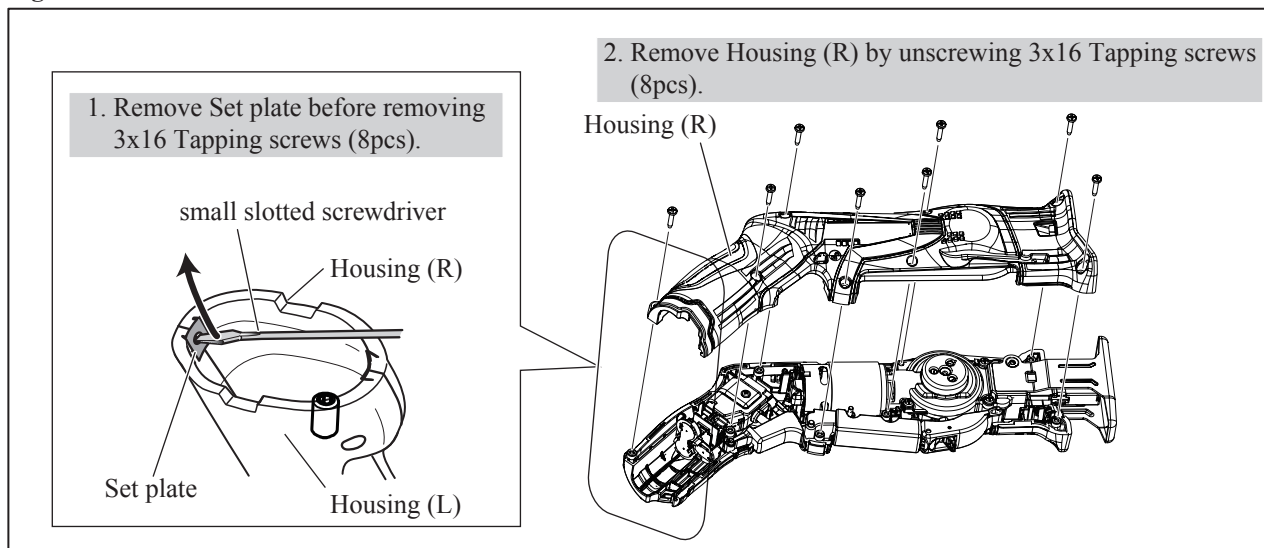

Fig. 3

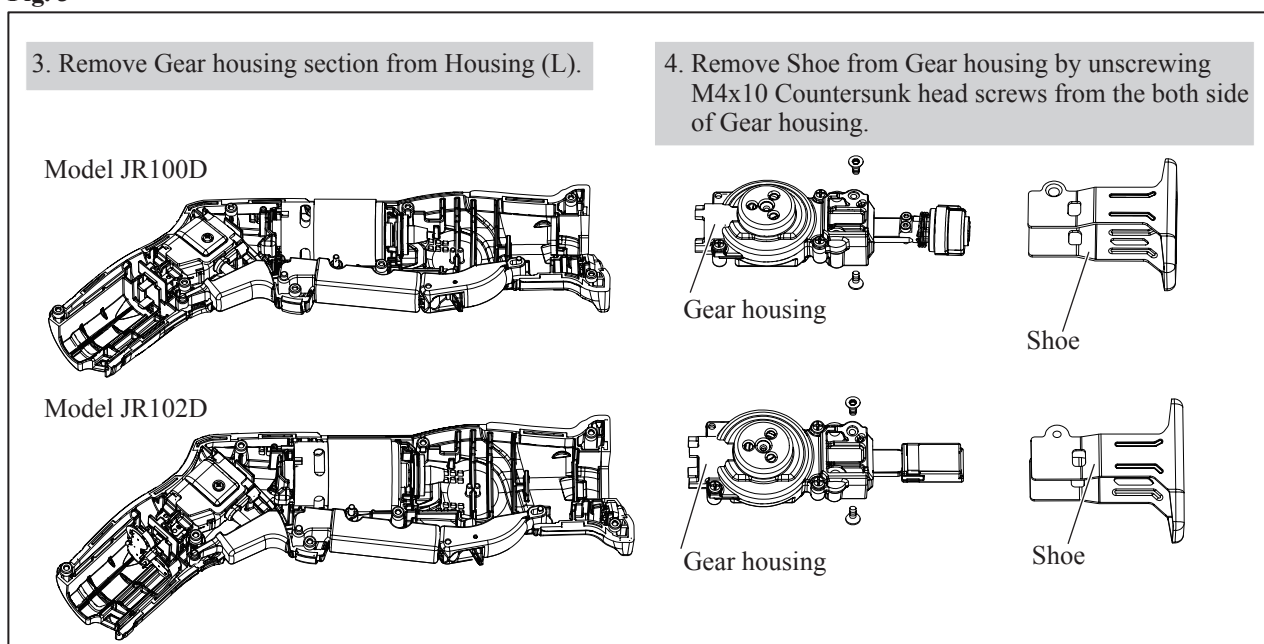
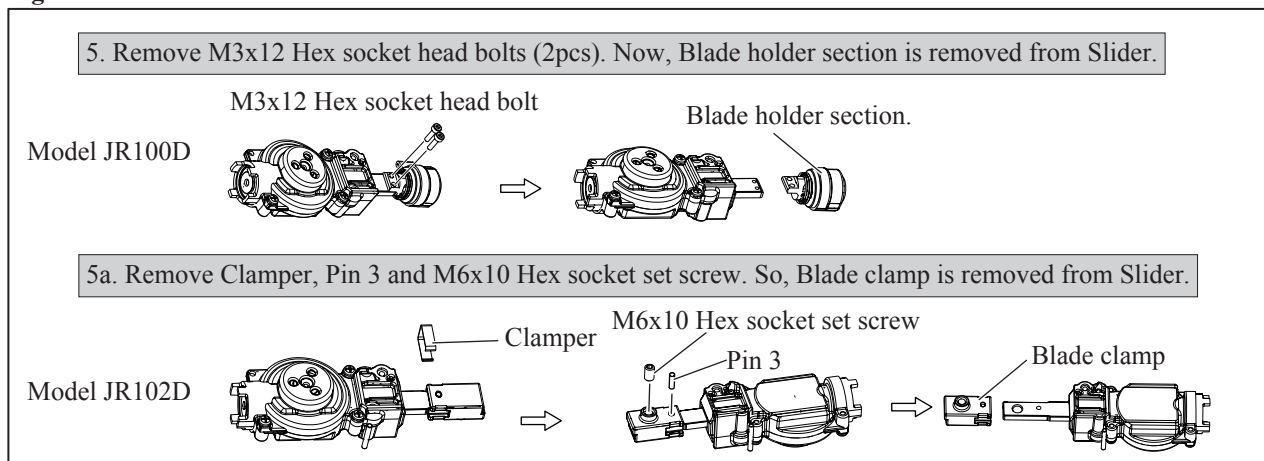

Fig. 4



► Repair

[3] DISASSEMBLY/ASSEMBLY

[3] -1. Slider (cont.)

DISASSEMBLING

Fig. 5

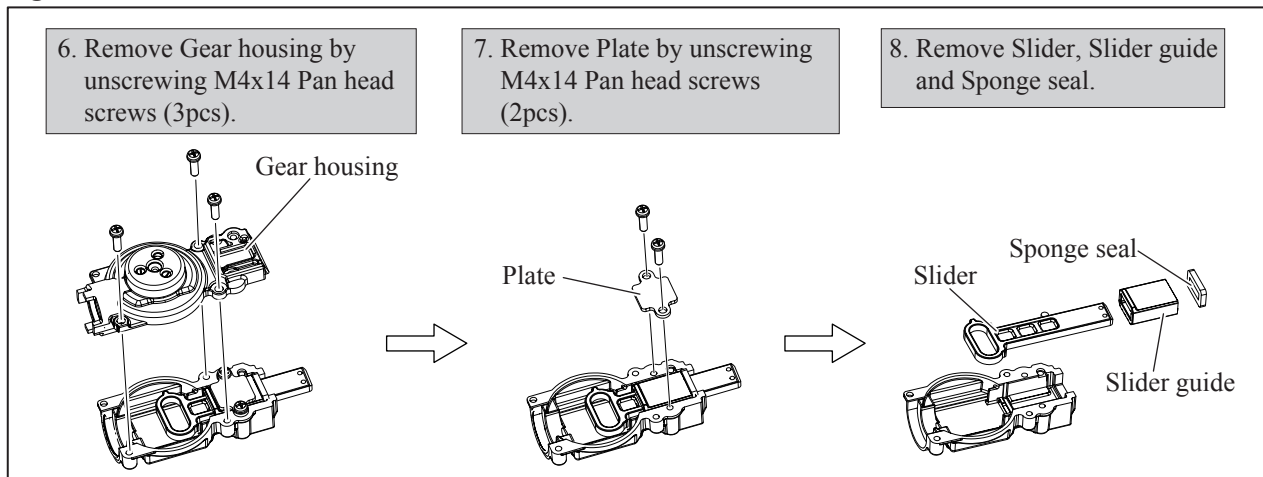

ASSEMBLING

(1) Assemble Slider guide and Sponge seal to Slider (**Fig. 6**).

Fig. 6

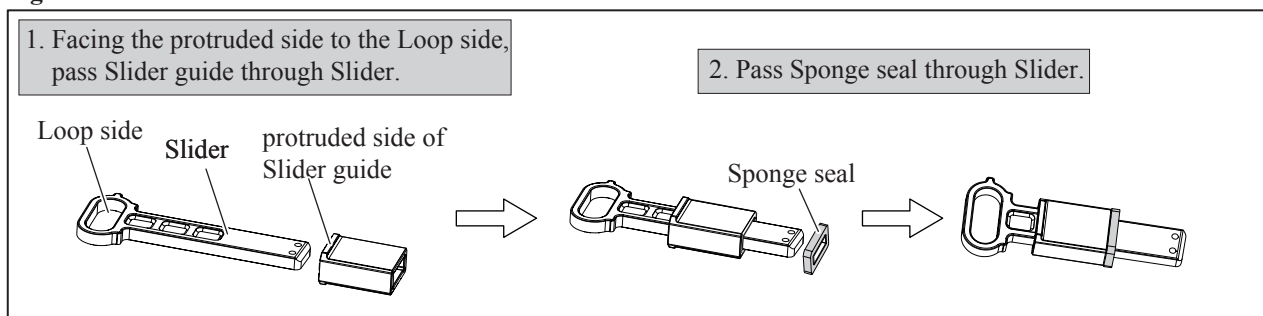

(2) Assemble the Slider to Gear housing cover (**Fig. 7**).

Fig. 7

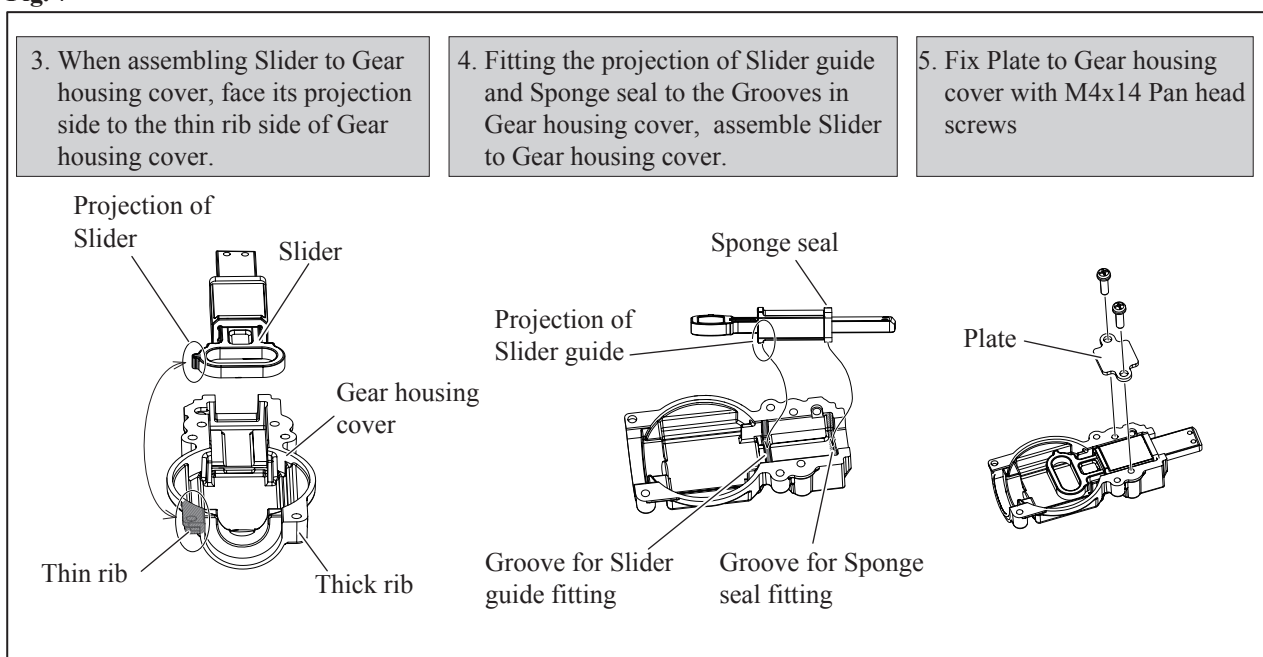

► Repair

[3] DISASSEMBLY/ASSEMBLY

[3] -1. Slider (cont.)

ASSEMBLING

(3) Assemble Gear housing cover to Gear housing (Fig. 8).

Fig. 8

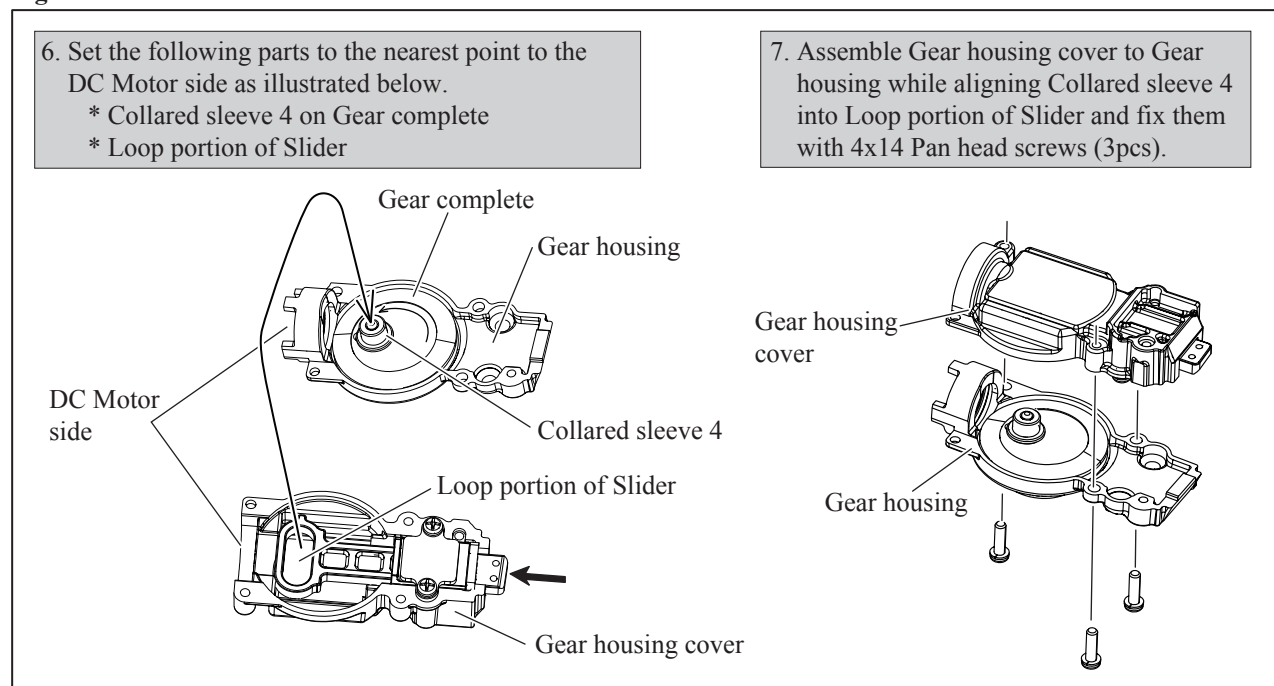

(4) Assemble Blade holder section or Blade clamp to Slider (Fig. 9).

Fig. 9

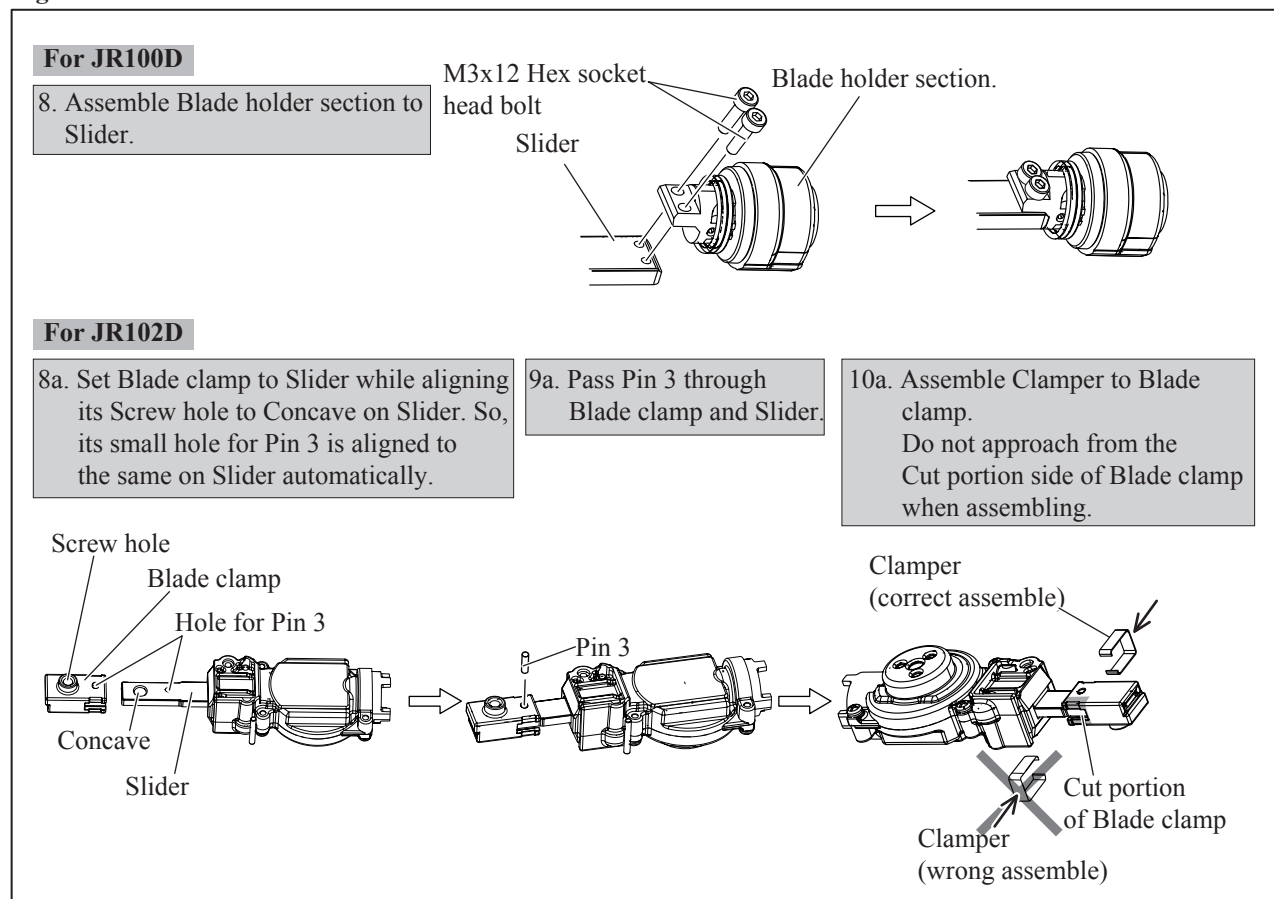

► Repair

[3] DISASSEMBLY/ASSEMBLY

[3] -2. Gear complete

DISASSEMBLING

- (1) Disassemble Housing (R) from Housing (L) and remove Gear housing section from Housing (L) (**Fig. 2, 3, 4.**)
- (2) Remove Gear housing from Gear housing cover (**Fig. 5-6.**)
- (3) Put Gear housing on 1R258 and remove Gear complete with Arbor press (**Fig. 10 or Fig. 10A.**)

Fig. 10

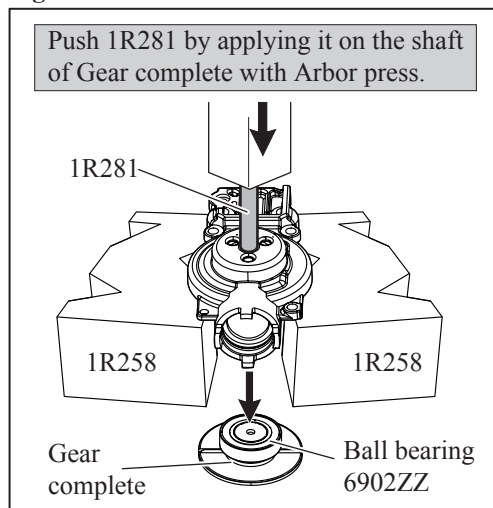
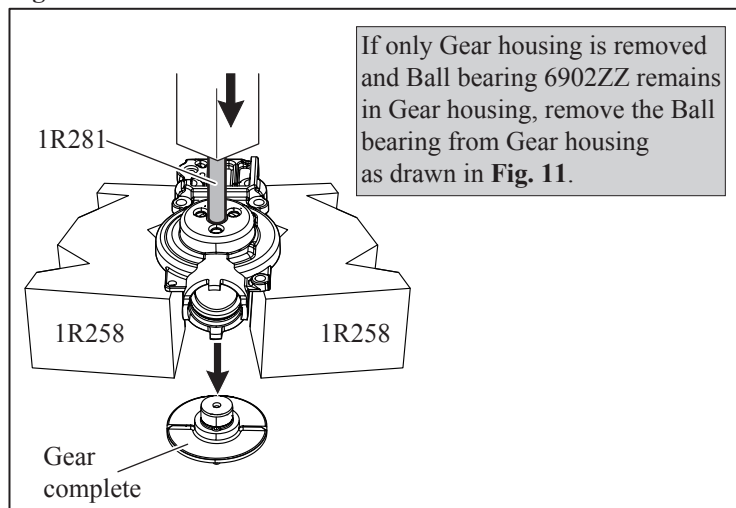
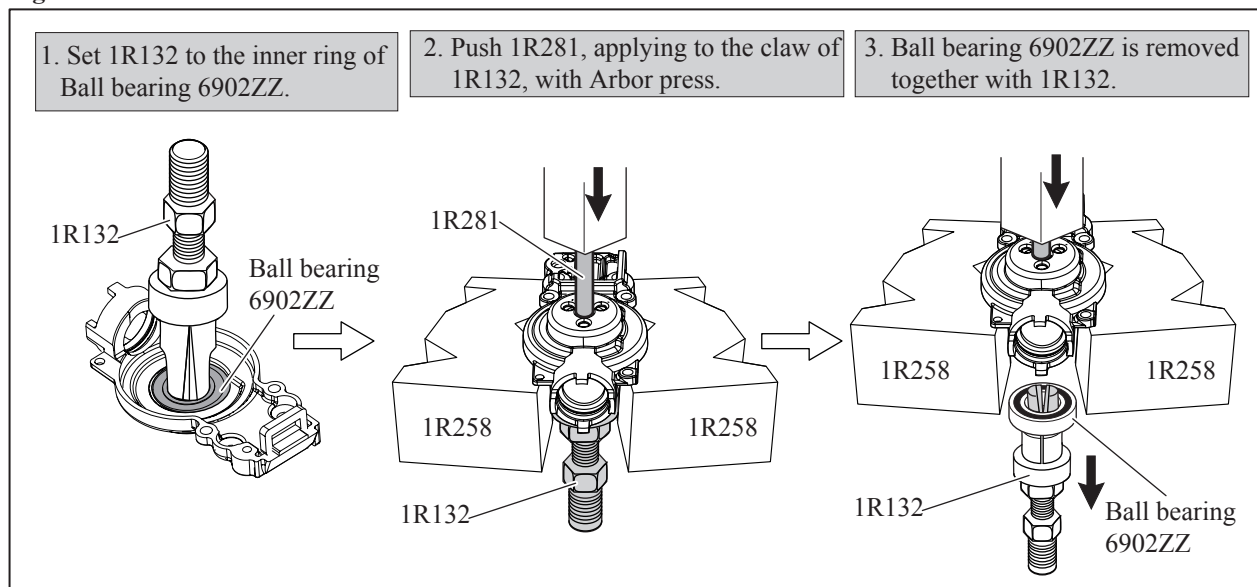

Fig. 10A



- (4) Remove Ball bearing 6902ZZ by applying 1R132 to the inner ring of Ball bearing 6902ZZ (**Fig. 11.**)

Fig. 11



ASSEMBLING

- (1) Assemble Ball bearing 6902ZZ to Gear housing (**Fig. 11.**)
- (2) Assemble Gear complete to the Ball bearing 6902ZZ (**Fig. 10A.**)

► Repair

[3] DISASSEMBLY/ASSEMBLY

[3] -3. Toolless Blade Holder Section (Model JR100D)

DISASSEMBLING

- (1) Disassemble Housing (R) from Housing (L) and remove Gear housing section from Housing (L) (**Fig. 2, 3**).
- (2) Remove Shoe from Gear section by unscrewing M4x10 Countersunk head screws (**Fig. 3**).
- (3) Disassemble Toolless blade holder section (**Fig. 12**).

Fig. 12

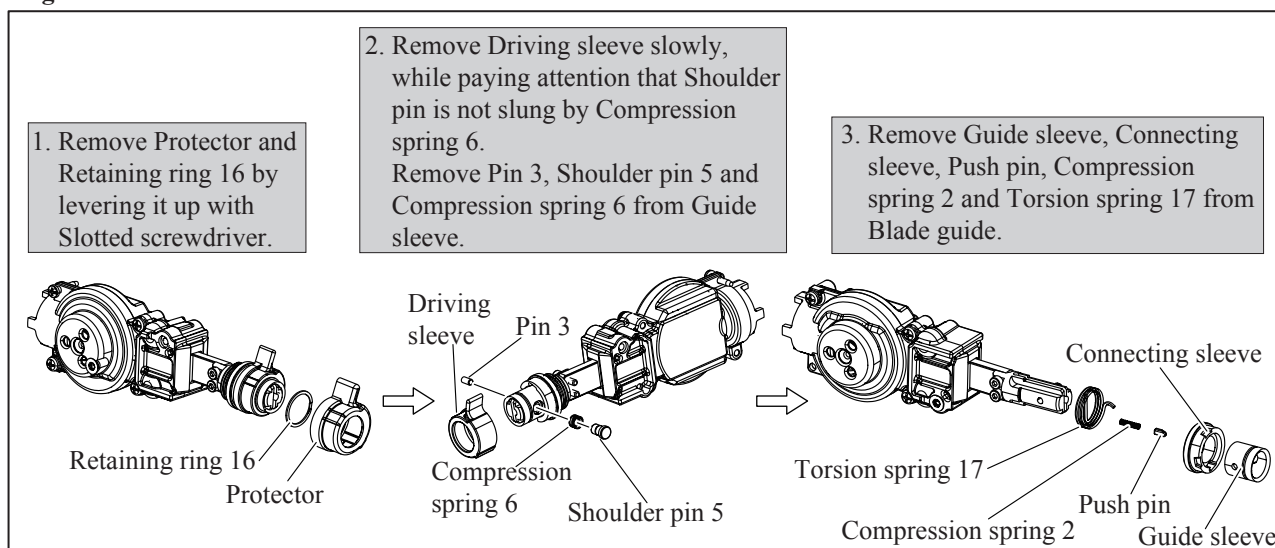

ASSEMBLING

- (1) Assemble Blade guide to Slider (**Fig. 9**) in case Blade guide is removed from Slider.
- (2) Mount Torsion spring 17 and Connecting sleeve to Blade guide. And then, insert Compression spring 2 and push pin (**Fig. 13**).

Fig. 13

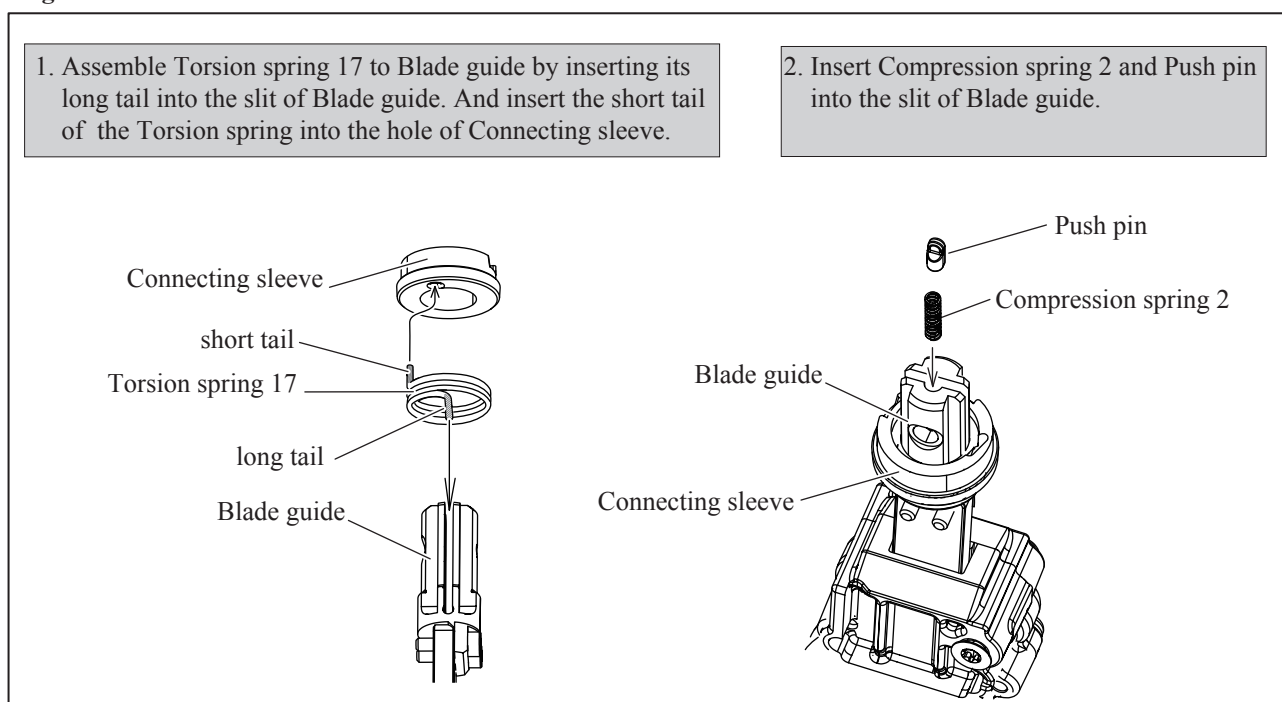

► Repair

[3] DISASSEMBLY/ASSEMBLY

[3] -3. Toolless Blade Holder Section (Model JR100D) (cont.)

ASSEMBLING

(2) Do further step for Assembling in the order of **Fig. 14, 15, 16, 17, 18.**

Fig. 14

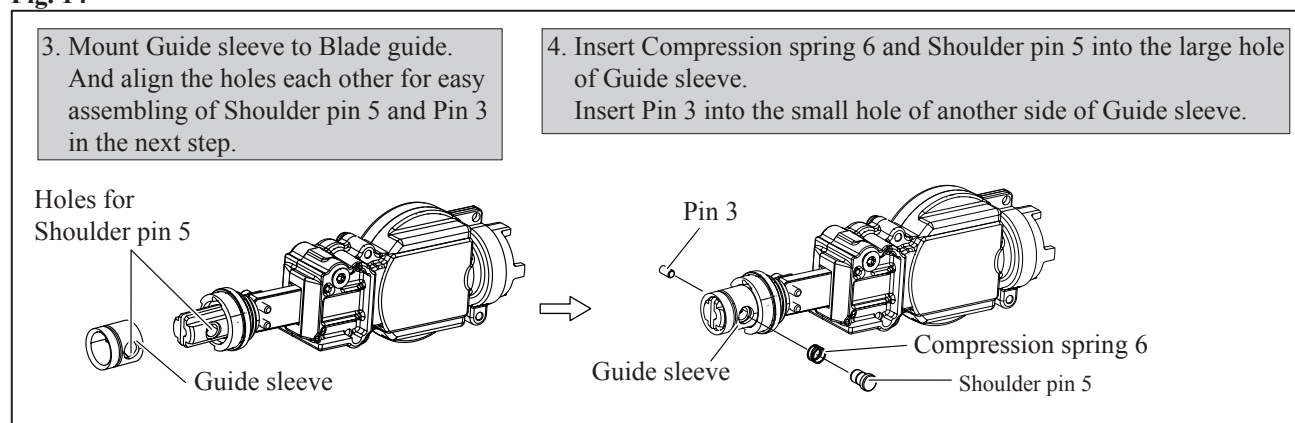

Fig. 15

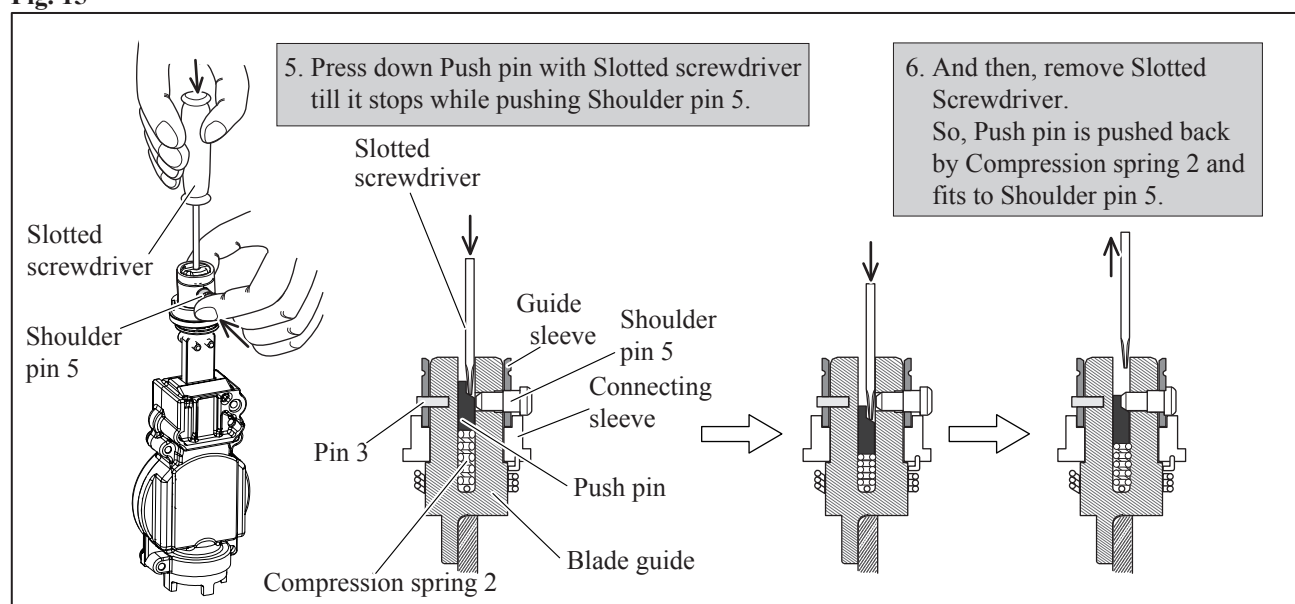
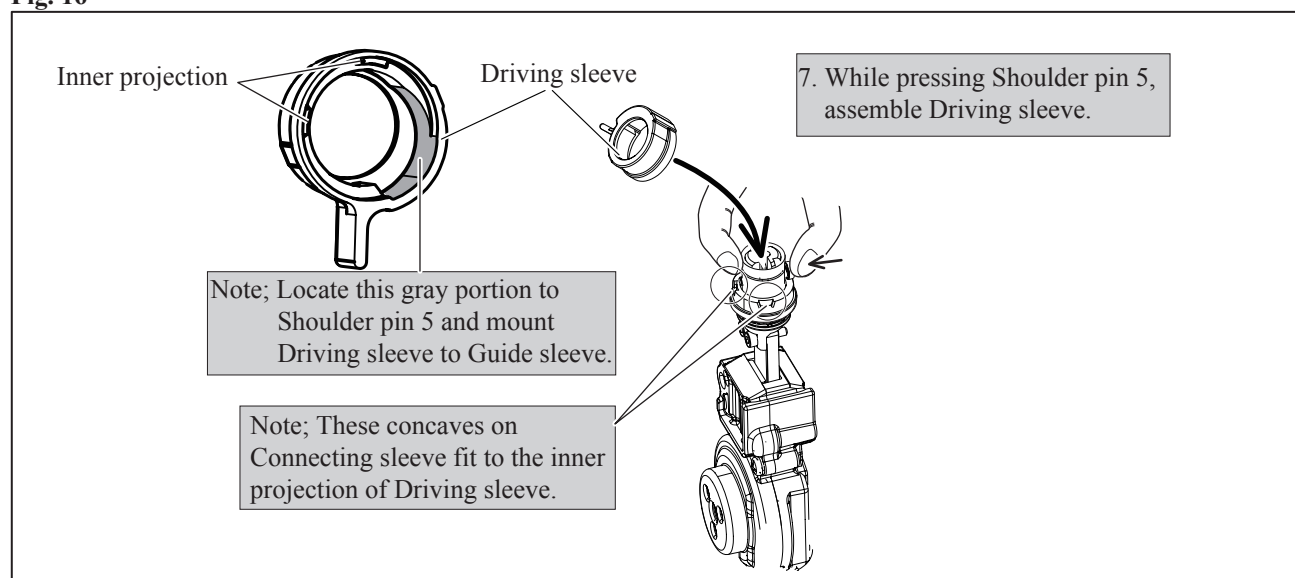

Fig. 16



► Repair

[3] DISASSEMBLY/ASSEMBLY

[3] -3. Toolless blade holder section (Model JR100D) (cont.)

ASSEMBLING

(1) Assemble Blade guide to Slider in case Blade guide is removed from Slider (**Fig. 9**).

Fig. 17

8. Hold Gear housing with vise and grip Connecting sleeve with Water pump pliers over a cloth so as not to damage it. Turn **Driving sleeve 90 degrees** while pressing it down. Now, Protrusions in the Driving sleeve precisely match to Depressions on Connecting sleeve and groove for Retaining ring 16 on Guide sleeve comes into your sight as drawn in **Fig. 18**.

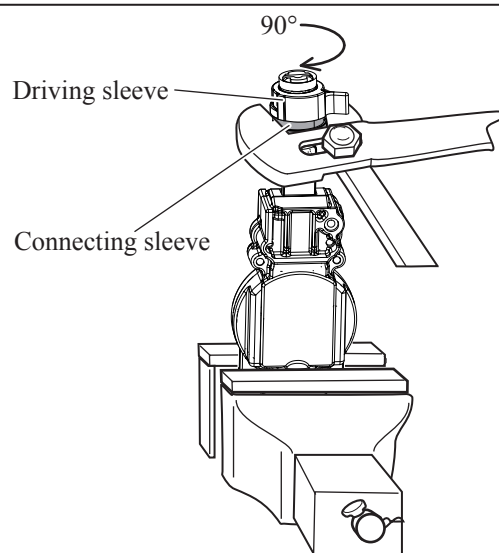
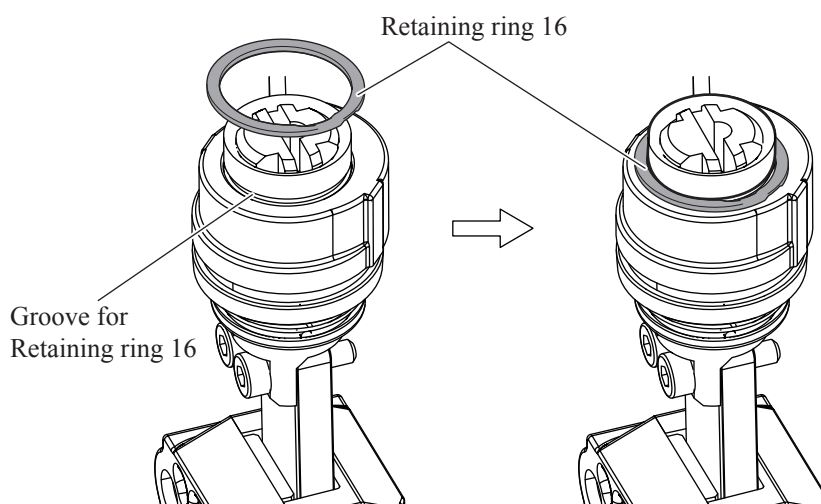

Fig. 18

9. Mount the Retaining ring 16 as drawn below.



► Repair

[3] DISASSEMBLY/ASSEMBLY

[3] -4. Switch lever F complete

DISASSEMBLING

- (1) Disassemble Housing (R) (**Fig. 2**).
- (2) Remove Switch lever section from Housing (L) and disassemble it as drawn in **Fig. 19**.

Fig. 19

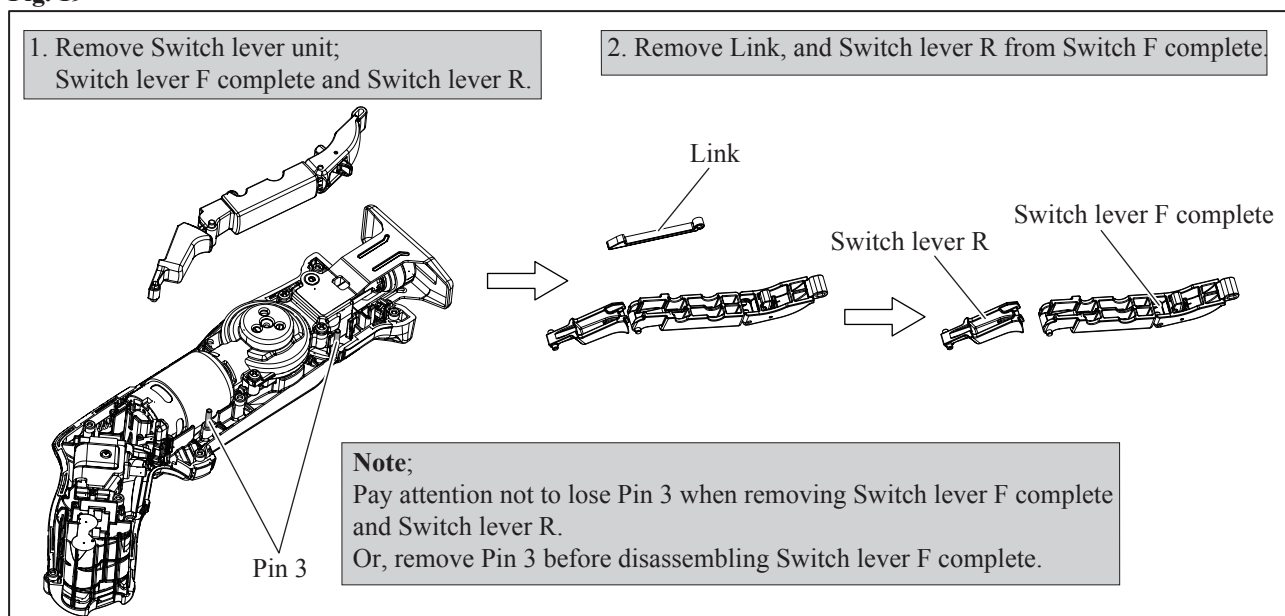

ASSEMBLING

- (1) Mount Link to Switch lever F complete, and Switch lever R to the Link.
Assemble Switch lever unit to Housing (L).

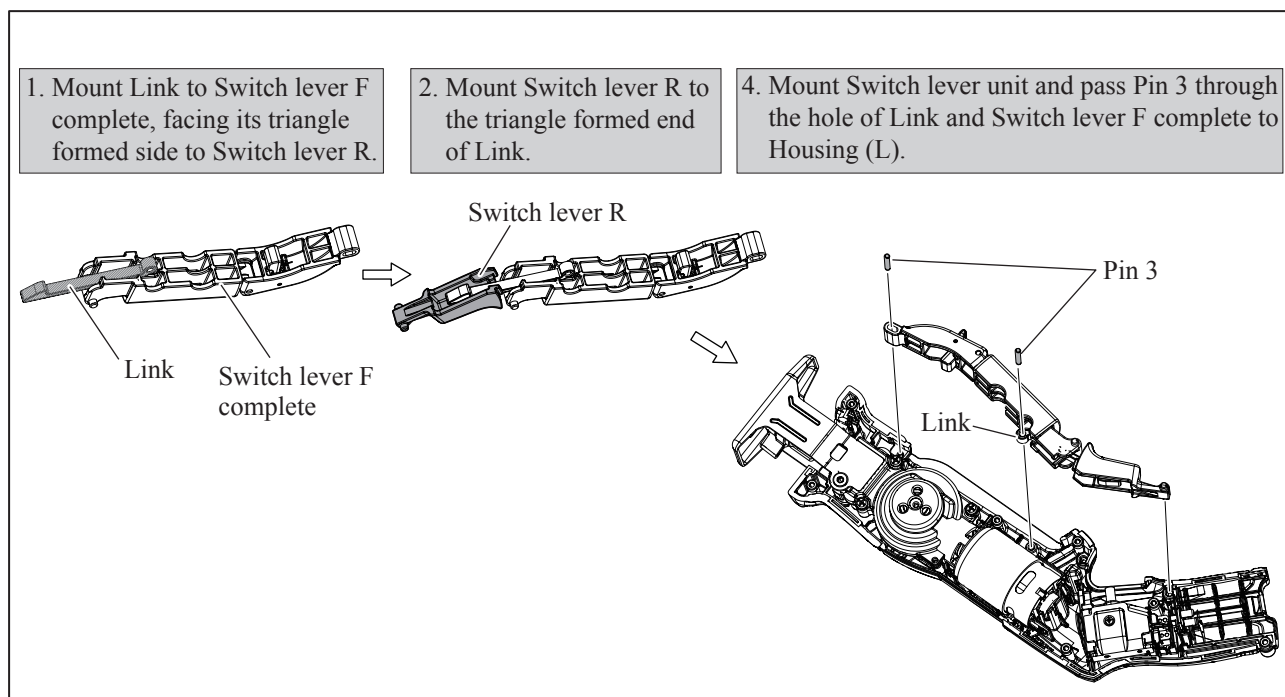

► Circuit diagram

Fig. D-1

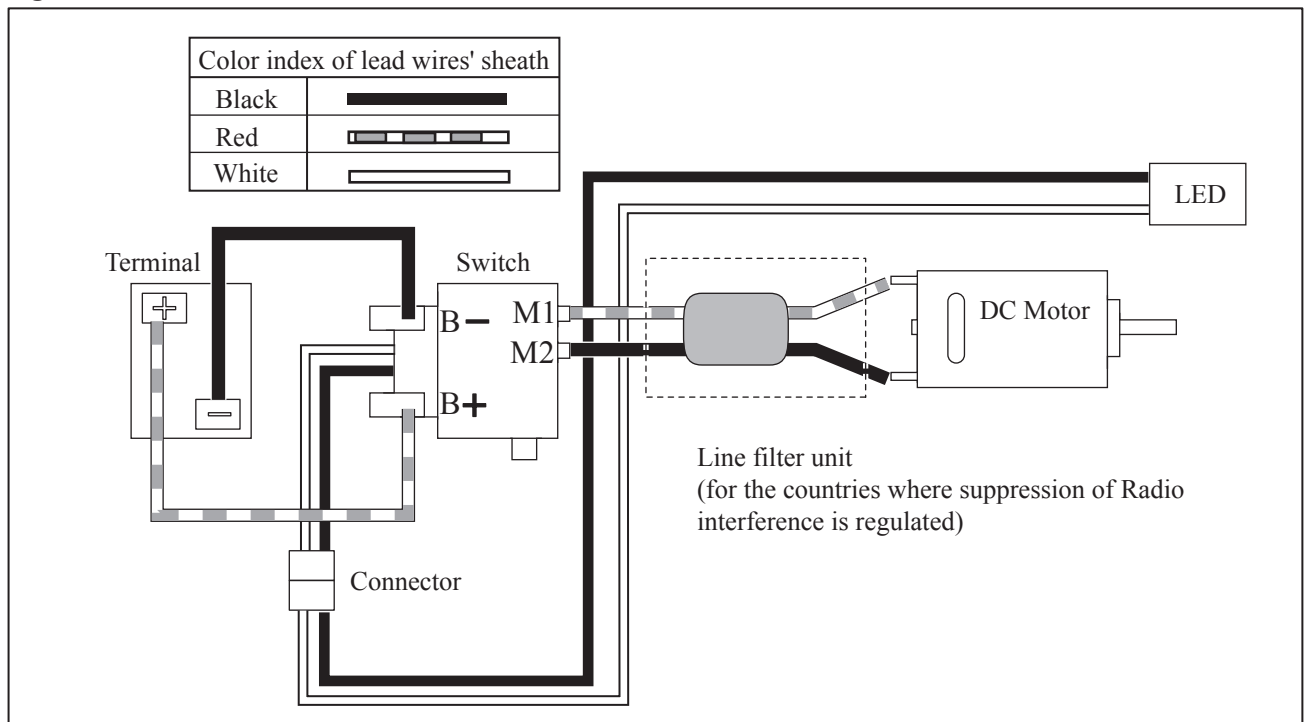

► Wiring diagram

Fig. D-2

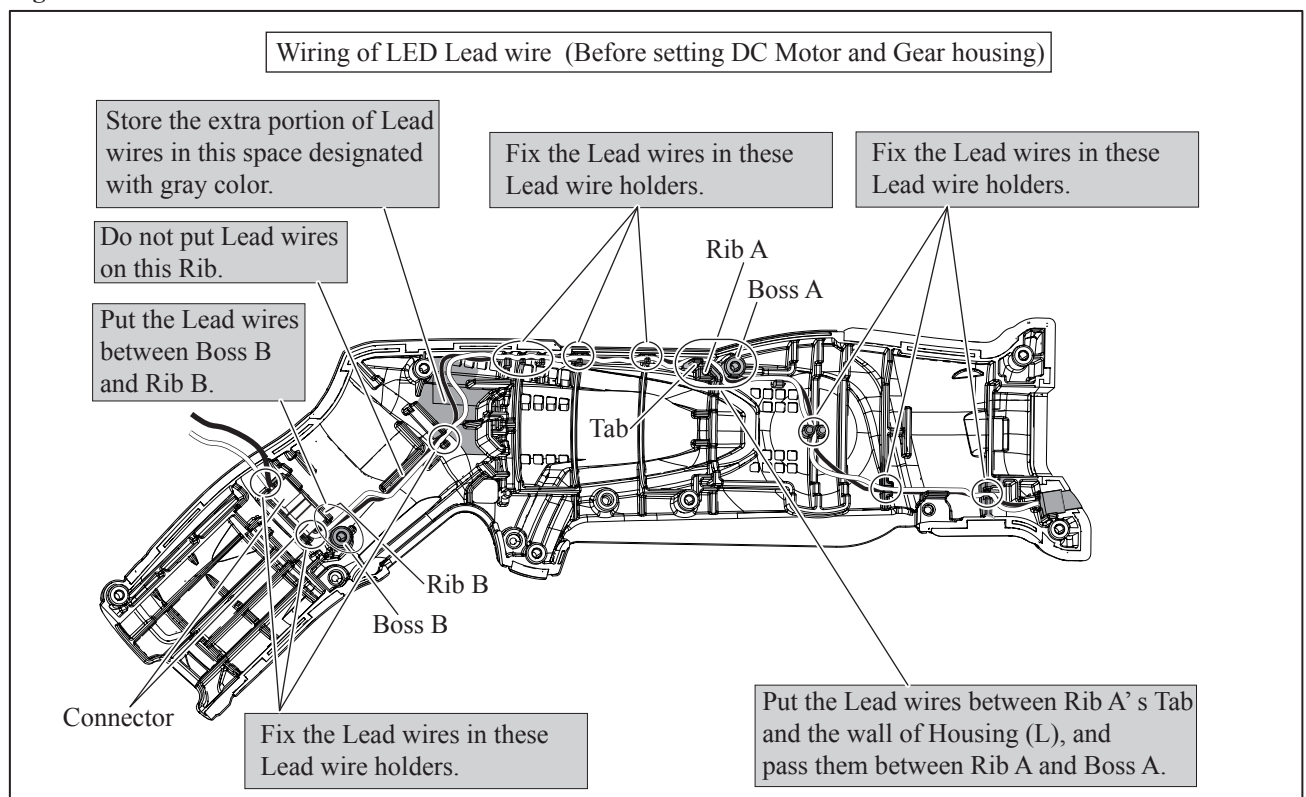

► Wiring diagram (cont.)

Fig. D-3

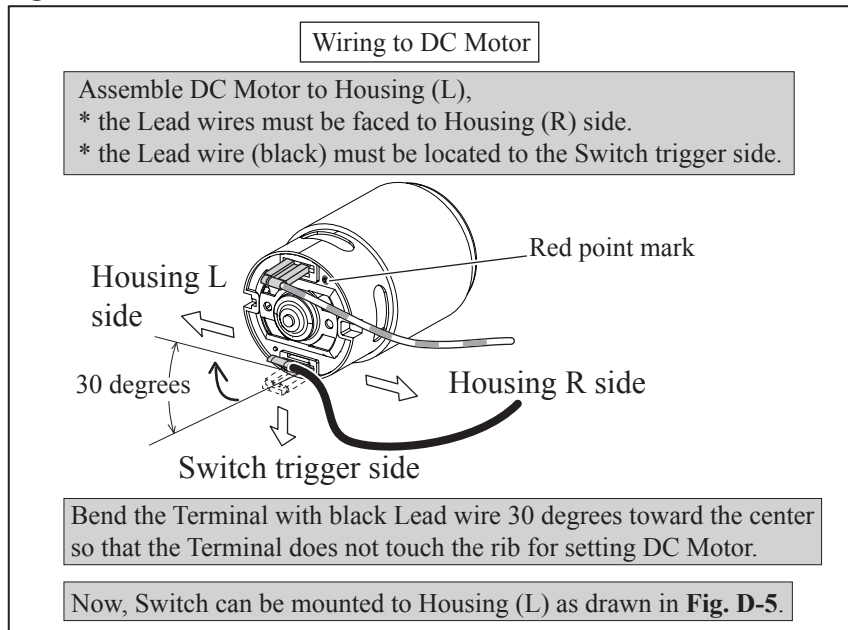

Fig. D-4

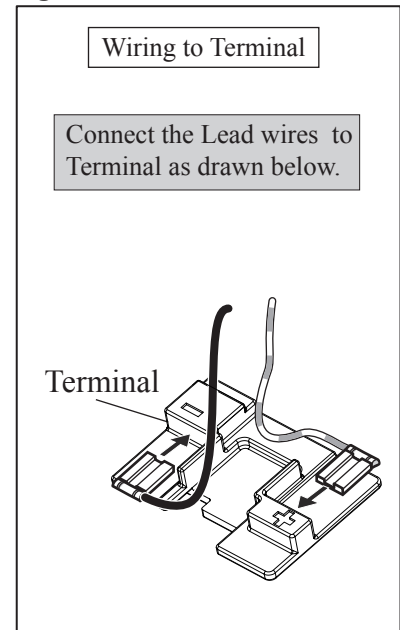

Fig. D-5

