

TECHNICAL INFORMATION



New Tool

Models No. ▶ HR3850B

Description ▶ 38mm(1-1/2") Rotary hammer

CONCEPTION AND MAIN APPLICATIONS

HR3850B is a sister version of model HR3850 and designed to adopt Bosch's spline shaft bit. A thin handle rod is comfortably fit operator's hands.

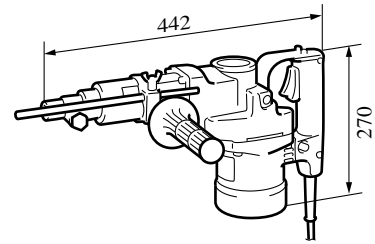

▶ Specifications

Voltage (V)	Current (A)	Cycle (Hz)	Continuous Rating (W)		Max. Output(W)
			Input	Output	
100	11	50/60	1050	580	800
115	8.7	50/60	940	520	800
200	5	50/60	940	520	800
220	4.5	50/60	940	520	800
230	4.3	50/60	940	520	800
240	4.1	50/60	940	520	800
115	10	50/60	1090	570	890

No load speed	240/min
Number of blows per minute	2900/min (In the case of a rated load.)
Overall length	442mm (17-3/8")
Net weight	7.5kg (16.5lbs)
Power supply cord	5m (16.4ft)

▶ Standard equipment

Blow-out bulb (evacuation of cut chips), depth gauge (positioning of drilled depth)
hex. wrench 4.5 (removal of hex. socket head bolt), Steel made green case

▶ Optional accessories

Tungsten drill 16 to 38, Core bit 40 to 118, Cold chisel, Scaling chisel, Grooving chisel, Bushing tool, Bull point, Clay spade, Rammer, Anchor adapter, Taper shank adapter, Makita grease, Lock nut wrench 3.5

▶ Repair

- When tightening a hexagonal bolt M8x12 for fixing a tool retainer, coat some adhesive 'Screw Lock Super 20Q' (TB1321B).
- Other procedures for repair work are same as HR3850.