

TECHNICAL INFORMATION



PRODUCT

P 1 / 5

Models No. ▶ BUB142

Description ▶ Cordless Blower 14.4V

CONCEPT AND MAIN APPLICATIONS

Models BUB142 has been developed as the successor model to the current Model UB141D, featuring renewed external appearance. Instead of Ni-Cd or Ni-MH battery, uses 14.4V Li-ion battery as a power unit; both 1.5Ah battery BL1415 and 3.0Ah battery BL1430 can be used.

This product is available with the following Model number and specifications.

Model No.	Charger	Battery	Battery cover
BUB142Z	No	No	No

The model also includes the accessory listed below in "Standard equipment".

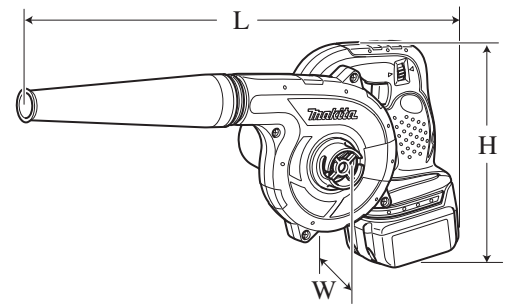

Dimensions: mm (")	
Length (L)	507 (20)*1/ 509 (20)*2
Width (W)	155 (6-1/8)
Height (H)	196 (7-3/4)*1/ 212 (8-3/8)*2

*1 with Battery BL1415
*2 with Battery BL1430

► Specification

Model No.		BUB142
Battery	Voltage: V	14.4
	Capacity: Ah	1.5*1/ 3.0*2
	Cell	Li-ion
	Charging time (approx.): min.	15*1/ 22*2 with DC18RA
No load speed: min. ⁻¹ = rpm		0 - 18,000
Max air volume: m ³ /sec (m ³ /min.) [ft ³ /min.]		0.043 (2.6) [91]
Max air velocity: m/sec		80
Max air pressure: kPa (mmH ₂ O)		5.4 (550)
Air volume setting dial		Yes (3 settings: High/ Medium/ Low)
Continuous run time (approx.) on a single full battery charge in each air volume setting; High/ Medium/ Low: min.		5/ 10/ 30*3 10/ 20/ 60*4
Vacuum function		Yes
Variable speed control by trigger		Yes
Net weight [with battery]: kg (lbs)		1.5 (3.3)*1/ 1.7 (3.7)*2

*1 with Battery BL1415

*2 with Battery BL1430

*3 with Battery BL1415, when used as a blower

*4 with Battery BL1430, when used as a blower

► Standard equipment

Nozzle assembly (220mm) 1

Note: The standard equipment for the tool shown above may differ by country.

► Optional accessories

Fast charger DC18RA

Charger DC18SD

Charger DC24SA (for North America only)

Charger DC24SC (for all countries except North America)

Li-ion Battery 1430

Li-ion Battery 1415

Anchor nozzle

Flexible hose set

Dust bag

Nozzle assembly (220mm)

Nozzle assembly (430mm)

► **Repair**

CAUTION: Remove the battery from the machine for safety before repair/ maintenance in accordance with the instruction manual!

[1] NECESSARY REPAIRING TOOLS

Code No.	Description	Use for
1R309	Spring Pin Extractor	Locking Fan when removing M5x8 Pan head screw

[2] LUBRICATIONS

No need to lubricate.

[3] DISASSEMBLY/ASSEMBLY

[3]-1. Fan housing set and Fan 86

DISASSEMBLING

- (1) Remove nozzle assembly.
- (2) Remove Fan housing set and Fan 86 as illustrated in **Figs. 1 and 2.**

Fig. 1

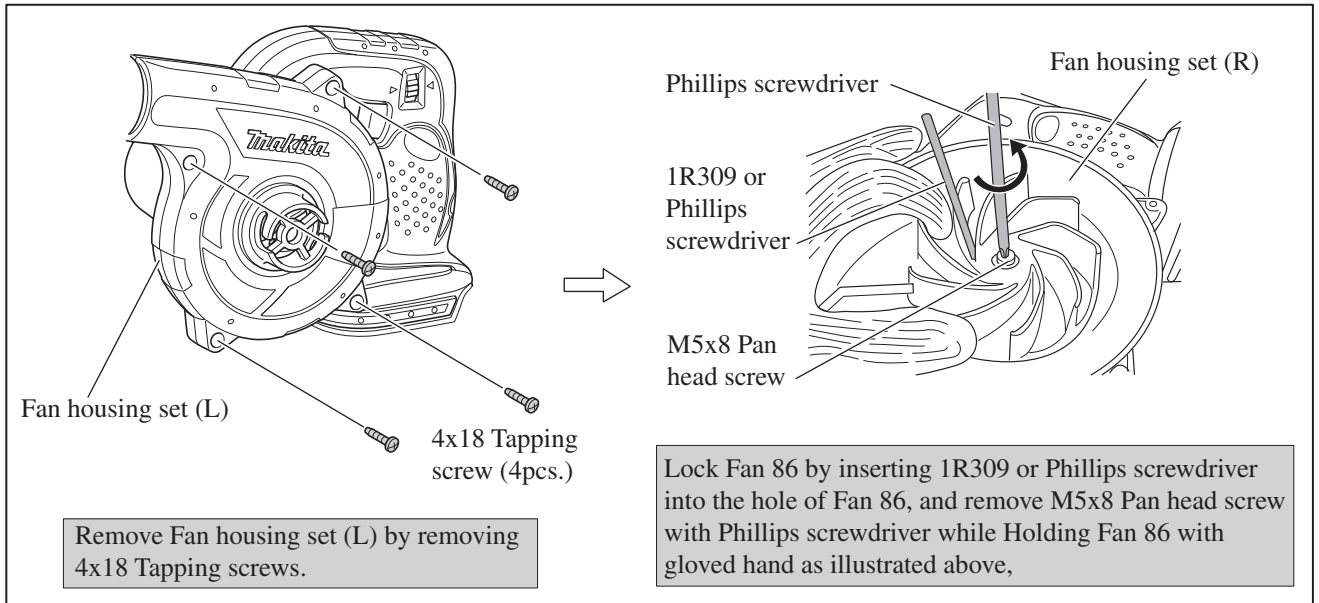
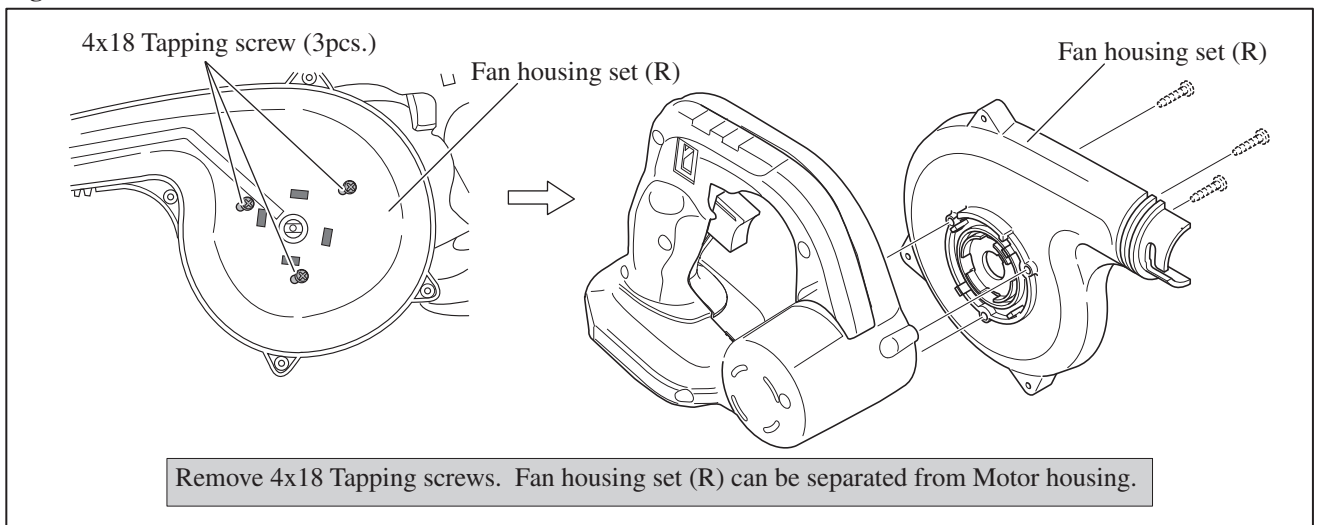

Fig. 2



ASSEMBLING

Take the disassembling step in reverse. Refer to **Figs. 2 and 1.**

► Repair

[3] DISASSEMBLY/ASSEMBLY

[3]-2. DC Motor

DISASSEMBLING

- (1) Remove Fan housing set (L), Fan 86 and Fan housing set (R) as illustrated in **Figs. 1 and 2**.
- (2) DC motor can be disassembled from Motor housing as illustrated in **Figs. 3 and 4**.

Fig. 3

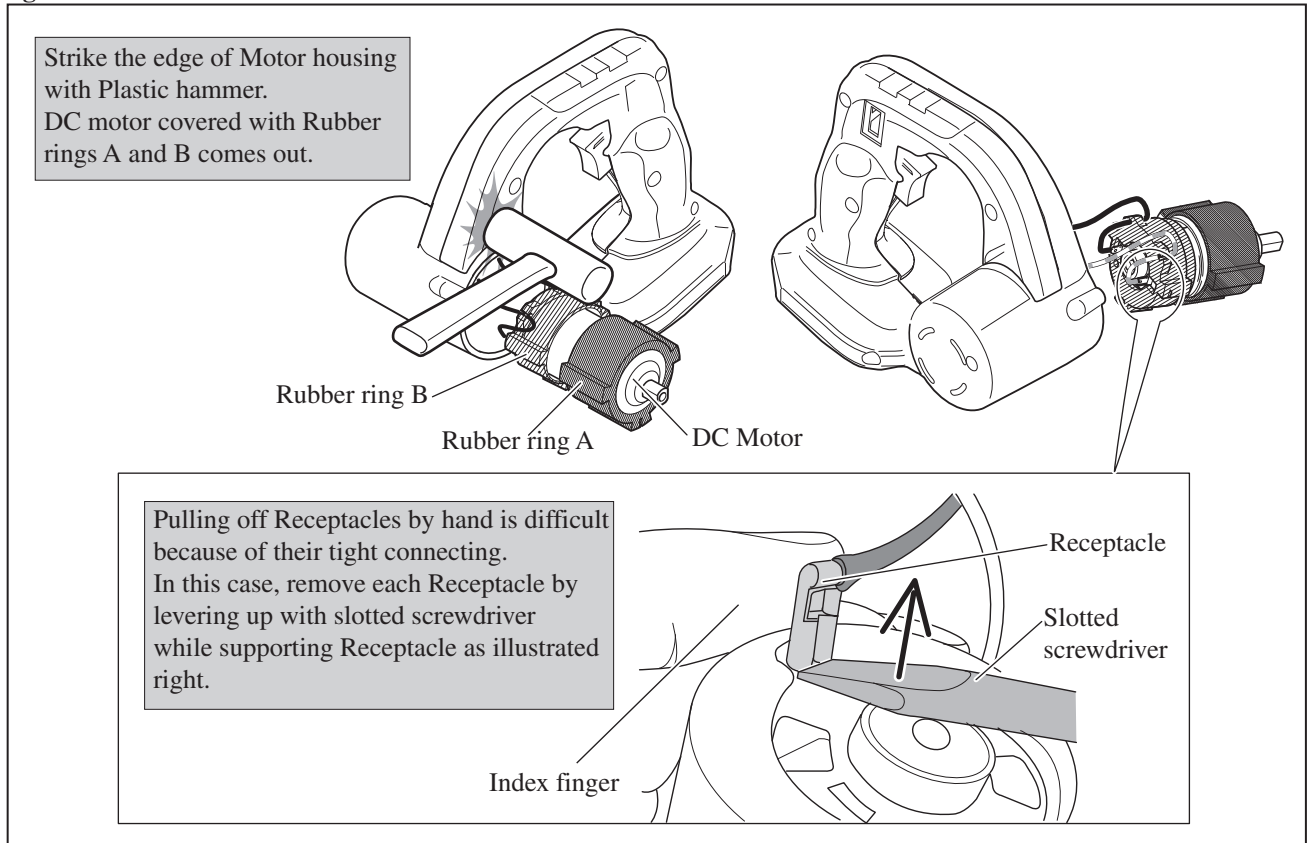
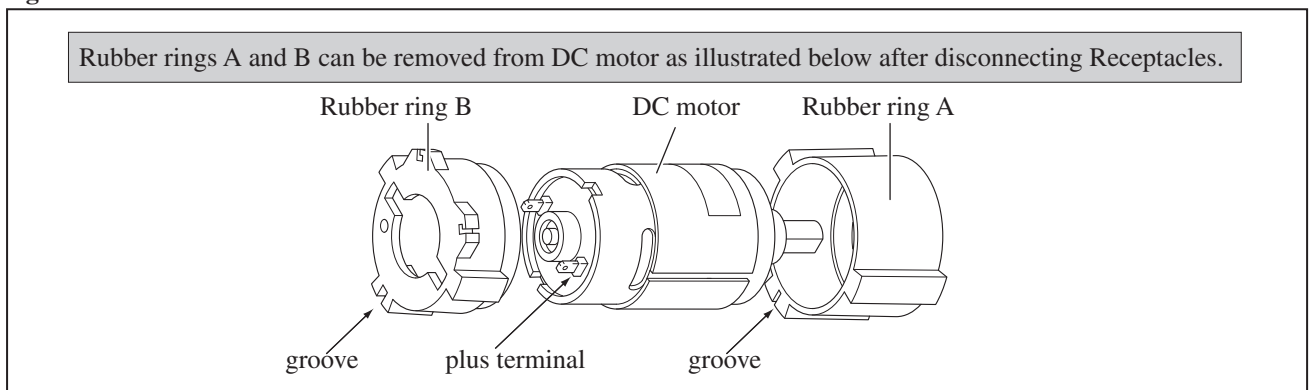

Fig. 4



ASSEMBLING

Align the grooves of Rubber ring A and Rubber ring B, then fit DC motor into the Rubber rings so that the plus terminal comes to the right side viewed from the grooves of Rubber rings. Refer to **Fig. 4**.

After connecting Lead wires with the terminals of DC motor, fix Lead wires with lead wire holders on Rubber ring B as illustrated in **Fig. 5**.

Fig. 5

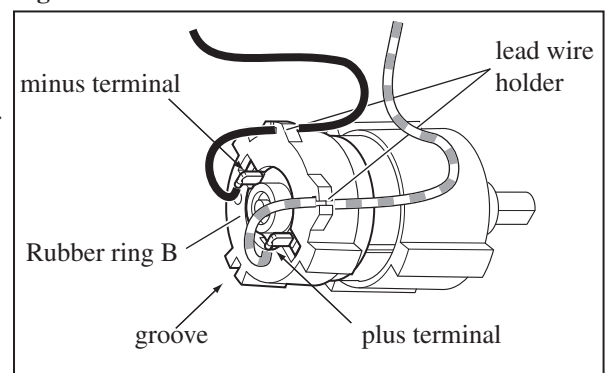

► **Repair**

[3] DISASSEMBLY/ASSEMBLY

[3]-3. Electrical Parts in Handle Section

The electrical parts in Handle section can be disassembled / assembled as illustrated in **Fig. 6**.

Fig. 6

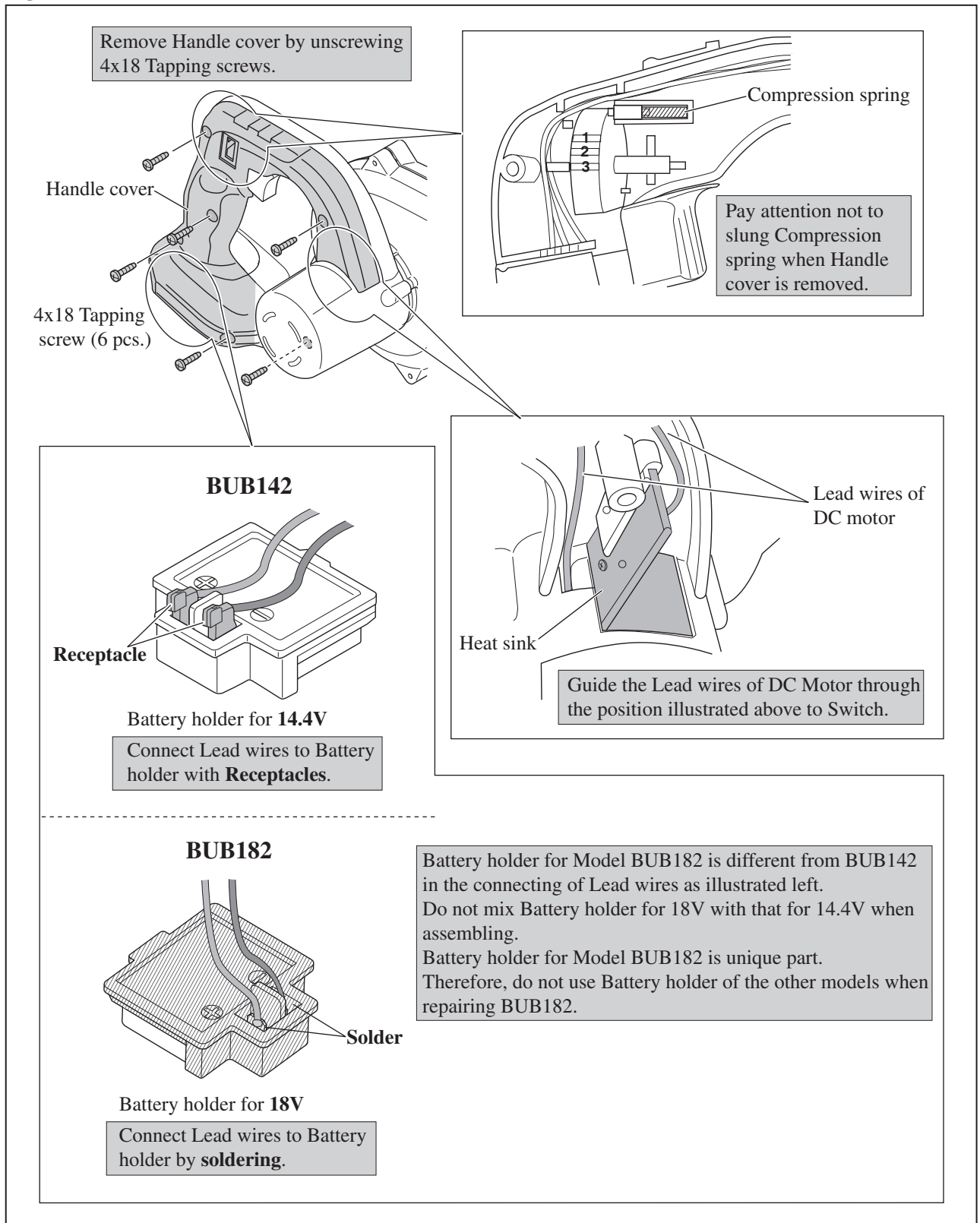

► **Circuit diagram**

Fig. D-1

