

► Repair

CAUTION: Remove the battery cartridge from the machine for safety before repair/ maintenance in accordance with the instruction manual!

[3] DISASSEMBLY/ASSEMBLY

[3]-1. Capsule Section

DISASSEMBLING

Capsule section can be disassembled as illustrated in **Fig. 1**.

Fig. 1

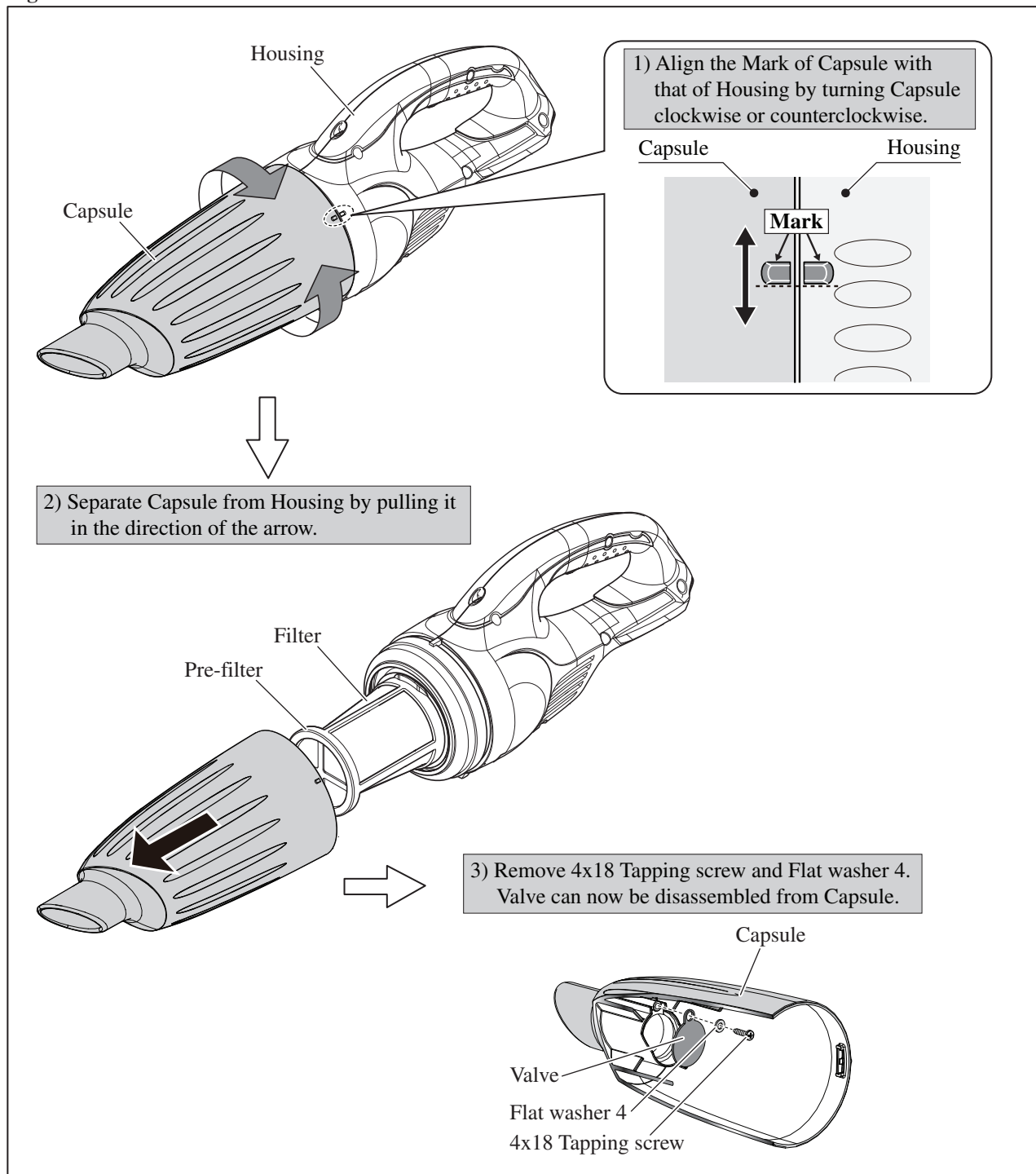

ASSEMBLING

Do the reverse of the disassembly steps. (**Fig. 1**)

► Repair

[3] DISASSEMBLY/ASSEMBLY

[3] -2. Motor Section

DISASSEMBLING

- 1) Disassemble Capsule section as illustrated in Fig. 1.
- 2) Motor section can be disassembled as illustrated in Figs. 2, 3..

Fig. 2

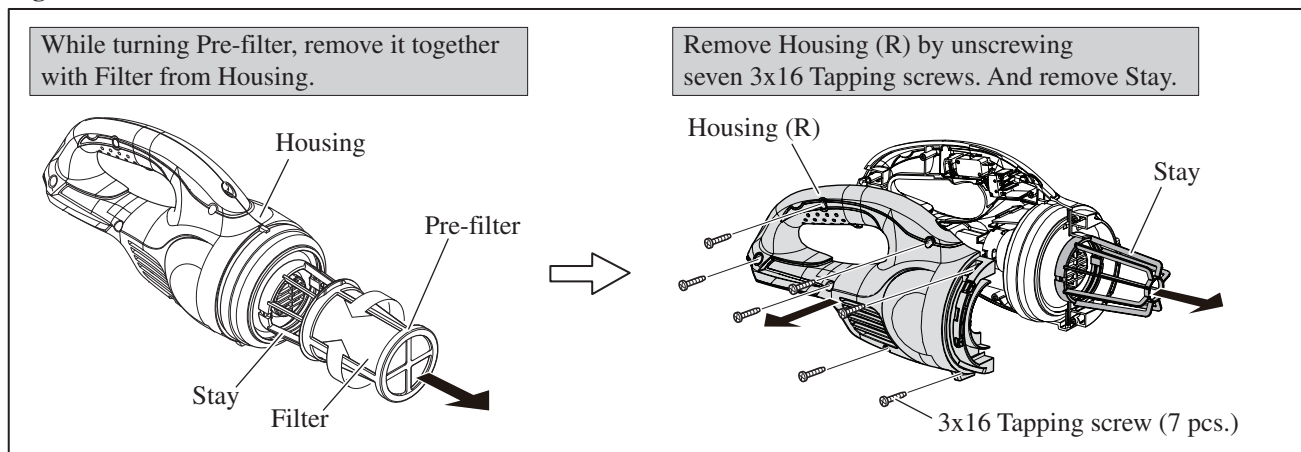
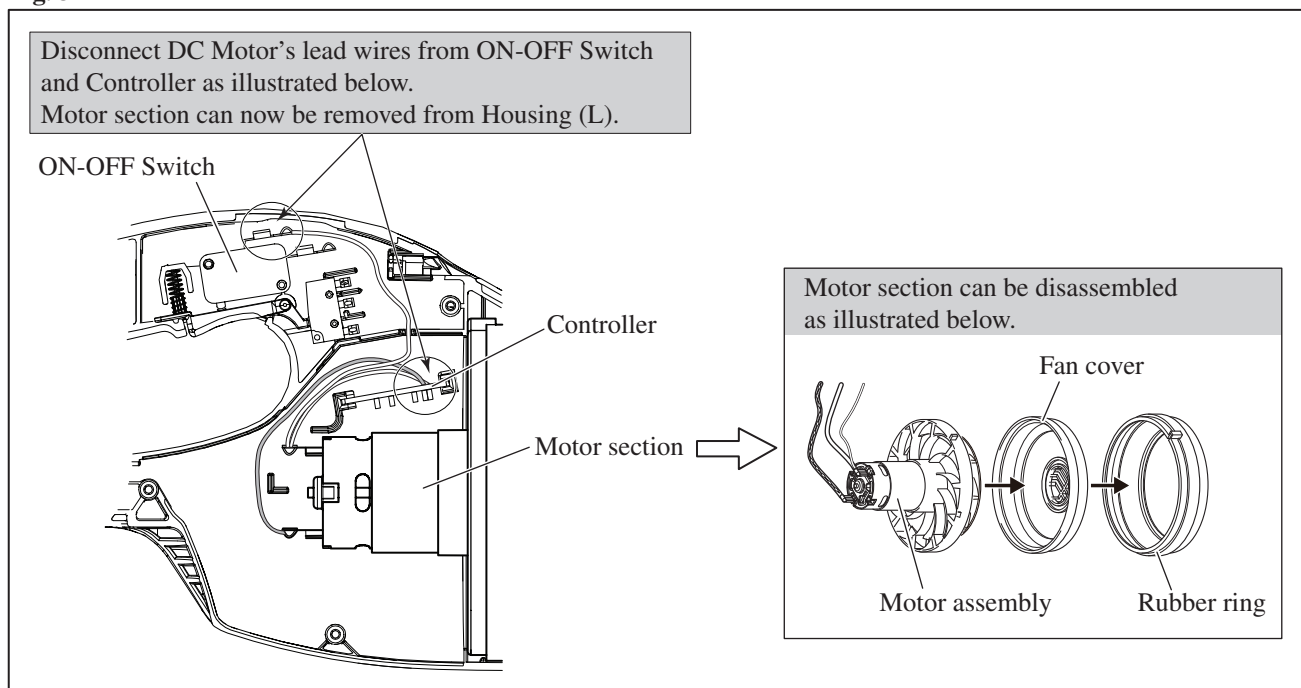

Fig. 3



ASSEMBLING

- 1) Assemble Fan cover to Motor assembly. (Fig. 4)

Fig. 4

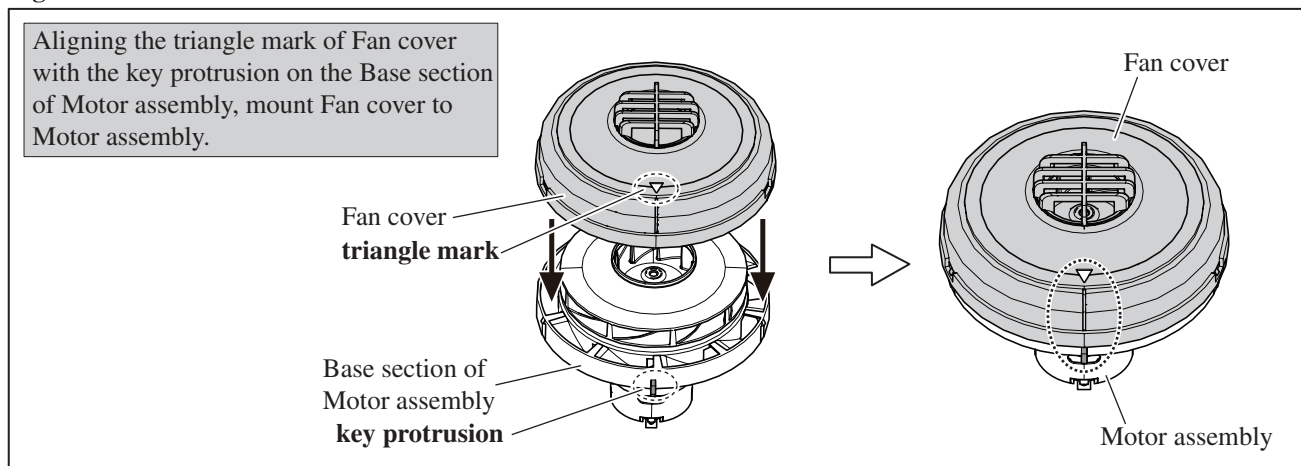

► **Repair**

[3] DISASSEMBLY/ASSEMBLY

[3] -2. Motor Section

ASSEMBLING

2) Assemble Rubber ring to Motor assembly. (Fig. 5)

3) Assemble Switch lever to Housing (L). (Fig. 6)

4) Mount Motor section to Housing set (L). (Fig. 7)

Fig. 5

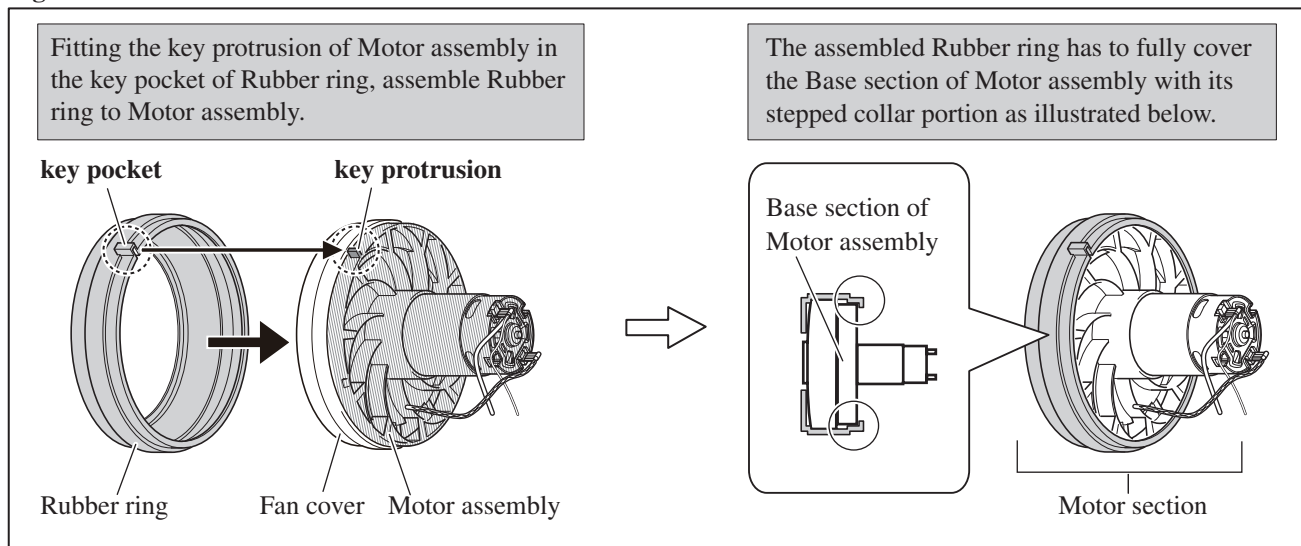

Fig. 6

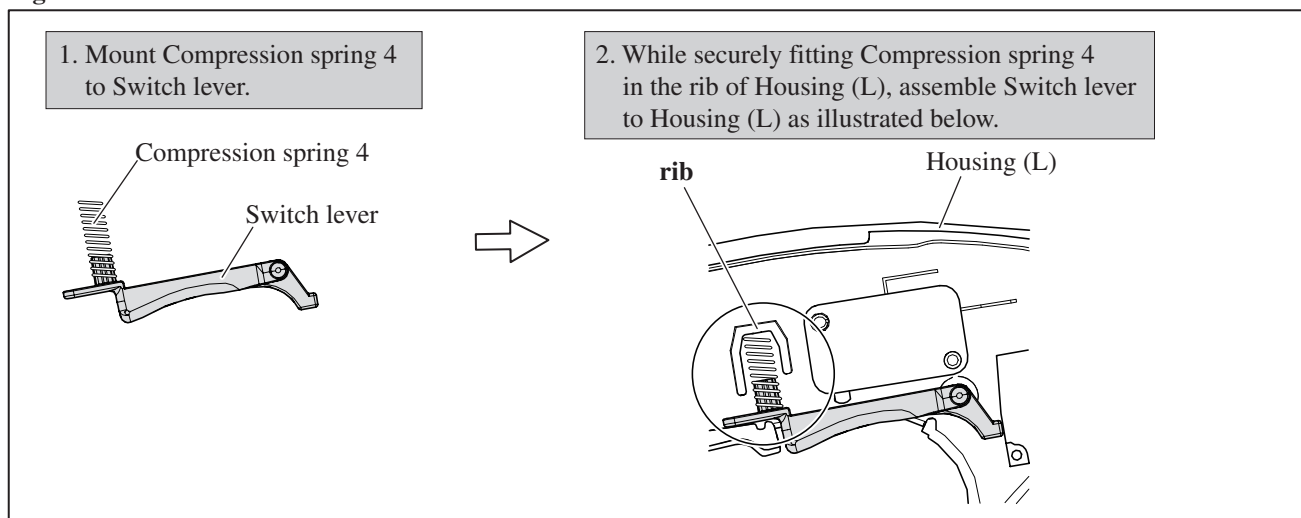
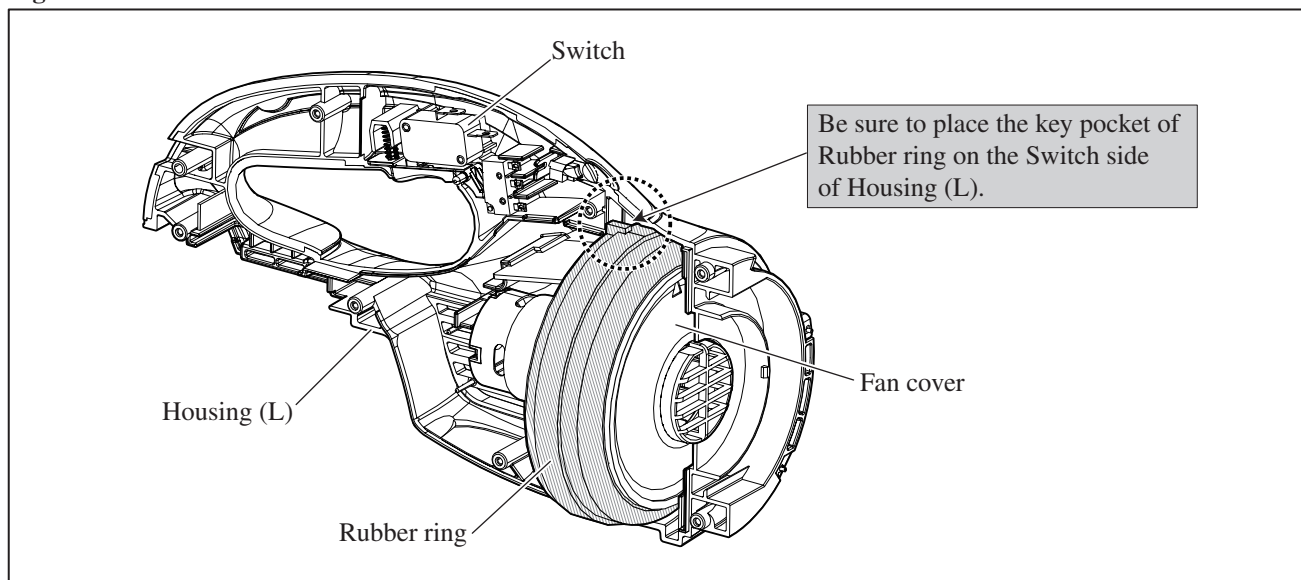

Fig. 7



► Repair

[3] DISASSEMBLY/ASSEMBLY

[3] -2. Motor Section

ASSEMBLING

- 5) Fix Lead wires with Lead wire holder of Housing (L) after connecting them as illustrated in **Fig. 8**.
- 6) Adhere Sponge sheet 15-25 to Lead wire holder in order to prevent Lead wires from coming loose. (**Fig. 9**)

Fig. 8

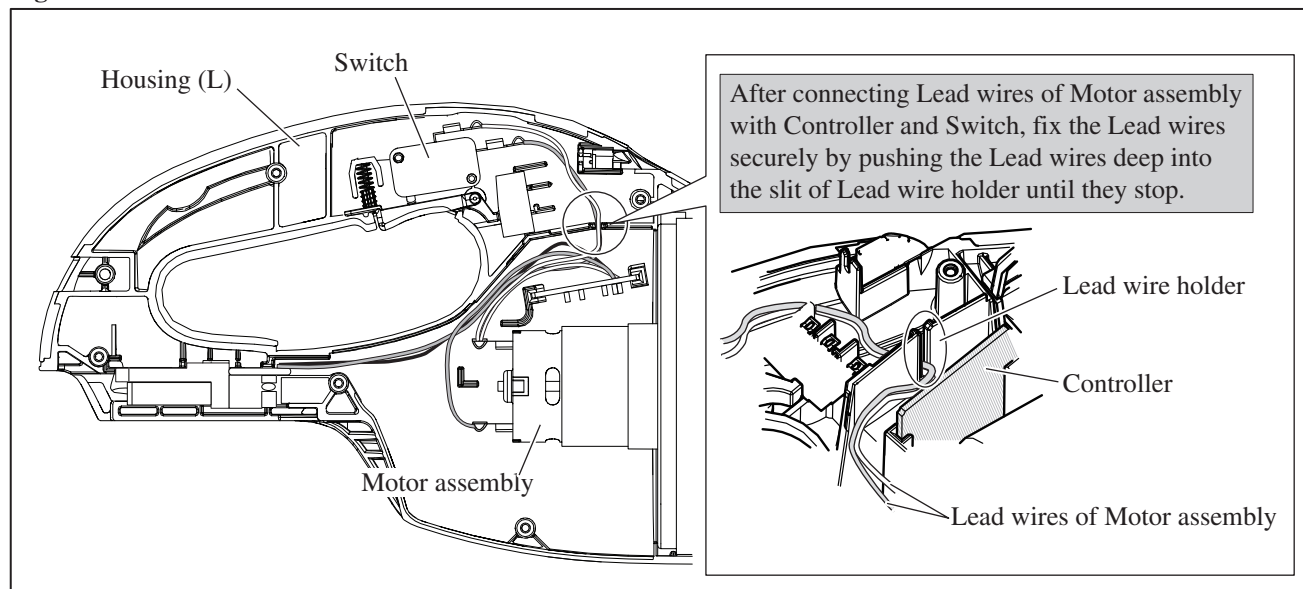
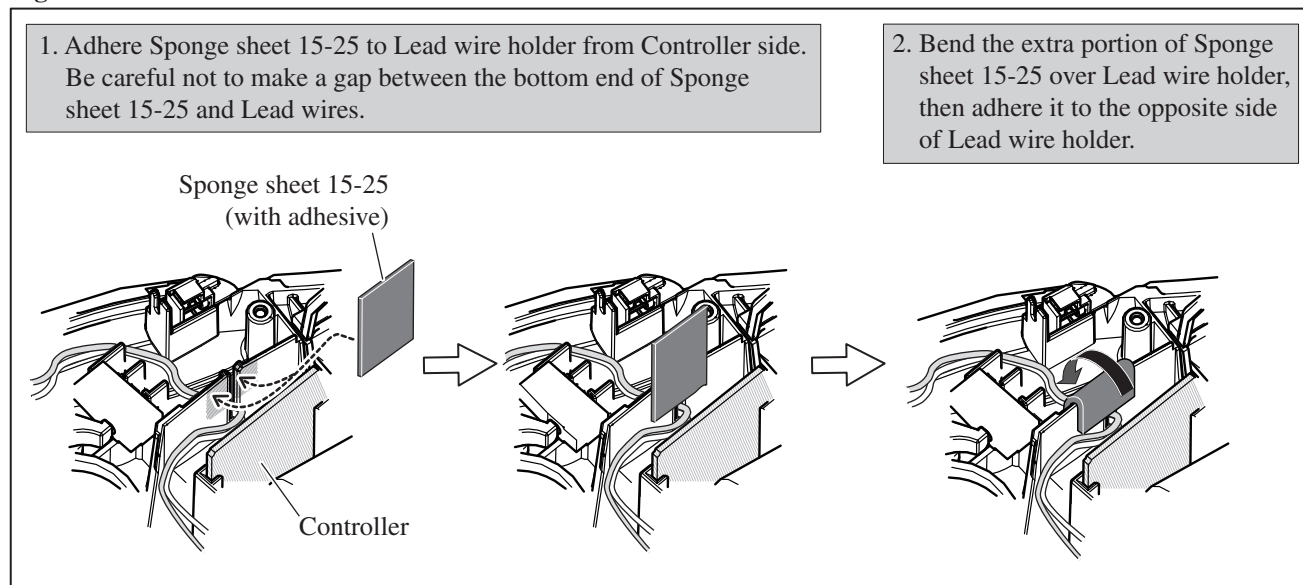

Fig. 9



► Repair

[3] DISASSEMBLY/ASSEMBLY

[3] -2. Motor Section

ASSEMBLING

7) Assemble Housing (R) to Housing (L) and mount Stay as illustrated in Fig. 10.

Fig. 10

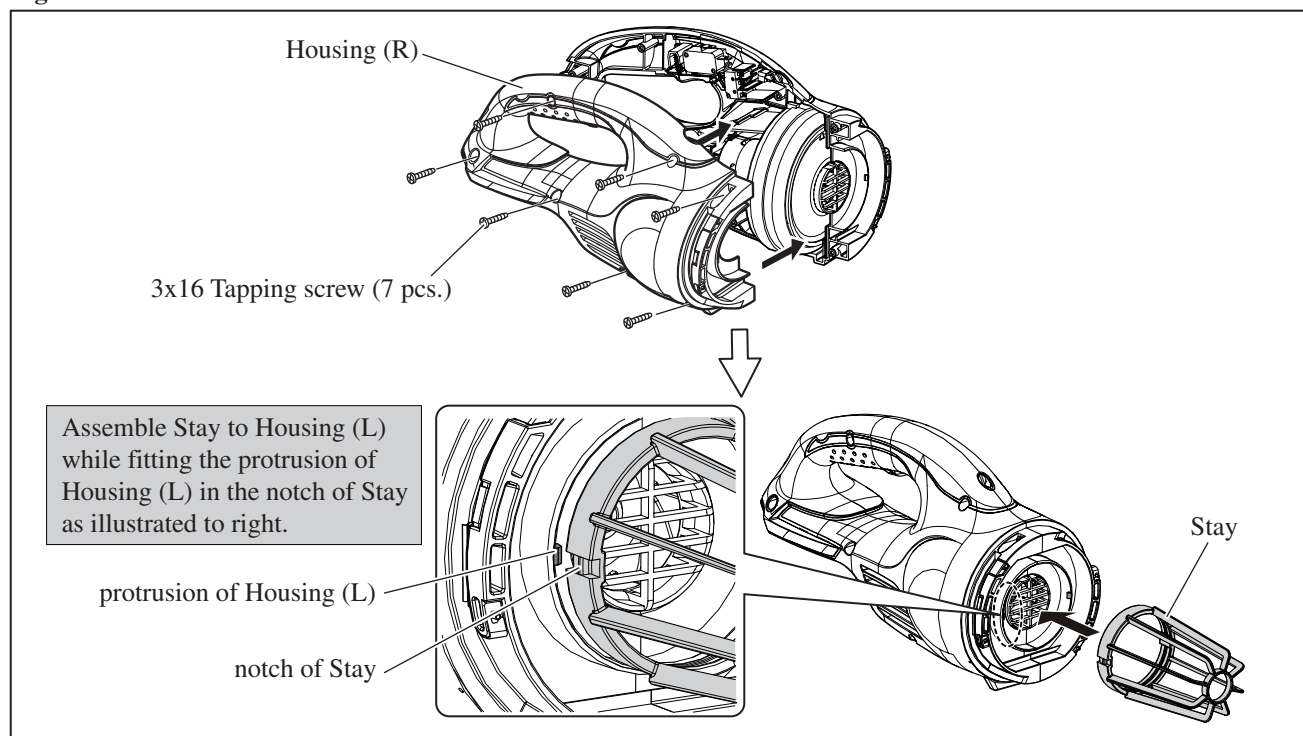

[3] -3. Sponge Sheet 50-50

DISASSEMBLING

Fig. 11

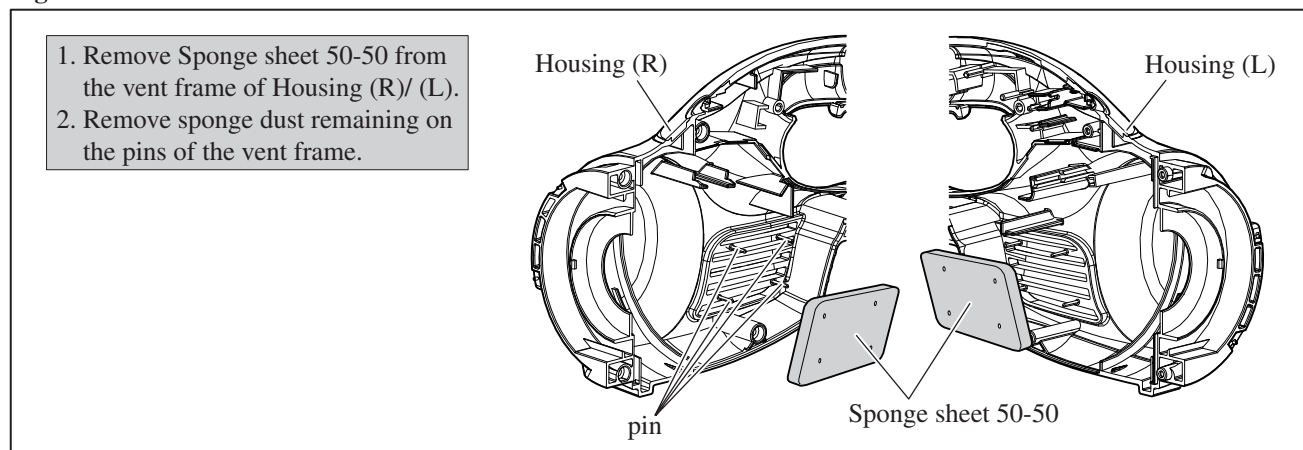

ASSEMBLING

Fig. 12

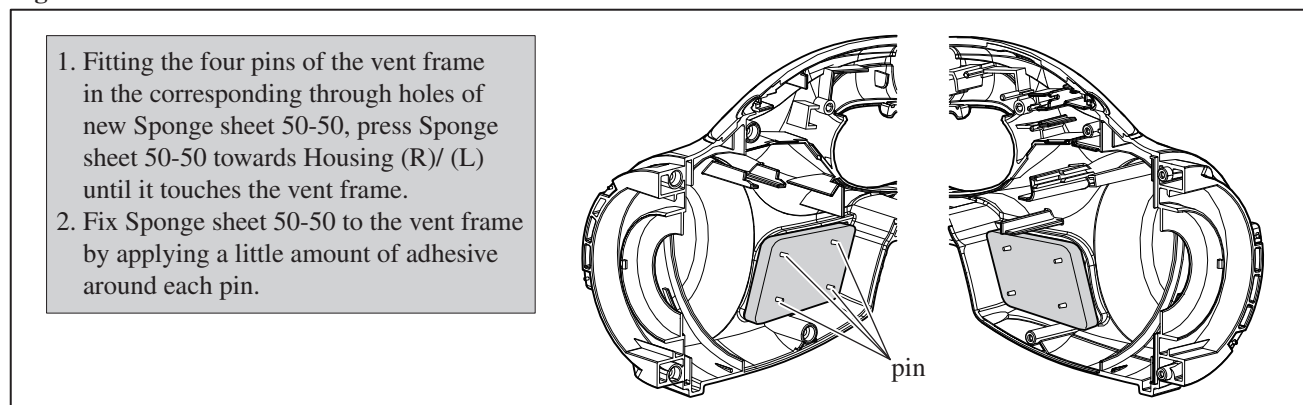

▶ Repair

[4] MAINTENANCE

When Housing is disassembled, clean up the inside of the machine by blowing off the dust that settles on DC Motor, Fan, Housing, etc. with air duster for longer tool life. **(Fig. 13)**

Fig. 13

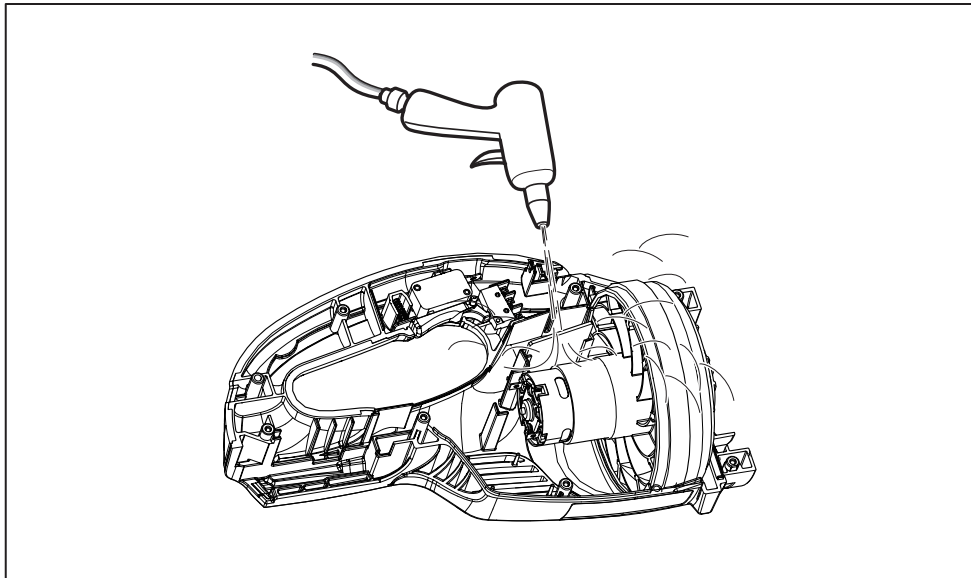

► **Circuit diagram**

Fig. D-1

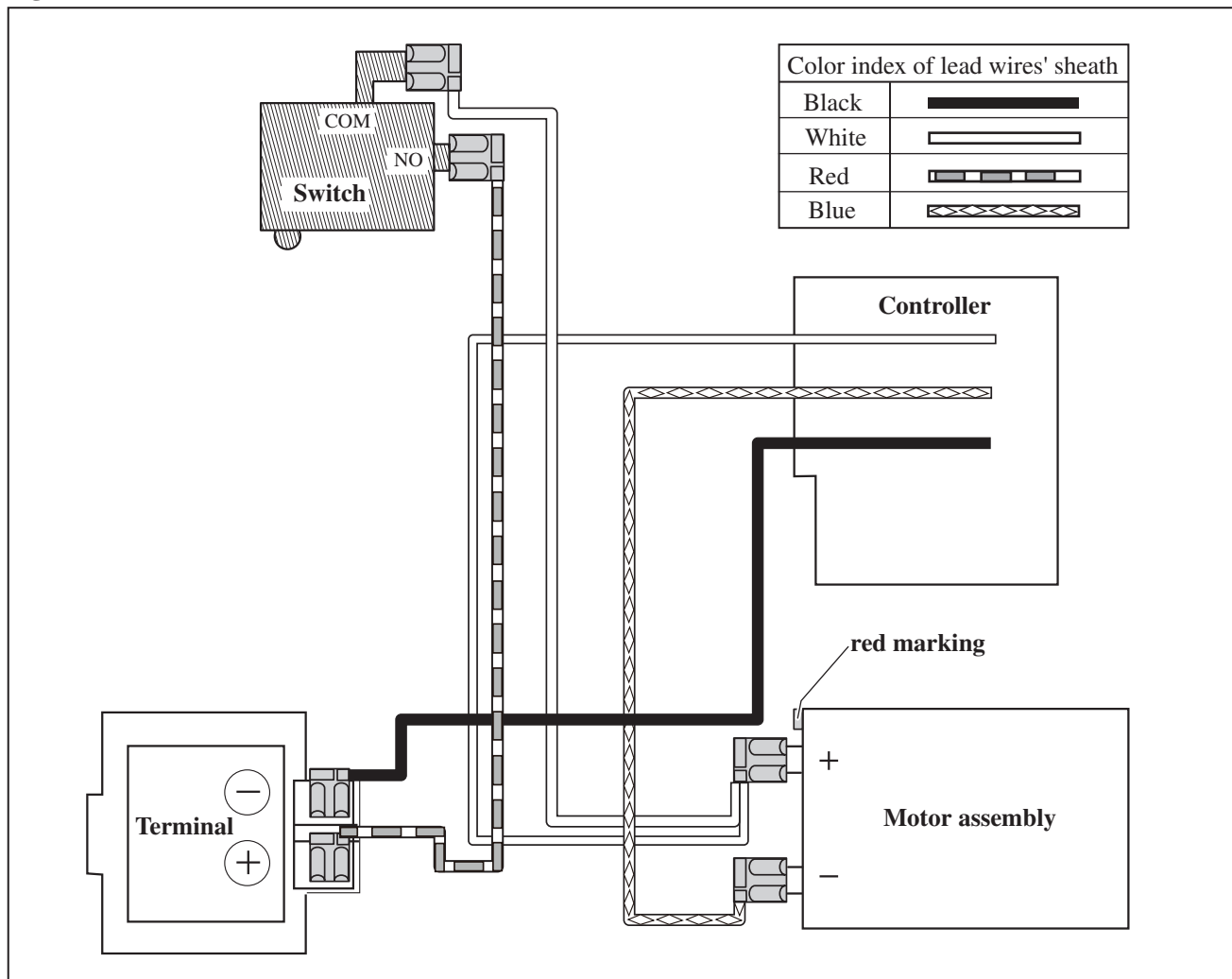

► **Wiring diagram**

[1] **Wiring of Motor Assembly**

Fig. D-2

Connect white Lead wires to the plus terminal of Motor assembly (the terminal indicated by a red marking).
 Connect blue Lead wires to the other terminal (the minus terminal) of Motor assembly.
 Then assemble Motor section to Housing (L) with the plus terminal of Motor assembly on Switch side (top side).
Note: Make sure that the wire connecting portion of each receptacle is positioned on Housing (L) side.

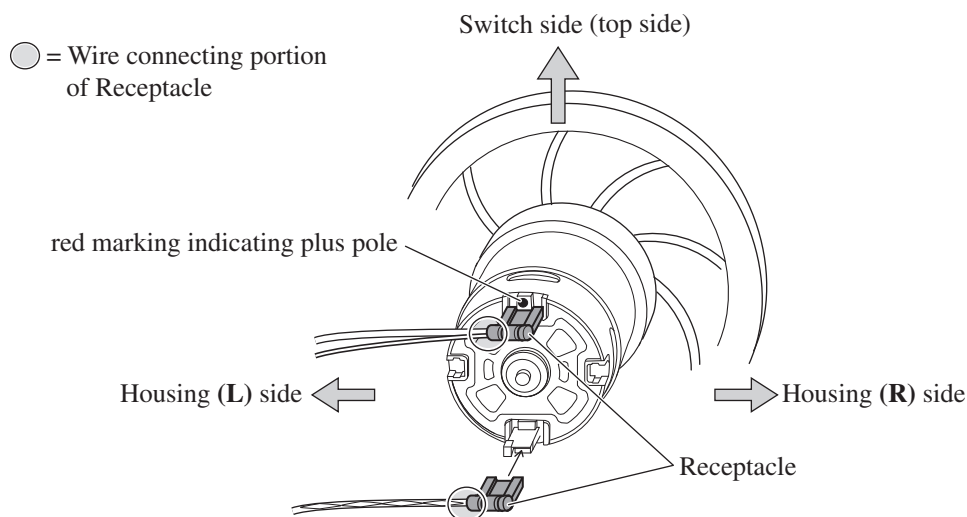

► **Wiring diagram**

[2] **Wiring in Housing (L)**

Fig. D-3

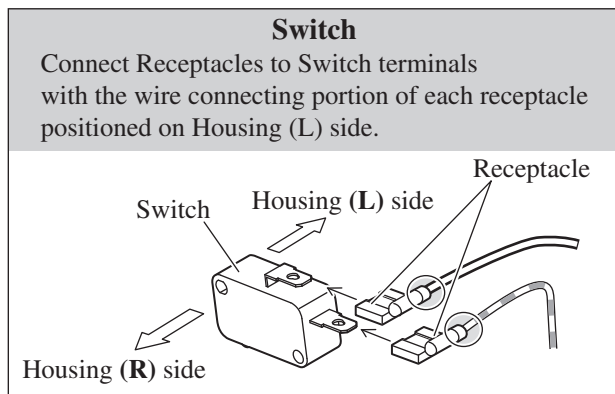

Fix Lead wires to Switch with this Lead wire holder. See page 7 for details.

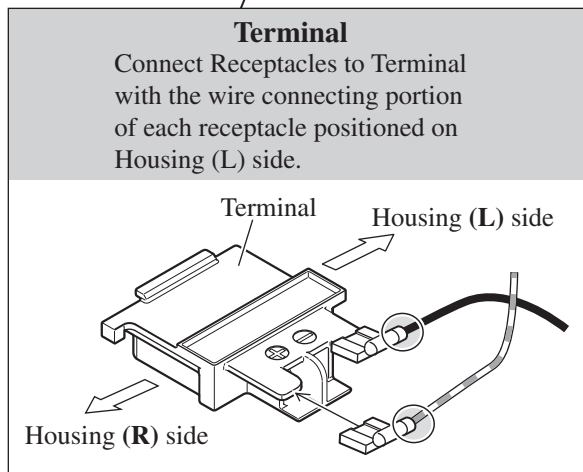
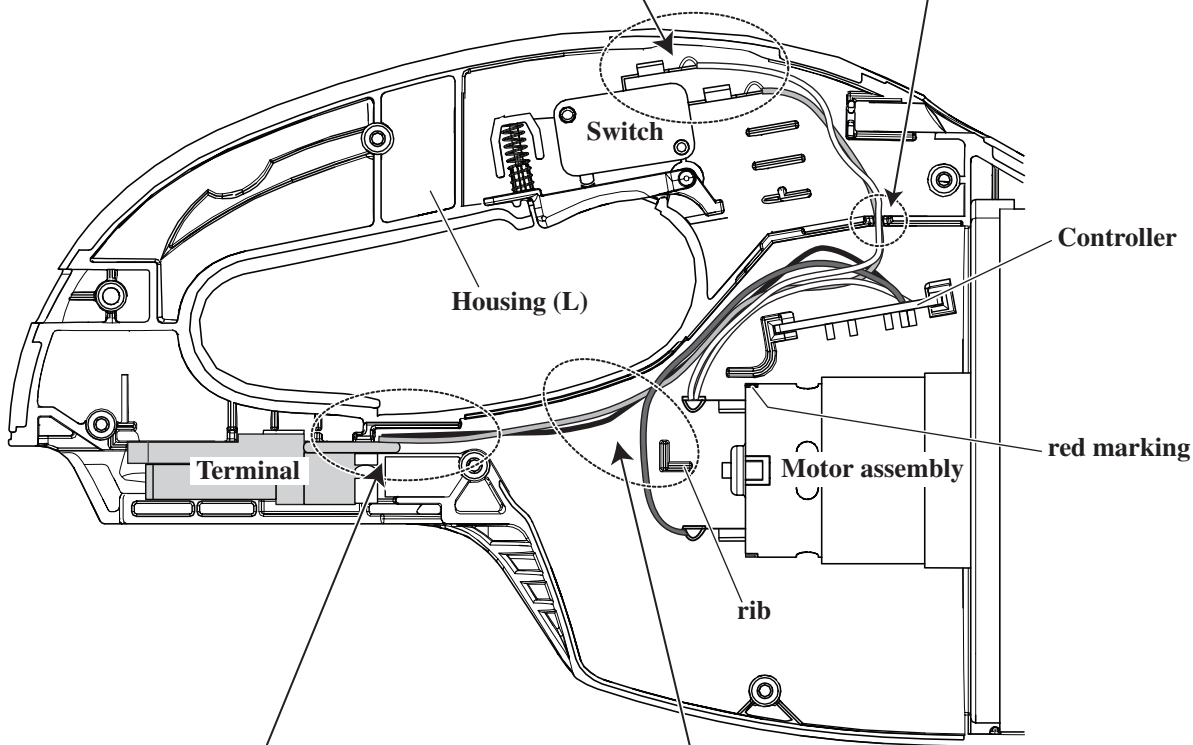

Two Lead wires (red, black) to Terminal
One Lead wire (blue) to Motor assembly

Pass these Lead wires between this rib and the inside wall of Housing (L) in order not to allow them to contact the Motor shaft.