

T ECHNICAL INFORMATION

Models No. ▶ 4103DW

Description ▶ MAKITA 80 mm Cordless cutter

CONCEPTION AND MAIN APPLICATIONS

This model comprising the body(#4103D) and the fast charger(#DC9000) is developed mainly for use in cutting the glass and tile etc., wherein the #5080D is partly reformed and the water supply unit is additionally installed. Developed to further expand the sales volume of the battery tool.

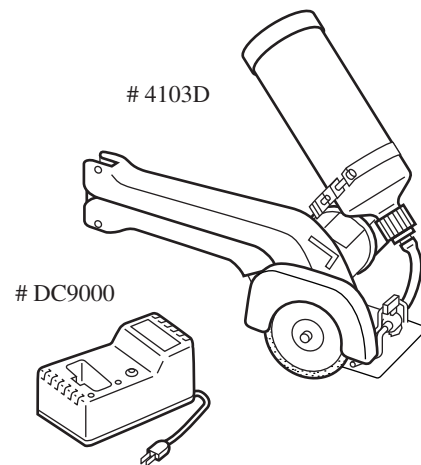

▶ Specifications

#4103D[Battery cutter body]

| Voltage(V) | Current(A)t |
|------------|-------------|
| DC 9.6 V | DC 10 A |

| | |
|-------------------------------|---|
| Motor | DC magnet motor |
| Battery | Battery 9000 |
| No load speed(/min.) | 1000/min. |
| Diamond wheel | 80 in outer dia.x 0.8 in thickness x 15 in inner dia. |
| Max. cutting depth(mm) | 17 mm |
| Machine size | 304 in length x 155 in width x 270 in height |
| Net Weight(kg) | 1.8 kg (Battery included) |

#DC 9000[Fast charger]

| Input voltage | Input frequency (Hz) | Input capacity | Output voltage | Output current |
|----------------------|----------------------|----------------|----------------|----------------|
| Single-phase AC 100V | 50-60 | 35 Volt/Ampere | DC 9.6 V | DC 1.5 A |

| | |
|----------------------------|--|
| Charging time(hour) | 1 hour |
| Machine size | 145 in length x 80 in width x 68 in height |
| Net Weight(kg) | 1.0 kg |
| Cord length(m) | 2 m |

▶ Standard equipment

Diamond wheel 80
Hex. Wrench
MAKITA Battery 9000

▶ Optional accessories

MAKITA Battery 9000
Diamond wheel 80

▶ Repair

Handling(Disassembling/assembling included)

Although the operation methods and the handling ways are almost same as for the #5080D, use special cares for the following points.

- 1) To connect the cap mounted on the edge of the vinyl tube to the port edge of the water supply tank, loosen the screw holding the water supply tank, connect them while turning right the water supply tank.(see the right figure)

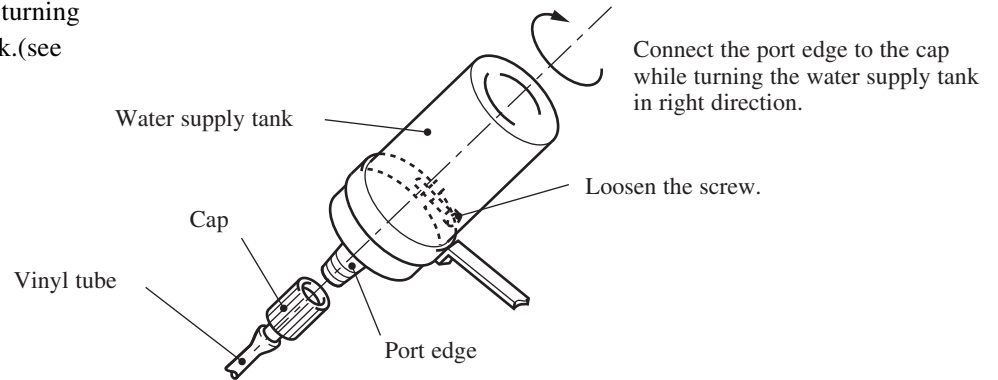

- 2) If the vinyl tube has been bent in dogleg-shape or over tightened after assembling, loosen the screw holding the tank holder, slide the tank position in left/right or change the angle slightly to modify it.
- 3) Although the handling methods for the DC 9000 is same as the DC 7000, use the charger for exclusive use in DC9000 instead of charger for the DC7000(cannot be used) when charging.