

TECHNICAL INFORMATION

Models No. ▶ #3600B

Description ▶ Router

CONCEPTION AND MAIN APPLICATIONS

1. Compared with the conventional model #3600, the more powerful and double insulation structure has been developed.
2. The built-in two-pole plunge-system for up/down motion offers well workability.
3. Improved safety
4. The application is the same as the one for the conventional #3600. (Bit is commonly used.)

▶ Specifications

1. Main functions of electrical motor

Voltage	Single-phase 100V
Current	12A
Frequency	50~60Hz
Continuous rating input	1150W
Power supply cord	2.7 m

2. Main functions of equipment

Rotation	22,000 rpm.
Chuck port diameter	12 mm
Plunge stroke	0~60 mm
Net weight	About 5 kg
Demension	See as follows.

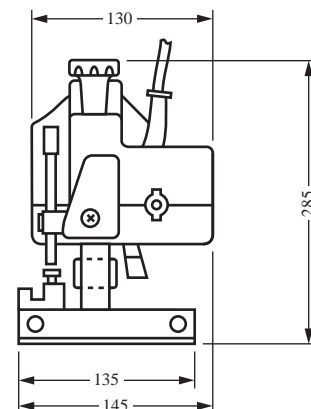
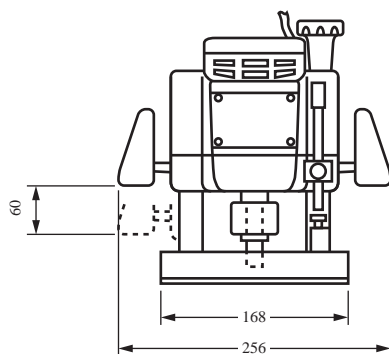

► Repair

1. Disassembling of the equipment (Removing of the armature)
 - a) Remove the up/down handle and disconnect the motor from the base.
 - b) Remove the carbon brush.
 - c) Remove the pan head screw connecting the under case and motor housing, loosen the hexagon nut connecting the switch to disassemble the motor housing and the under case.
 - d) Remove the Colette chuck from the armature shaft. (right hand screw)
 - e) Take away the armature from the under case.
2. For assembling, proceed in the reverse order as the above.
 Note that in assembling the up/down handle set the cracked points of nut and handle, and screw the handle into the handle shaft while the spring is compressed. (See the figure 5.)
3. Other cautions in assembling/disassembling are :
 - a) Use care not to damage the slide pole in assembling and disassembling.
 - b) Be sure to lubricate the moving point and screw in assembling.
 - c) If the stopper block of the base is disassembled, apply the screw lock super 20Q into the screw for mounting the block to prevent loosening. Use care that the adhesive may not be overflowed onto the moving point of the stopper block. (See the figure 6.)
 - d) To reposition the lock lever when the lock point at edge of the lock bolt has been worn out or disassembled, set the lever at a certain position where the lock can be released just before the lever has touched the switch box of the under case. (See the figure 7.)

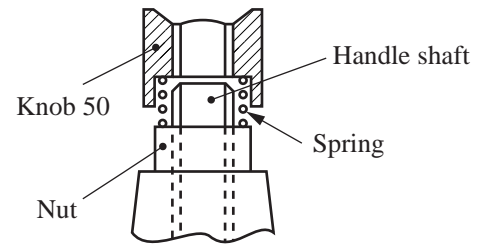

Figure 5

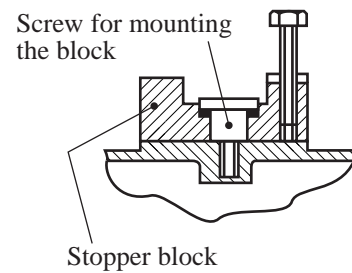

Figure 6

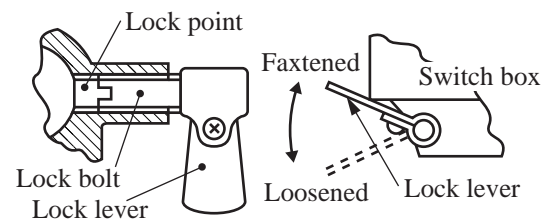

Figure 7

► Cautions in handling and operation

1. If the body is raised up to the position (the space between base and motor: about more than 70 mm) shown on the right figure using the up/down handle, the up/down handle can be disconnected. Accordingly do not raise the motor than necessity. (The red groove mark shows the 70 mm around.)
2. Lubricate the slide pole and the up/down screw sometime. Be sure to lubricate in assembling/disassembling.
3. How to use the attachments
 - a) Straight guide

The sensitive adjust screw can be adjusted in range of 30 mm. If it is roughly shifted, slide the guide holder. If you feel unstable due to the short length of ruler face and it interferes with the straight guide due to the large bit diameter, mount the precisely processed wood on the guide as shown on the figure 9 to repair/modify the guide face.
 - b) Trimmer guide

To assemble it, proceed in the same manner as for the straight guide, or adjust the cutting depth and decide the bit position before loosening the butterfly screw B and adjusting the clearance between bit and roller.
 - c) Template guide

To assemble the template guide, fasten the washer of pan head screw. Note that the guide has 14 mm in inner diameter and 18 mm in outer diameter.
4. Since the slight vibration is caused by high rotation in cutting, always use care that each screw has been completely fastened. Especially use care of the butterfly bolt etc. related to ruler.
5. Be sure to arrange no load condition when switching on. Do not switch while the bit is touching the processed wood in cutting start to avoid accident.
6. Since the cutter is common for #3600, each bit as special attachments can be chucked on both #3600 and #3600B. Note that the Colette chuck diameter is 12 mm, but if the Colette chuck sleeve is used, also 10 and 8 mm bits can be chucked in the same way as for #3600.
7. Application examples of each bit

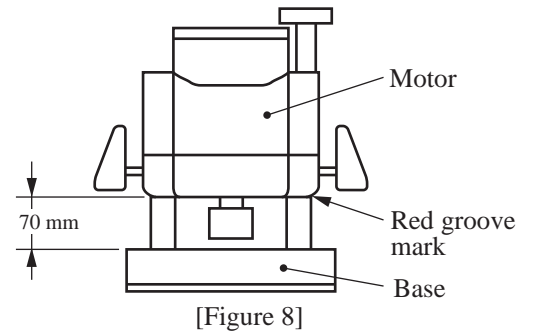

[Figure 8]

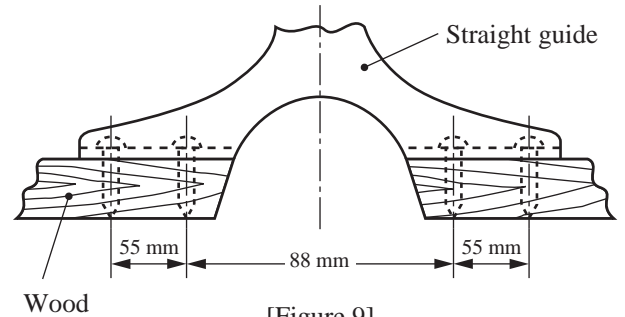

[Figure 9]

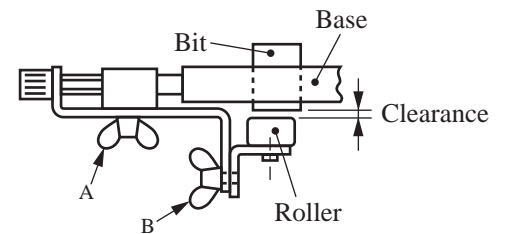

[Figure 10]

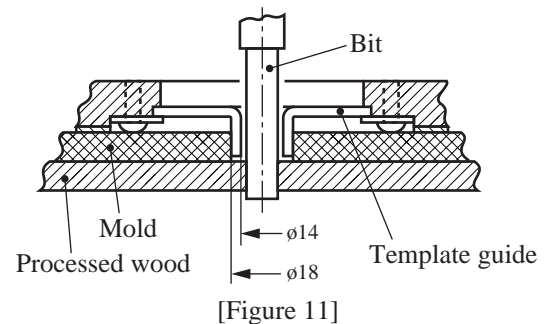

[Figure 11]

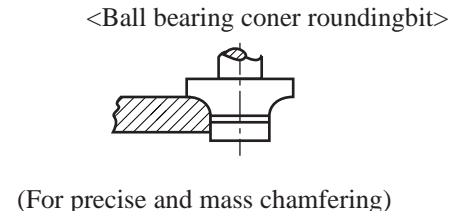
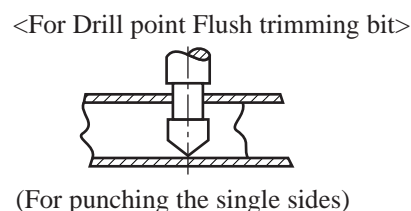
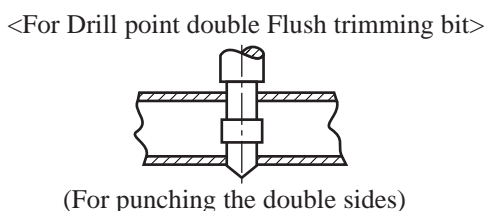
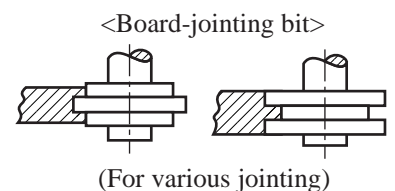
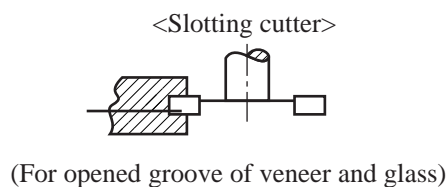
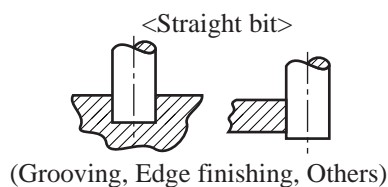

<Cove beading bit>

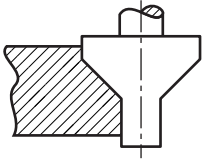

(Bit for chamfering cove)

<Beading bit>

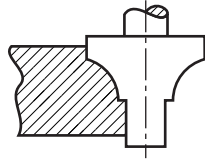

(Bit for chamfering bead)

<Corner rounding bit>

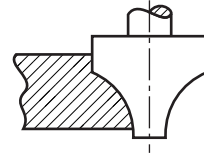

(For chamfering corner)

<Dovetail bit>

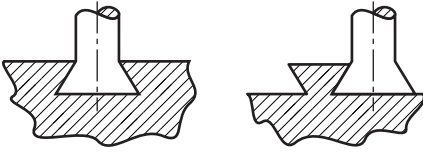

(For various V-groove processes)

▶ **Standard equipment**

See the instruction manual.

▶ **Optional accessories**

See the General Catalogue.