

TECHNICAL INFORMATION



PRODUCT

P 1/7

Model No. ▶ UH7580/ UH6580/ UH5580

Description ▶ Hedge Trimmers 750mm/ 650mm/ 550mm

CONCEPT AND MAIN APPLICATIONS

Models UH7580/ UH6580/ UH5580 for professional applications have been developed as the successors to the current UH6540/ UH5540/ UH4540, featuring renewed external appearance and more improved handling.

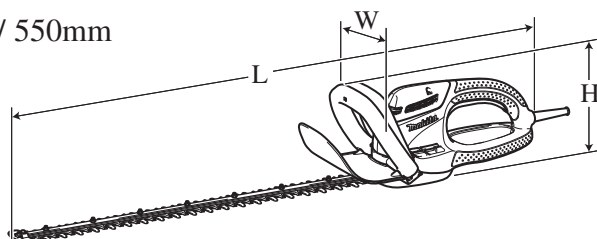

Dimensions: mm (")			
Model No.	UH7580	UH6580	UH5580
Length (L)	1,157 (45-1/2)	1,049 (41-1/4)	970 (38-1/4)
Width (W)	223 (8-3/4)		
Height (H)	206 (8-1/8)		

► Specification

Voltage (V)	Current (A)	Cycle (Hz)	Continuous Rating (W)		Max. Output (W)
			Input	Output	
120	5.9	50/60	---	330	500
220	3.2	50/60	670	380	500
230	3.1	50/60	670	380	500
240	3.0	50/60	670	380	500

Specifications	Model No.	UH7580	UH6580	UH5580
Blade length: mm (")		750 (29-1/2)	650 (25-1/2)	550 (21-5/8)
No load speed: min-1=spm*1		1,500		
Tooth pitch: mm (")		28 (1-1/8)		
Protection from electric shock		Double insulation		
Power supply cord: m (ft)		0.3 (0.98)*2		
Net weight: kg (lbs)		4.4 (9.7)	4.3 (9.4)	4.2 (9.2)

*1: spm= strokes per minute

*2: Kuwait: 2.5m (8.2ft)

► Standard equipment

- Blade cover 1
- Hook complete 1
- Cord holder complete set 1
- Extension cord (10m) 1 (for UK [240V] only)

Note: The standard equipment for the tool shown above may differ by country.

► Optional accessories

- Shear blade assembly set
- Blade cover
- Hook complete
- Cord holder complete set
- Arm band complete set
- Chip receiver assembly set

► Repair

CAUTION: Unplug the machine for safety before repair/ maintenance !

[1] NECESSARY REPAIRING TOOLS

Code No.	Description	Use for
1R003	Retaining ring pliers ST-2N	Removing Lifter section
1R212	Tip for Retaining ring pliers	Modular use with 1R003
1R263	Bearing extractor	Removing Gear housing cover

[2] LUBRICATION

Apply Makita grease N. No.2 to the following portion to protect parts and product from unusual abrasion. Refer to **Fig. 5**.

- 1) Gear room (6g: Refer to **Fig. 5**.)
- 2) Contact portion of Shear blade ass'y and Crank (3g: Refer to **Fig. 7**)

[3] DISASSEMBLY/ASSEMBLY

[3] -1. Carbon brush

REPLACING

Remove two 4x18 Tapping screws and Top cover from Housing set. (**Fig. 1**)

Pick out two Carbon brushes using thin slotted screwdriver. (**Fig. 2**)

Fig. 1

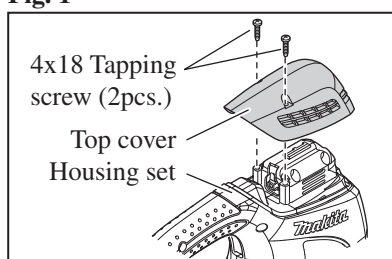
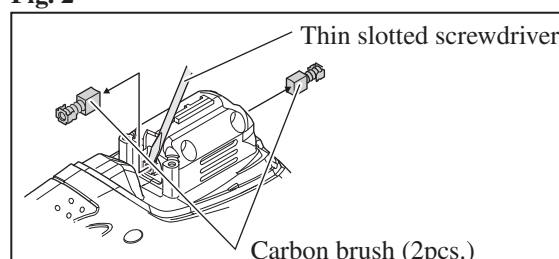

Fig. 2



[3] DISASSEMBLY/ASSEMBLY

[3] -2. Shear blade ass'y and Gear ass'y

DISASSEMBLING

- 1) Turn the machine upside down and keep it in a horizontal position by the use of a horizontal portion of Front grip.
 - 2) Remove four M4x25 Pan head screws and Under cover. (**Fig. 3**)
Note: Set Blade cover in place to prevent being injured as illustrated in **Fig. 3**.
 - 3) Remove Gear housing cover by levering with two 1R263 or slotted screwdrivers. (**Fig. 4**)
 - 4) Turn crank portion with slotted screwdriver inserted to the groove on Spindle. (**Fig.5**) Two oval holes of Shear blades and the crank portion of Gear ass'y have to be aligned as illustrated in **Fig. 5**.
- Note:** It is possible that Two oval holes of Shear blades and the crank portion of Gear ass'y do not be aligned because Gear ass'y is in locked position by Pin 5. Turn Spindle counterclockwise with strong force to release the locked condition. (The spring and the lock washer in Gear ass'y will be slid, and Pin 5 will be out of the locked position.)

Fig. 3

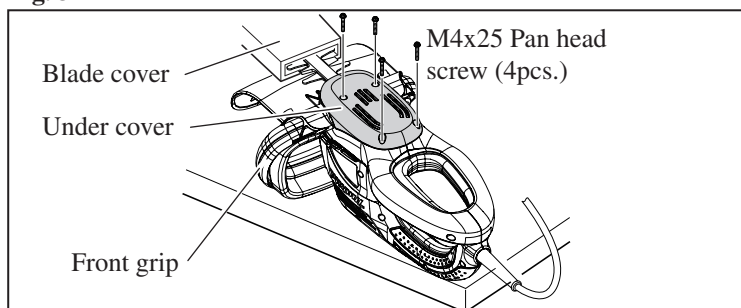

Fig. 4

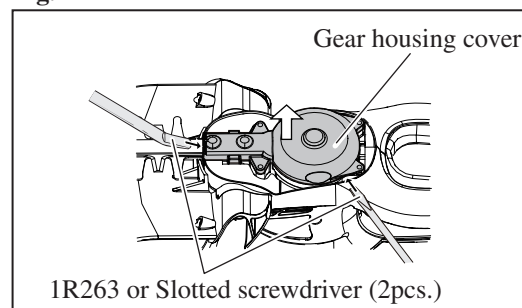
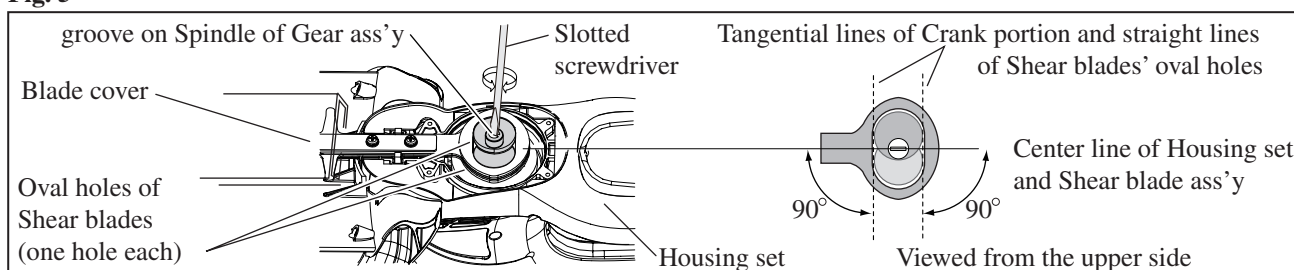

Fig. 5



► Repair

[3] DISASSEMBLY/ASSEMBLY

[3] -2. Shear blade ass'y and Gear ass'y (cont.)

DISASSEMBLING

5) Loosen two M5x25 Pan head screws (threadlocker type) and separate Shear blade ass'y from the machine. (**Fig. 6**)

Note: 1. Leave the two M5x25 Pan head screws in their holes of Shear blade ass'y when setting Shear blade ass'y in place without disassembly.

Removing two M5x25 Pan head screws may cause misalignment between two sleeves and holes of Shear blade ass'y.

2. Leave Dust guard in the groove of Gear housing.

6) Pull out Gear ass'y from Gear housing using two 1R263 or slotted screwdrivers. (**Fig. 7**)

Fig. 6

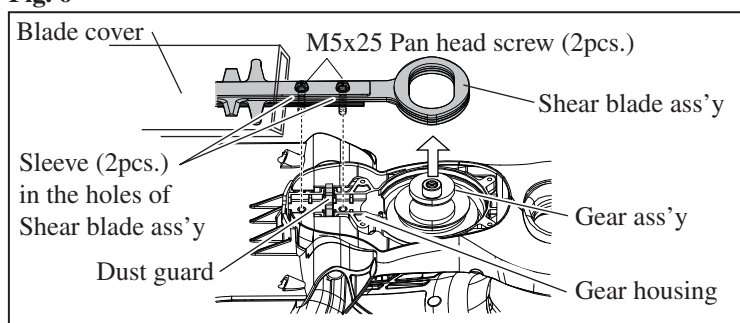
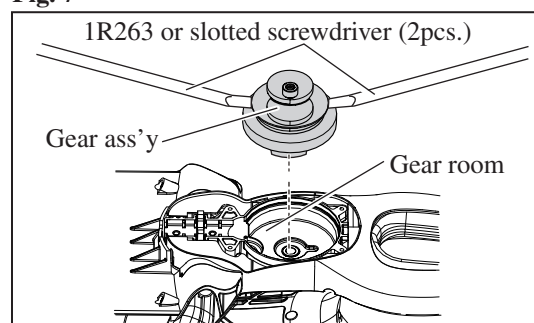

Fig. 7



ASSEMBLING

Take the disassembling step in reverse.

Note: • Regarding the new Shear blade ass'y;

- make sure that the routes for the two M5x25 Pan head screws are secured.

- pass two M5x25 Pan head screws through the holes for Shear blade ass'y in advance.

• The flat shape of Dust guard has to be inserted into the groove of Gear housing before putting Shear blade ass'y on Gear housing. (**Fig. 8**)

• Pass the two M5x25 Pan head screws through Shear blade ass'y to align the holes of Shear blade ass'y with Sleeves, and tighten the two M5x25 Pan head screws. (Refer to **Fig. 6**)

• When reusing two M5x25 Pan head screws, apply adhesive to the threads.

• When the holes and Sleeves for two M5x25 Pan head screws are not aligned, slide only Guide plate back and forth. (**Fig. 9**)

• After tightening M5x25 Pan head screws, make sure that Shear blades reciprocates smoothly with turning Crank with slotted screwdriver. (**Fig. 6**)

Fig. 8

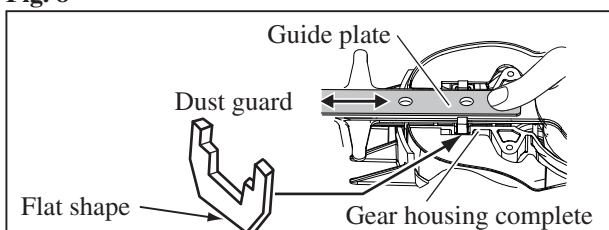
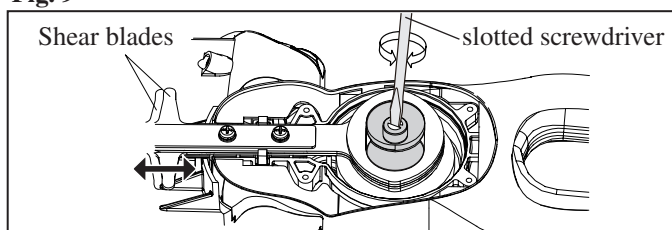

Fig. 9



[3] -3. Motor, Switch and Power supply cord

DISASSEMBLING

1) Remove Shear blade ass'y. (Refer to **Fig. 6**.)

2) Remove Top cover and Carbon brushes. (**Figs. 1 and 2**)

3) Remove two M5x30 Pan head screws, and then slide the following parts together the forward direction. (**Fig. 10**)

*Switch lever B *Front grip *Protector complete

The above parts can be pulled out from Housing set.

4) Remove ten 4x18 Tapping screws and separate Housing R from Housing L. (**Fig. 11**)

Fig. 10

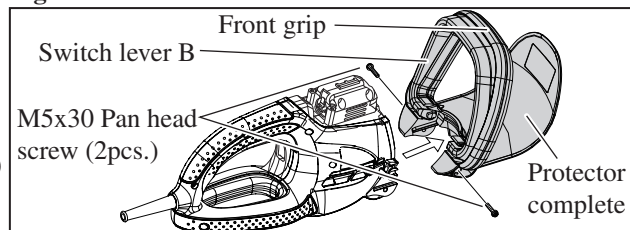
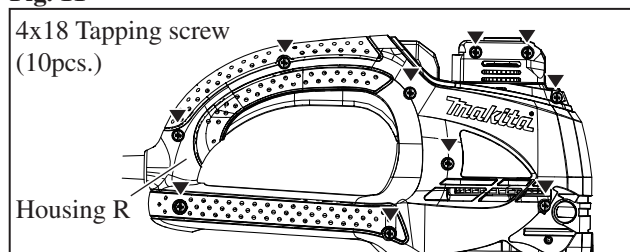

Fig. 11



► **Repair**

[3] DISASSEMBLY/ASSEMBLY

[3] -3. Motor, Switch and Power supply cord (cont.)

DISASSEMBLING

5) Remove Switch lever A with Compression spring 5, Switch lever C with Rod and Link, and Switch from Housing L.

(Fig. 12) (The position of Switch interferes with disassembly of Lifter section.)

6) Remove Lifter section from Housing L. (Fig. 13)

Note: Lifter section of UH5580, UH6580 and UH7580 is different from that of UH4570, UH5570 and UH6570.

Enlarge the distance between Pin holder and Cap holder using 1R003 with 1R212, and keep Compression spring 5 compress to separate the bottom end of Pin 5 from the hole of Gear housing. See Fig. 14 for the detail.

7) After removing Brush holders, separate Armature ass'y, Field ass'y, Lever and Gear housing as a assembled part from Housing L. (Fig. 15)

Fig. 12

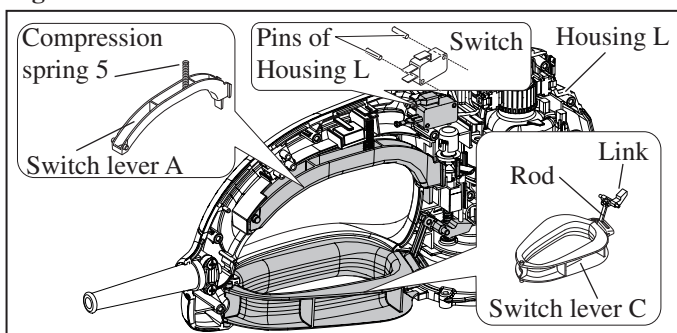

Fig. 13

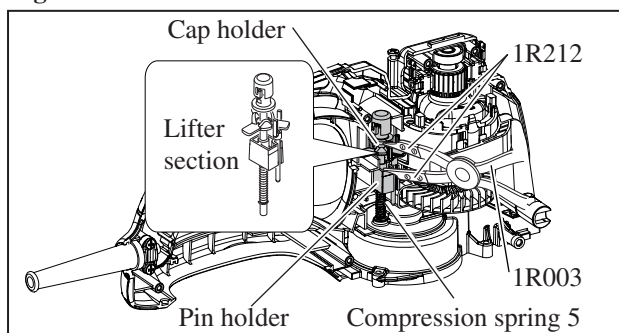
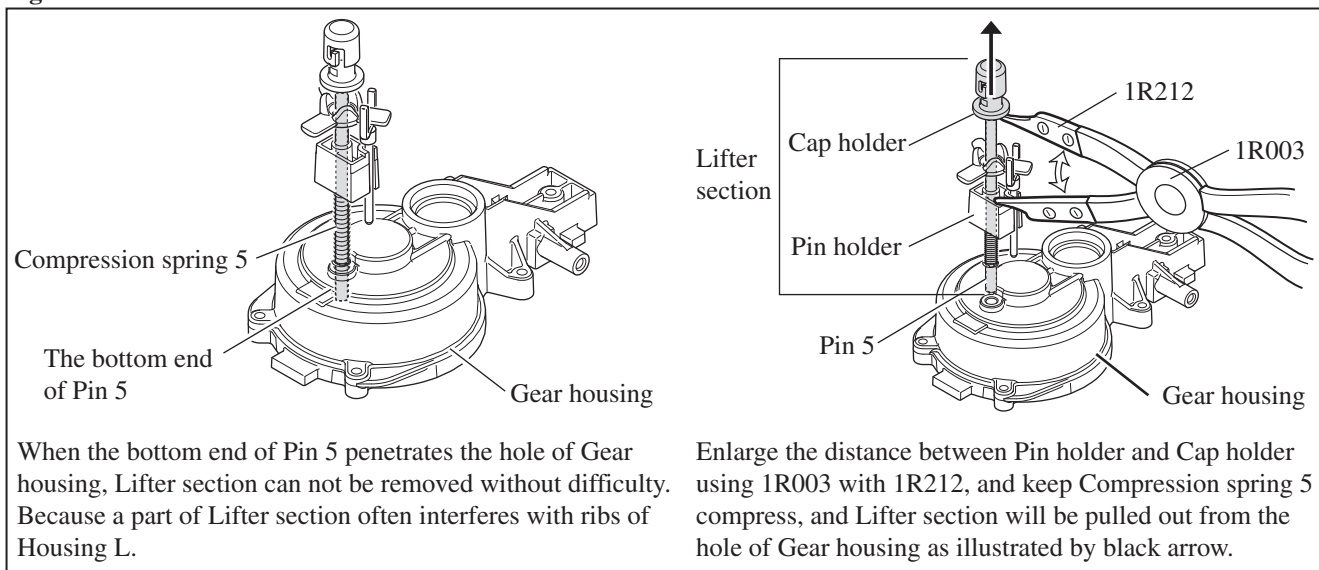

Fig. 14



When the bottom end of Pin 5 penetrates the hole of Gear housing, Lifter section can not be removed without difficulty. Because a part of Lifter section often interferes with ribs of Housing L.

Enlarge the distance between Pin holder and Cap holder using 1R003 with 1R212, and keep Compression spring 5 compress, and Lifter section will be pulled out from the hole of Gear housing as illustrated by black arrow.

Fig. 15

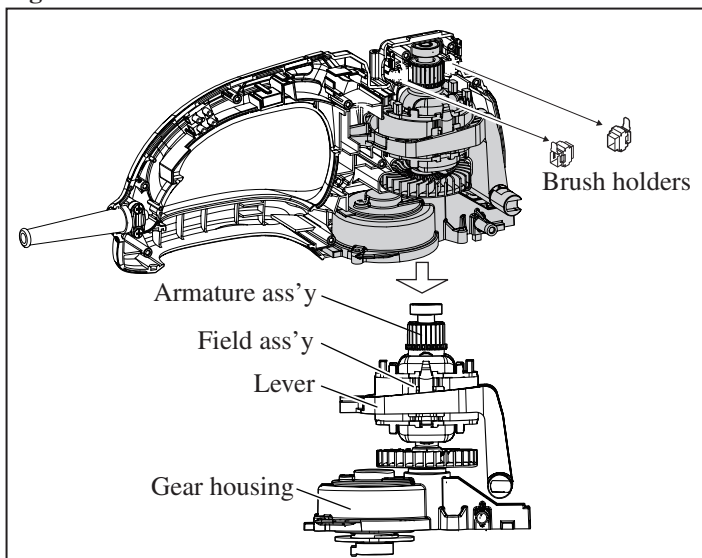

► Repair

[3] DISASSEMBLY/ASSEMBLY

[3] -3. Motor, Switch and Power supply cord (cont.)

ASSEMBLING

Take the disassembling step in reverse.

Note: Refer to **Fig. 16**.

- 1) When setting Armature ass'y and Gear housing complete in place, pass Lever through Field ass'y at the same time while inserting the hinge portion of Lever into Housing L carefully because the hinge tends to remove. Insert the pin portion of Gear housing complete into Housing L as well.
- 2) When Armature ass'y, Field ass'y, Gear housing and Lever are set in place, Ball bearing 6000ZZ on Fan side of Armature has to be partly exposed from Gear housing as illustrated in **Fig. 17**.

Fig. 16

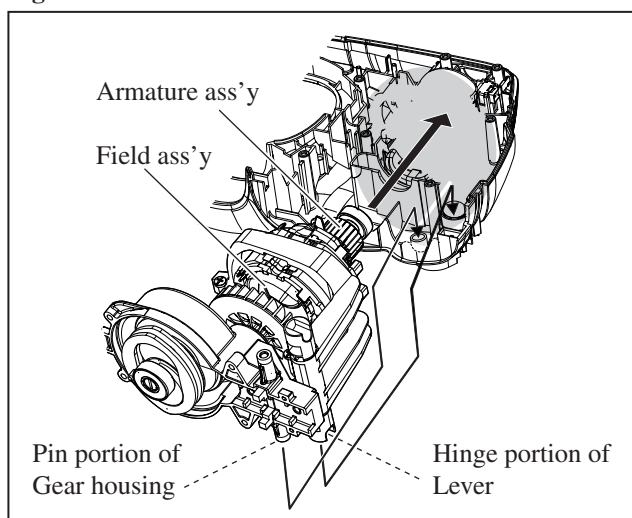
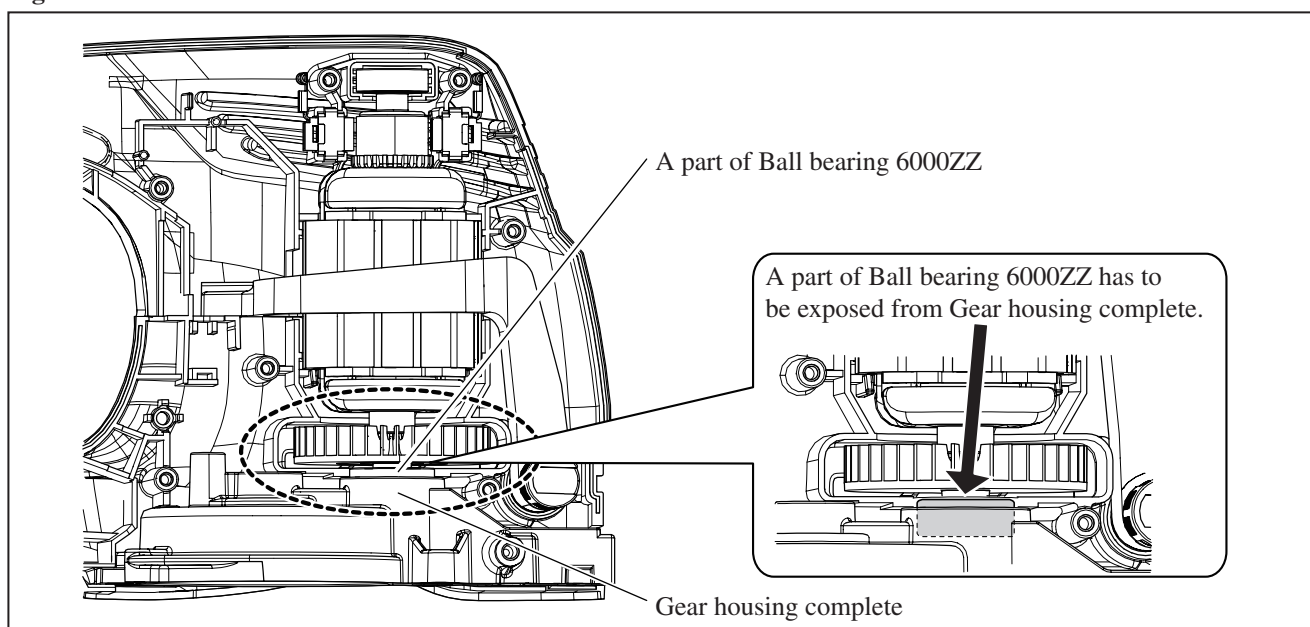

Fig. 17



► Repair

[3] DISASSEMBLY/ASSEMBLY

[3] -4. Lifter section

DISASSEMBLING

Refer to the clause of [3]-3.

ASSEMBLING

Set the components in place while pay attention to the linked portions illustrated in **Fig. 18**.

Three plates X, Y and Z of Lifter have to be linked with each appropriate portion in the following order.

1. Plate X is fit into the U groove of Pusher cap.
2. Plate Y is put on the hook portion of Lever.
3. Plate Z is fit into the groove of Switch lever A.

Fig. 18

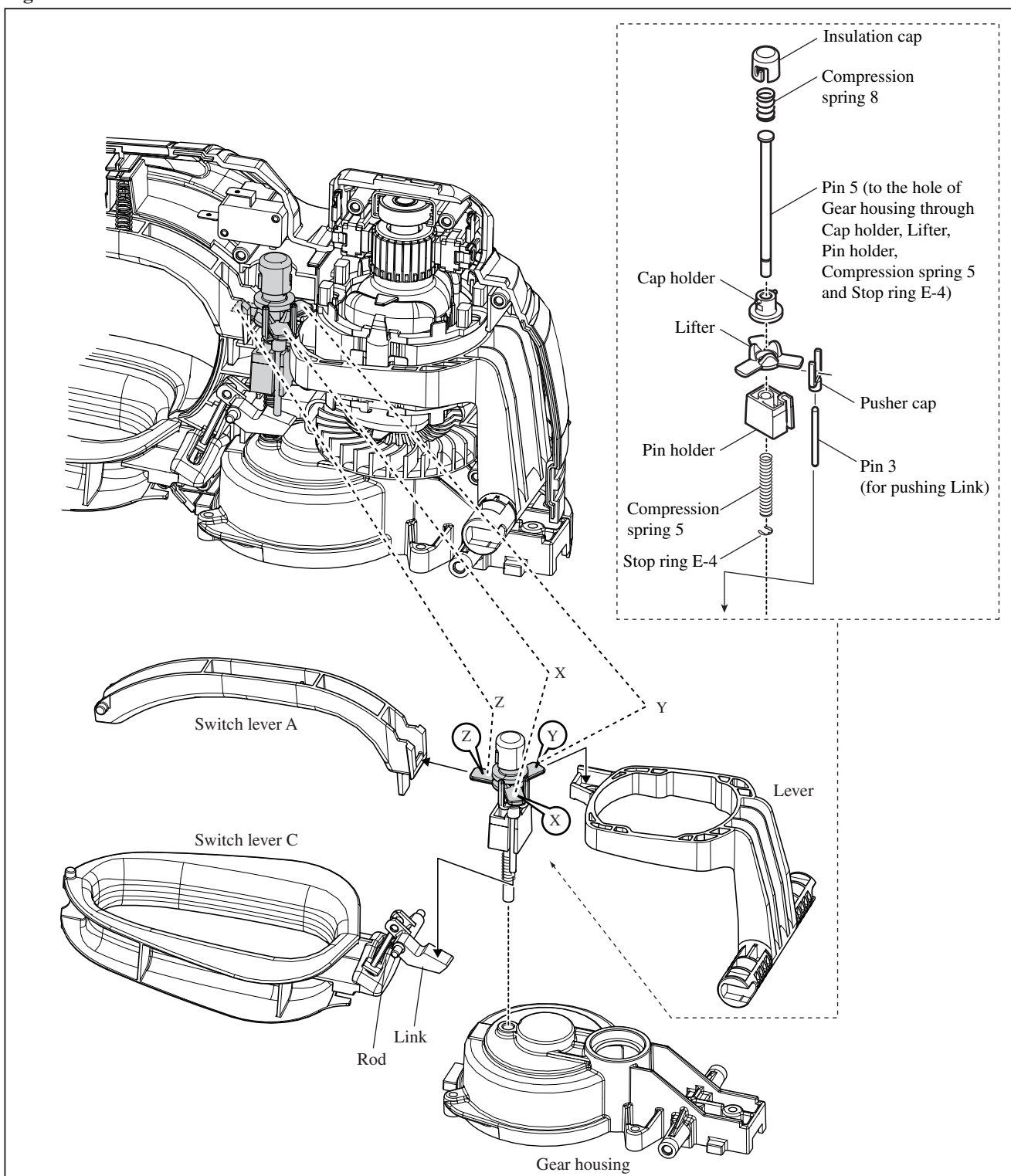

► Repair

[3] DISASSEMBLY/ASSEMBLY

[3] -5. Switch lever B, Front grip and Protector

DISASSEMBLING

Refer to **Fig. 10**.

ASSEMBLING

- 1) When separating Front grip from Switch lever B;
 - hook one end of Compression spring 9 with the protrusion of Front grip.
 - hook the tab of Switch lever B with the edge of Front grip. And hook the other end of Compression spring 9 with the protrusion of Switch lever B. (**Fig. 19**)
- 2) Hook Front grip, Switch lever B and Protector complete with Housing set, and then tighten two M5x30 Pan head screws to assemble Front grip, Switch lever B and Protector complete to Housing set. (**Fig. 10**)
- 3) Set Shear blade ass'y in place. Refer to **the clause of [3]-2**.

Fig. 19

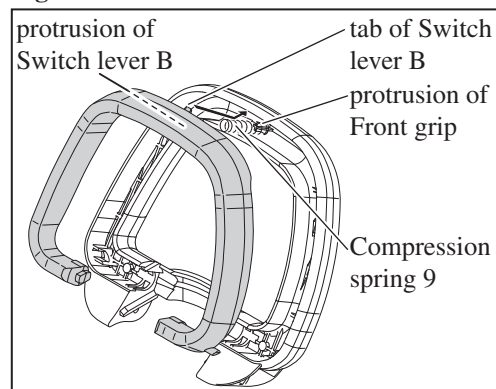

► Circuit diagram

Fig. D-1

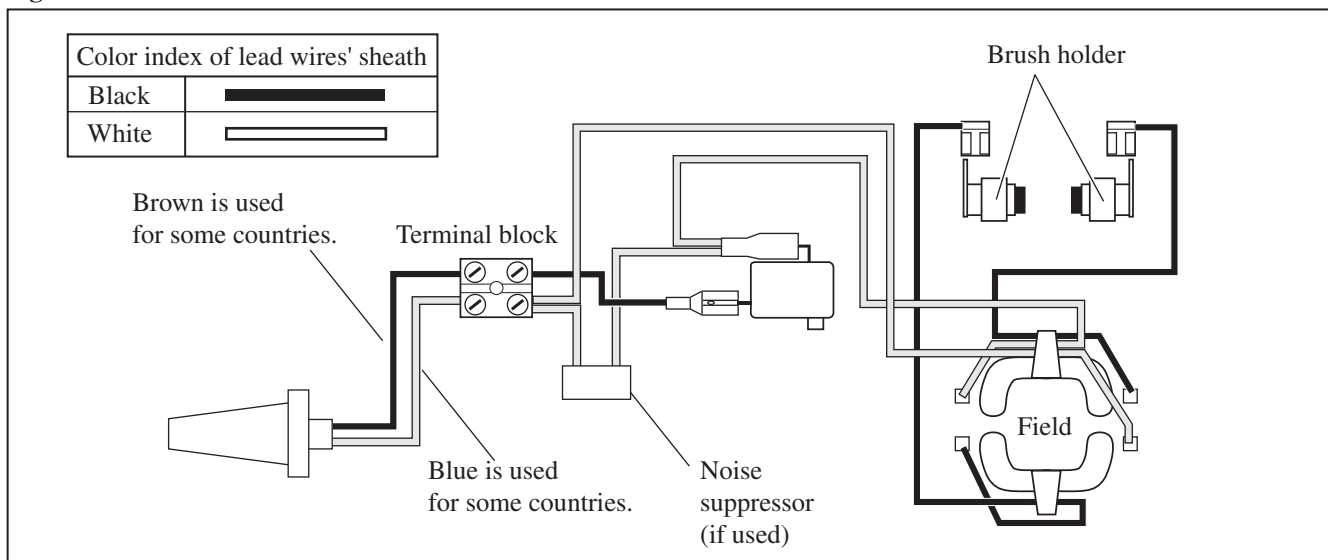

► Wiring diagram

Fig. D-2

