

TECHNICAL INFORMATION



PRODUCT
P 1 / 13

- Model No.** ▶ UH520D
UH422D/ UH482D/ UH522D
BUH481/ BUH521
BUH483/ BUH523

- Description** ▶ Cordless Hedge Trimmer 520mm (20-1/2")
Cordless Hedge Trimmers 420mm/ 480mm/ 520mm
(16-1/2"/ 18-7/8"/ 20-1/2")
Cordless Hedge Trimmers 480mm/ 520mm (18-7/8"/ 20-1/2")
Cordless Hedge Trimmers 480mm/ 520mm (18-7/8"/ 20-1/2")

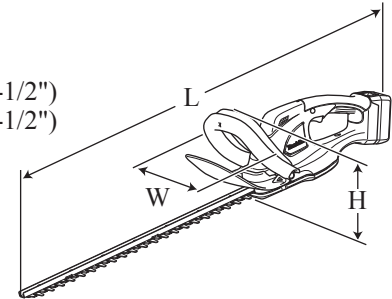

CONCEPT AND MAIN APPLICATIONS

The subject models are 14.4V/18V cordless hedge trimmers.

Their main features are:

- Anti-vibration structure
- User-replaceable blade

These products are compatible with the batteries and the chargers in the list below.

Model No.	Compatible battery	Compatible charger
UH520D	BL1411G	DC18WA
UH422D/ 482D/ 522D	BL1811G	
BUH481/ 521	BL1415 BL1430	DC18RC, DC18SD, DC24SC, DC18SE
BUH483/ 523	BL1815 BL1830	

Dimensions: mm (")		
Length (L)	UH520D	923 (36-1/4)
	UH422D/ 482D/ 522D	829 (32-5/8)/ 879 (34-1/2)/ 929 (36-1/2)
	BUH481/ 521	881 (34-3/4)/ 931 (36-3/4)*2 869 (34-1/4)/ 919 (36-1/4)*3
	BUH483/ 523	888 (35)/ 938 (37)*1 873 (34-3/8)/ 923 (36-1/4)*3
Width (W)	195 (7-5/8)	
Height (H)	193 (7-5/8)	

*2 with 3.0Ah Li-ion battery *3 with 1.3Ah Li-ion battery

Specification

Specification		Model	—/—/ UH520D	UH422D/ 482D/ 522D	—/ BUH481/ 521	—/ BUH483/ 523
Battery	Cell	Li-ion				
	Voltage: V		14.4	18	14.4	18
	Capacity: Ah		1.1	1.1	1.3, 3.0	1.3, 3.0
	Energy capacity: Wh		16	20	19, 44	24, 54
	Charging time (approx.): min.		60 with DC18WA	60 with DC18WA	15, 22 with DC18RC	15, 22 with DC18RC
Max output (W)		190	210	190	210	
Blade length: mm (")		420 (16-1/2)/ 480 (18-7/8)/ 520 (20-1/2)				
No load speed: min ⁻¹ =spm*3		1,350				
Max. cutting diameter*4: mm (")		ø15 (9/16)				
Weight according to EPTA-Procedure 01/2003*5: kg (lbs)		--- / --- / 3.0 (--- / --- / 6.7)	3.0/ 3.0/ 3.1 (6.6/ 6.7/ 6.8)	---/3.0/3.0(---/6.5/6.7), ---/3.1/3.2(---/6.9/7.1)	---/3.0/3.1(---/6.7/6.8), ---/3.2/3.3(---/7.1/7.3)	

*3: spm= strokes per minute

*4: Indicates maximum diameter of the branch that can be received between adjacent two blade teeth. (See the figure on right.)



*5: with battery, shear blade assembly

Standard equipment

- Blade cover 1
Battery cover 1 (same quantity as that of spare battery)

Note: The standard equipment for the tool shown above may vary by country.

Optional accessories

- | | |
|--|---|
| Shear blade complete set | Battery BL1815 (for BUH483/ 523) |
| Blade cover | Battery BL1830 (for BUH483/ 523) |
| Chip receiver assembly set | Charger DC18WA (for UH422D/ 482D/ 520D/ 522D) |
| Battery BL1411G (for UH520D) | Fast charger DC18RC (for BUH481/ 483/ 521/ 523) |
| Battery BL1811G (for UH422D/ 482D/ 522D) | Charger DC18SD (for BUH481/ 483/ 521/ 523) |
| Battery BL1415 (for BUH481/ 521) | Charger DC24SC (for BUH481/ 483/ 521/ 523) |
| Battery BL1430 (for BUH481/ 521) | Automotive charger DC18SE (for BUH481/ 483/ 521/ 523) |

► **Repair**

CAUTION: Repair the machine in accordance with “Instruction manual” or “Safety instructions”.

[1] NECESSARY REPAIRING TOOLS

Code No.	Description	Use for
1R035	Bearing Setting Plate	Supporting Spur gear 93, when removing Spindle with Arbor press

[2] LUBRICATION

Apply the following grease to the portions designated with the black triangle to protect parts and product from unusual abrasion.

Item No.	Description	Portion to lubricate	Grease	Amount
⑳	Spindle	㉑ The drum portion which is accepted by Bearing box	Makita grease N No.2	a little
		㉒ The drum portion which is accepted by Under cover		
㉔	Spur gear 93	Teeth portion for smooth engaging with DC motor’s gear		3 g
㉗A	Spacer of Blade	Both side where Crank plate A and Crank plate B contact		a little

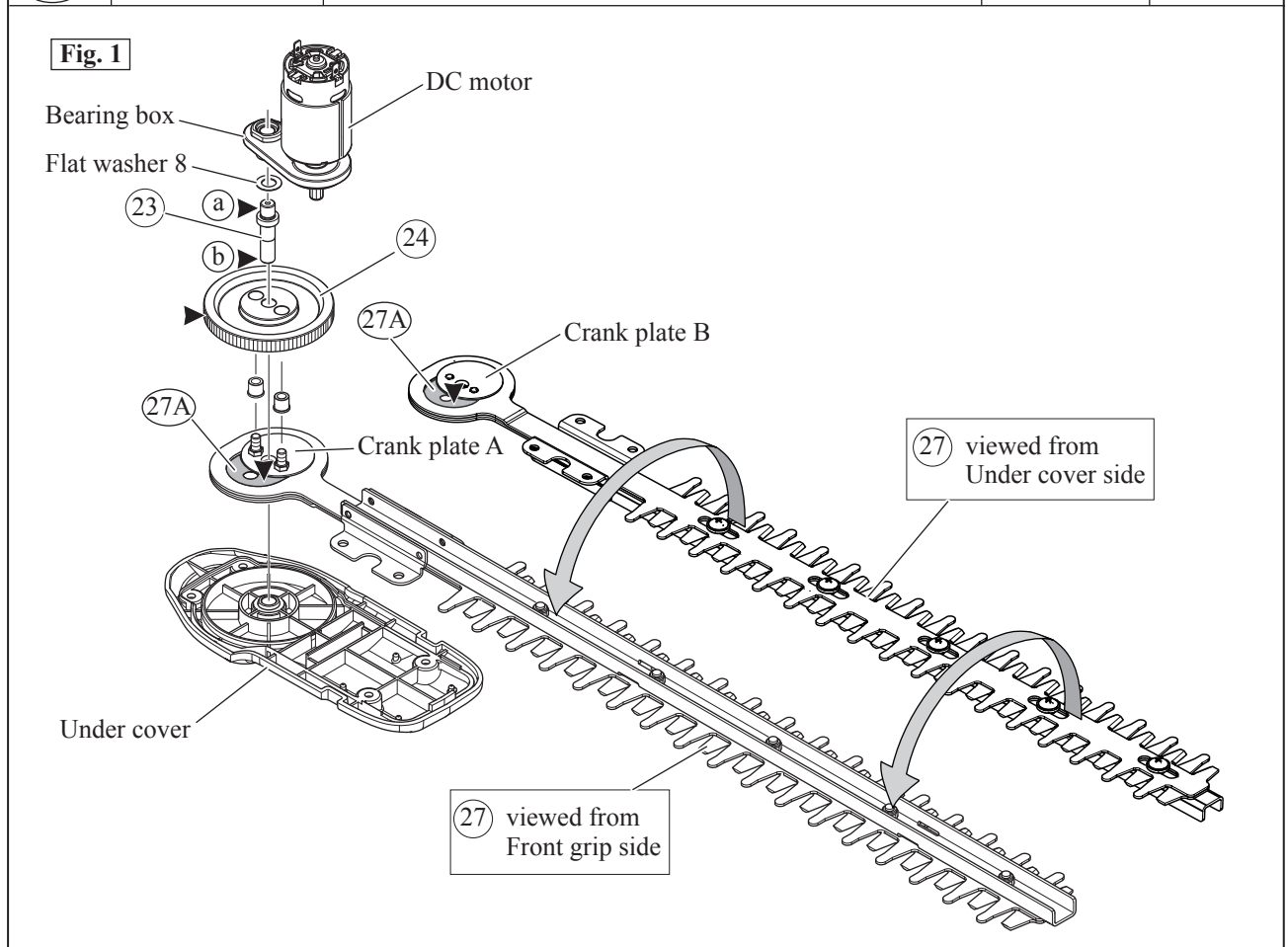

► **Repair**

[3] DISASSEMBLY/ASSEMBLY

[3] -1. Shear blade complete

DISASSEMBLING

Disassemble Shear blade complete as drawn in Fig. 2.

Fig. 2

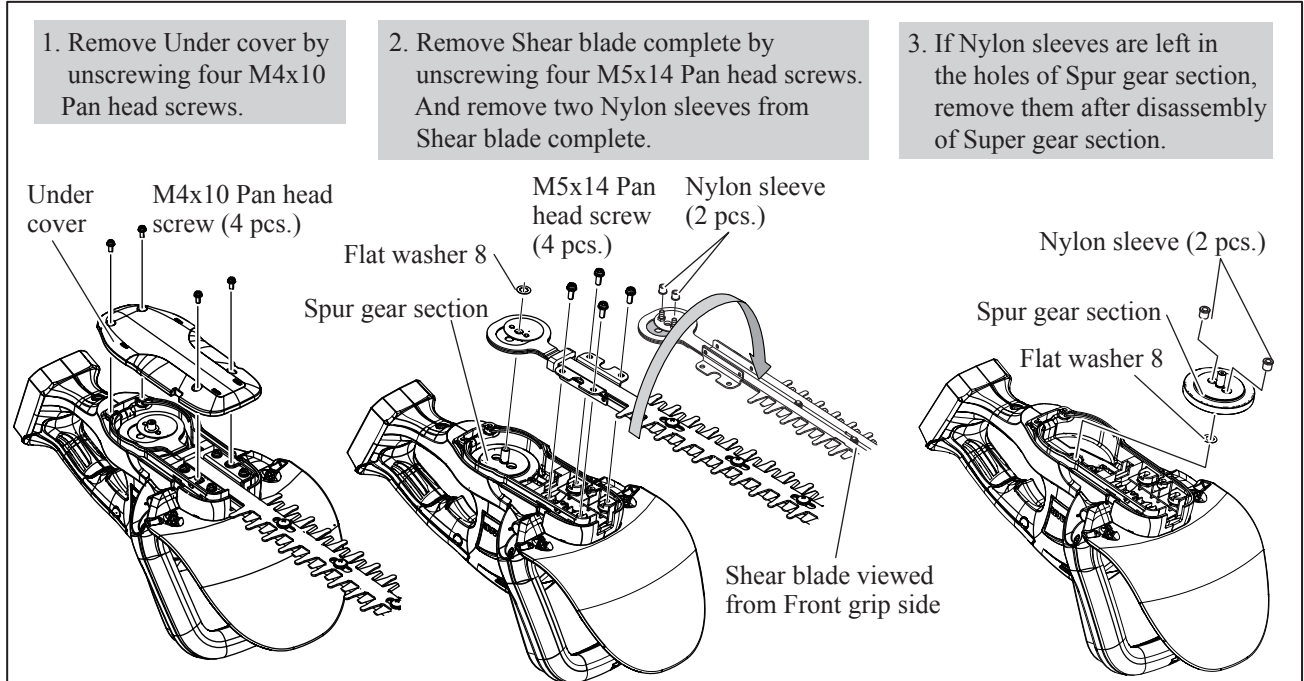

ASSEMBLING

Assemble Shear blade complete to the machine as drawn in Fig. 3.

Fig. 3

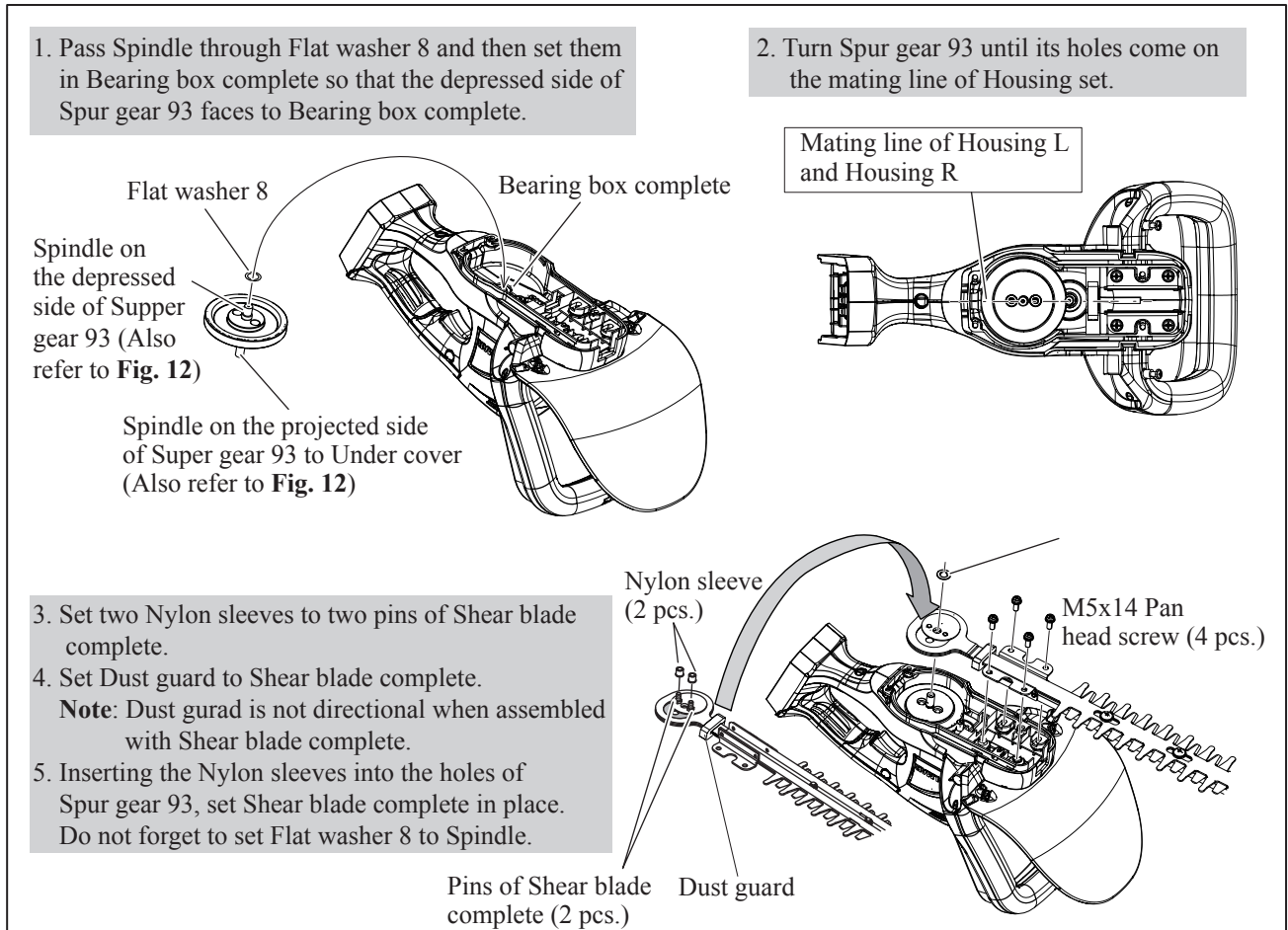

► **Repair**

[3] DISASSEMBLY/ASSEMBLY

[3] -2. DC motor

DISASSEMBLING

- (1) Disassemble Shear blade complete and Spur gear 93 as drawn in **Fig. 2**.
- (2) Remove Protector and Front grip section as drawn in **Fig. 4**.

Fig. 4

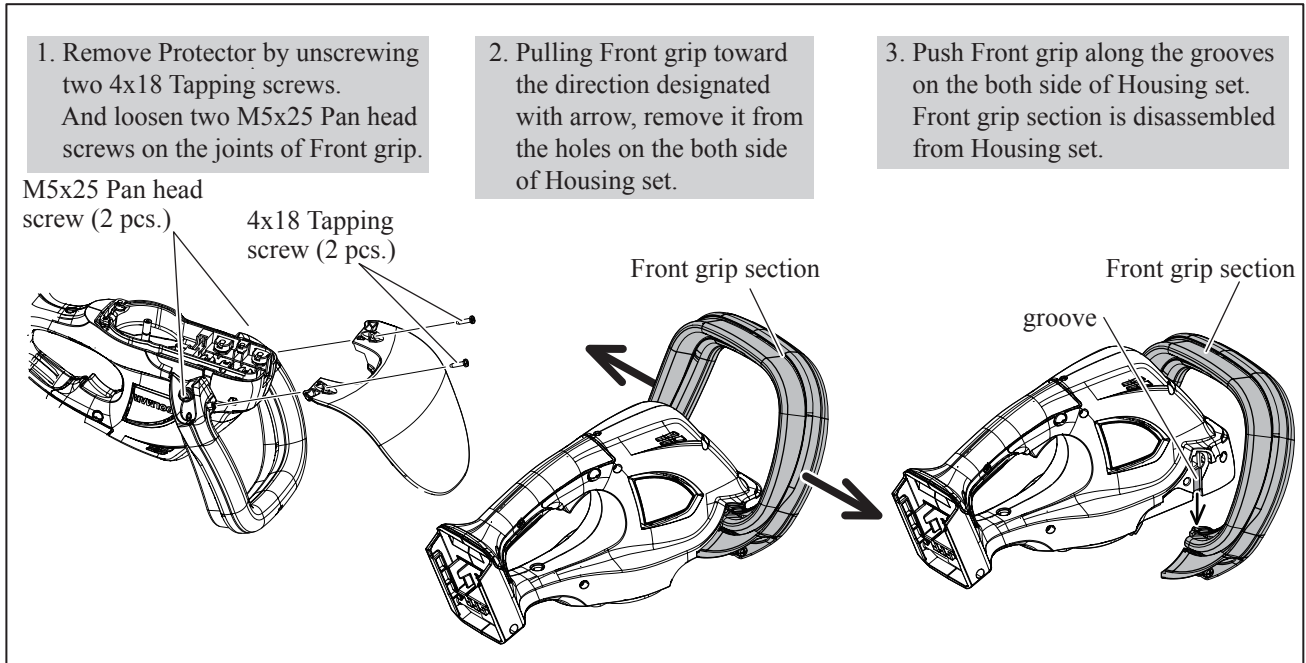

- (3) Separate Housing R from Housing L. Then, remove Motor housing section from Housing L. See **Fig. 5**.

Fig. 5

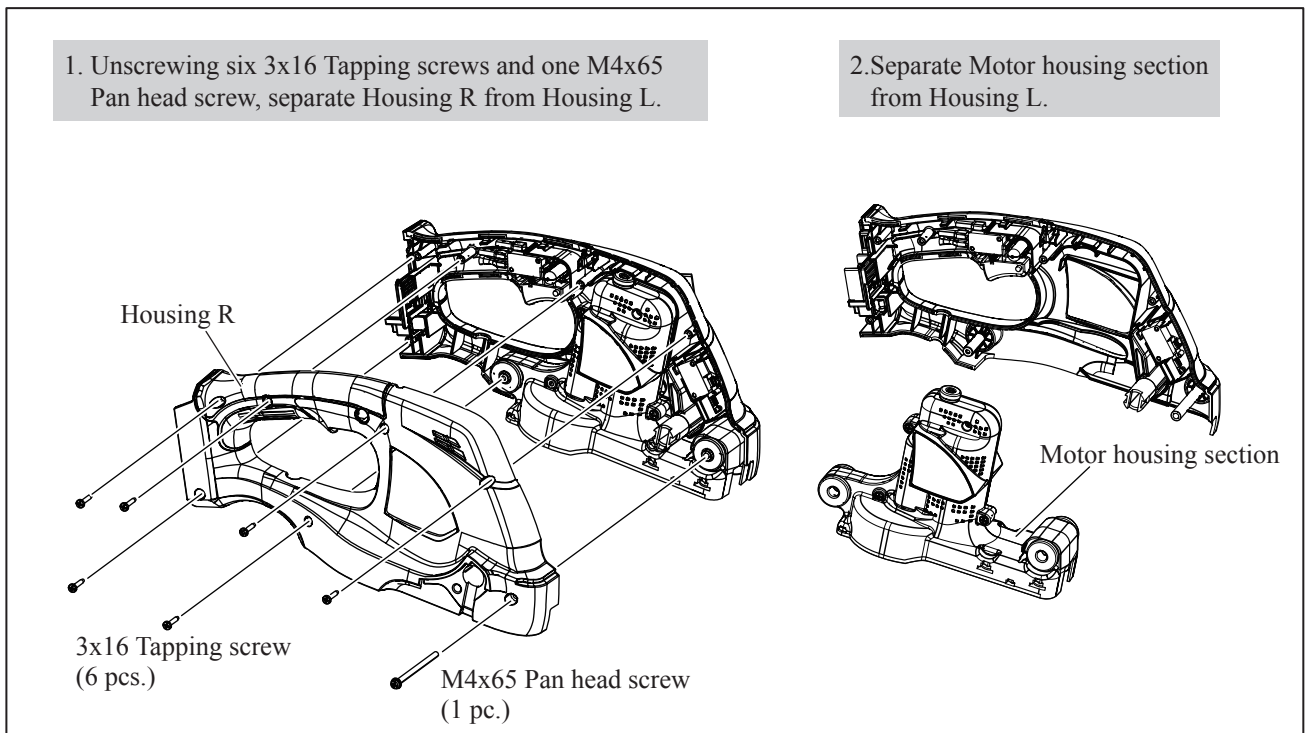

► **Repair**

[3] DISASSEMBLY/ASSEMBLY

[3] -2. DC motor (cont.)

DISASSEMBLING

(4) Disassemble DC Motor from Motor housing as drawn in **Fig. 6**.

Fig. 6

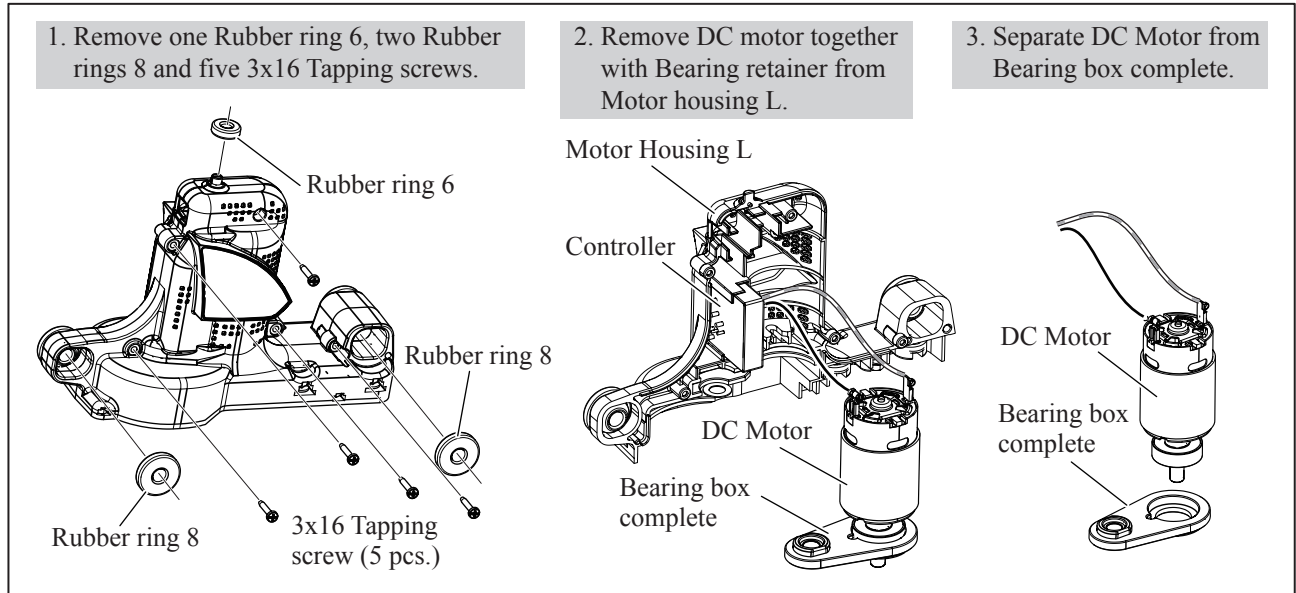

ASSEMBLING

(1) Assemble DC Motor in the reverse order of Disassembly. (Refer to **Figs. 6, 5 and 4**)
And also refer to **Fig. 7**.

Fig. 7

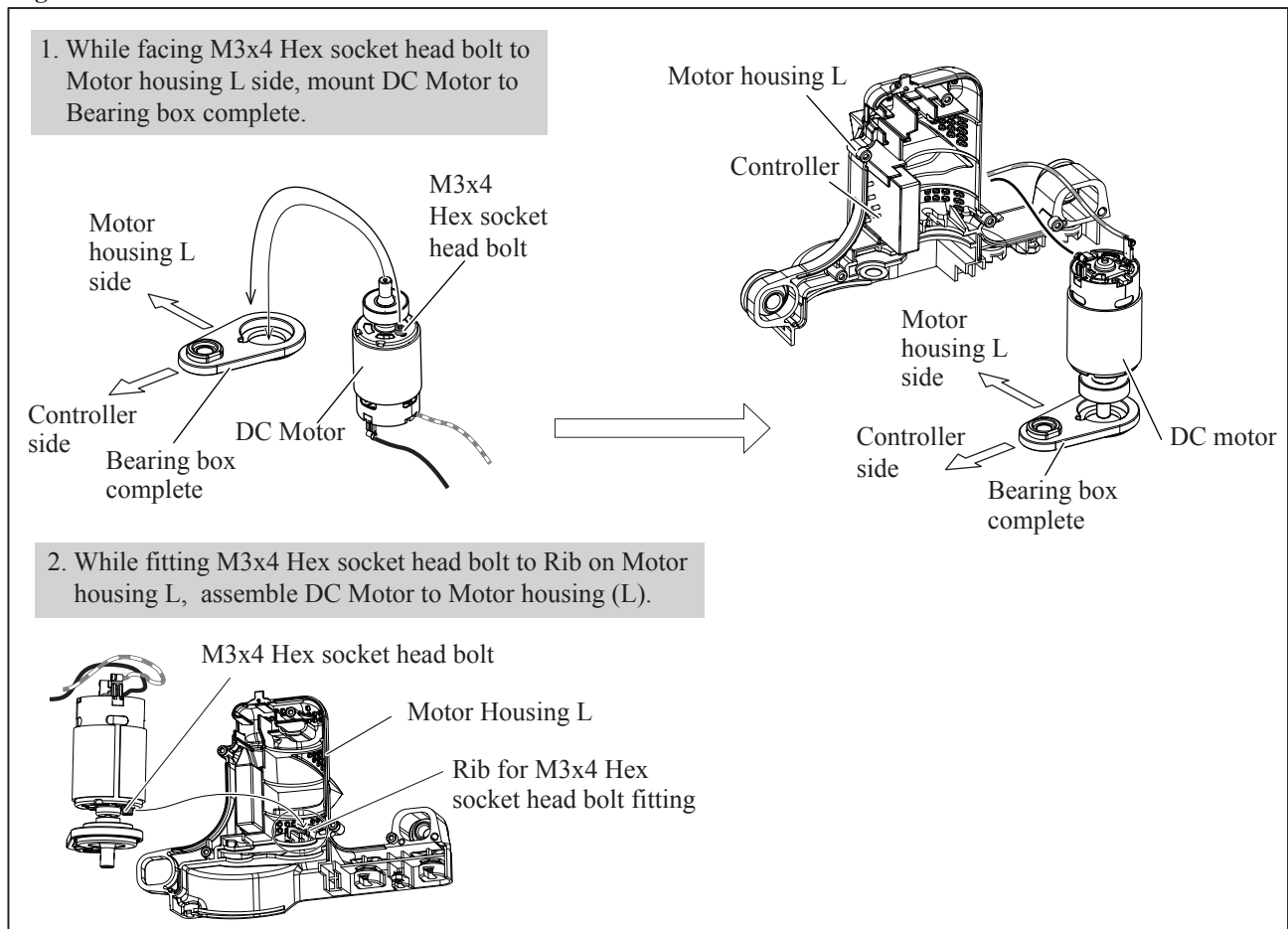

► **Repair**

[3] DISASSEMBLY/ASSEMBLY

[3] -2. DC motor (cont.)

ASSEMBLING

(2) Fix Motor housing R and Motor housing L with Rubber rings as drawn in **Fig. 8**.

Fig. 8

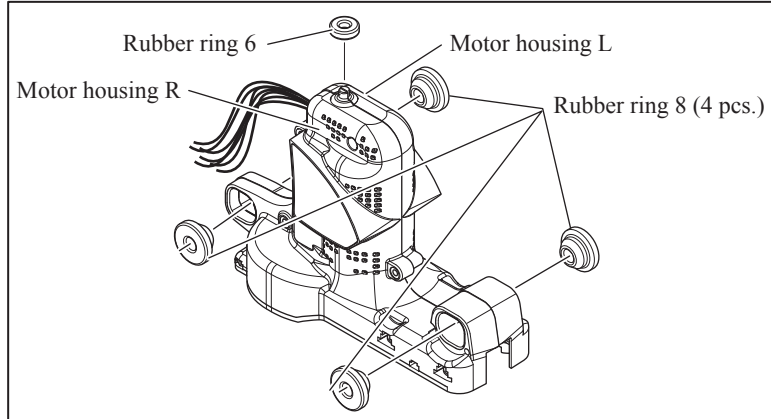

(3) Setting Motor housing section to Housing L, set Housing R in place with six 3x16 Tapping screws and one M4x65 Pan head screw as drawn in **Fig. 9**.

Fig. 9

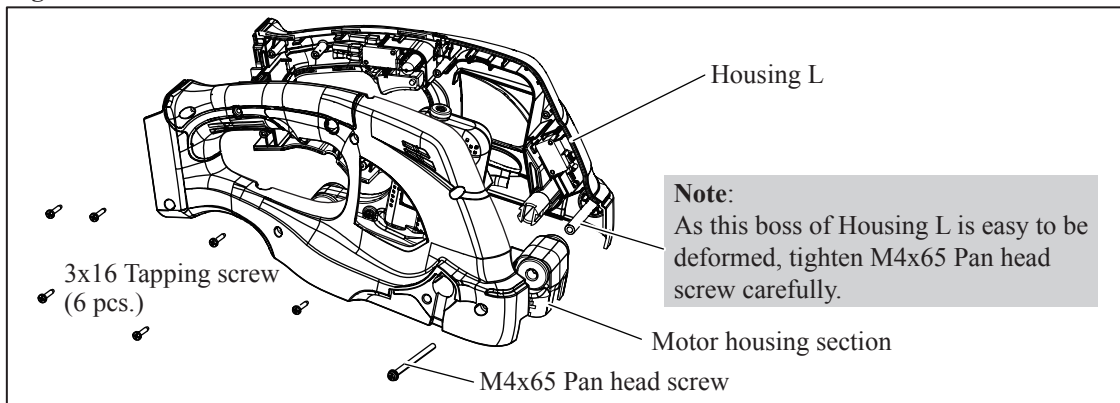

(4) Assemble Front grip section as drawn in **Fig. 10**.

Fig. 10

1. Align the joints of Switch lever B and Front grip in line for smooth moving in the grooves on Housing set.

2. Pulling Front grip section to both side, fit the Joints of Switch lever B and Front grip to the grooves on Housing set.

3. Pulling Front grip section to both side, fit Front grip section to the holes on Housing set. And tighten two M5x25 Pan head screw on both side of Housing set.

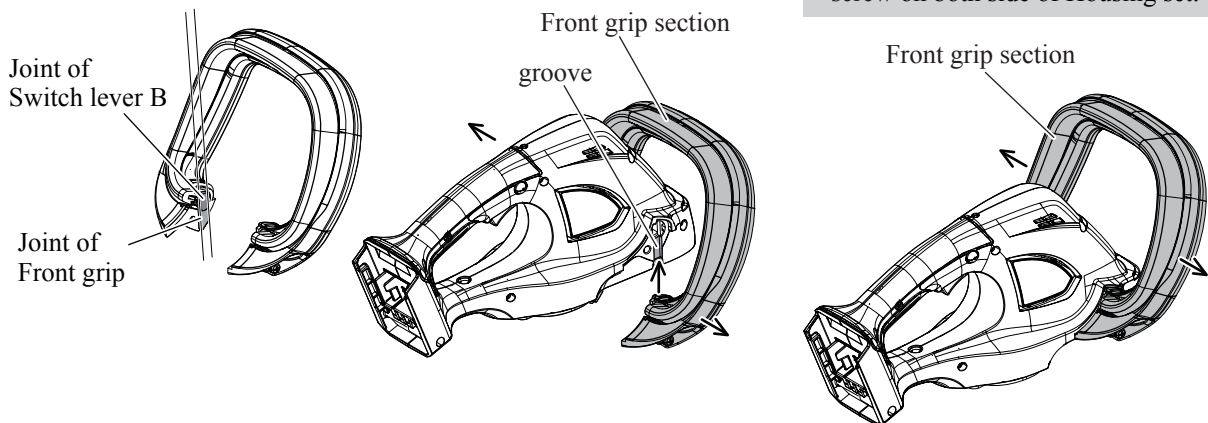

► **Repair**

[3] DISASSEMBLY/ASSEMBLY

[3] -3. Spur Gear 93

DISASSEMBLING

- (1) Disassemble Shear blade complete, and then, remove Spur gear section as drawn in **Fig. 2**.
- (2) Disassemble Spur gear 93 as drawn in **Fig. 11**.

Fig. 11

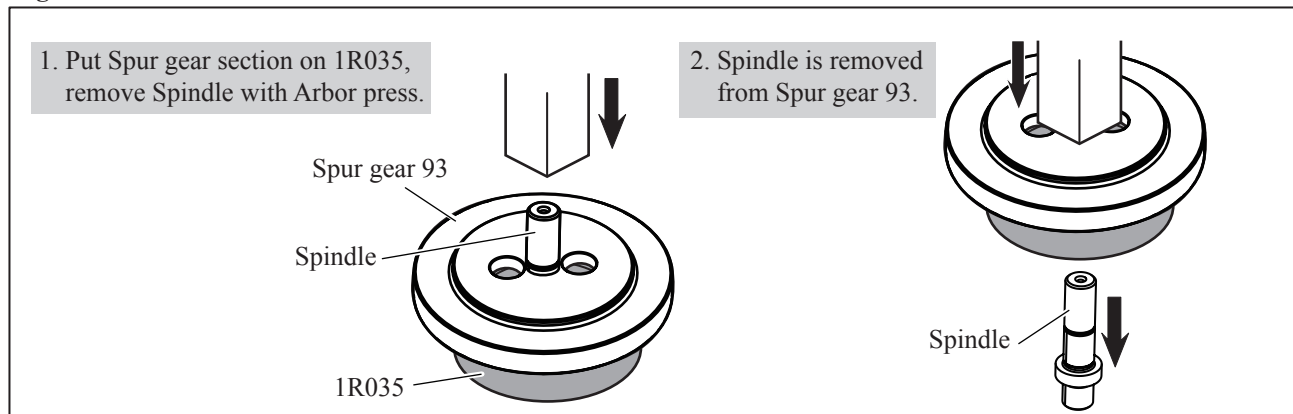

ASSEMBLING

- (1) Assemble Spindle to Spur gear 93 as drawn in **Fig. 12**.

Fig. 12

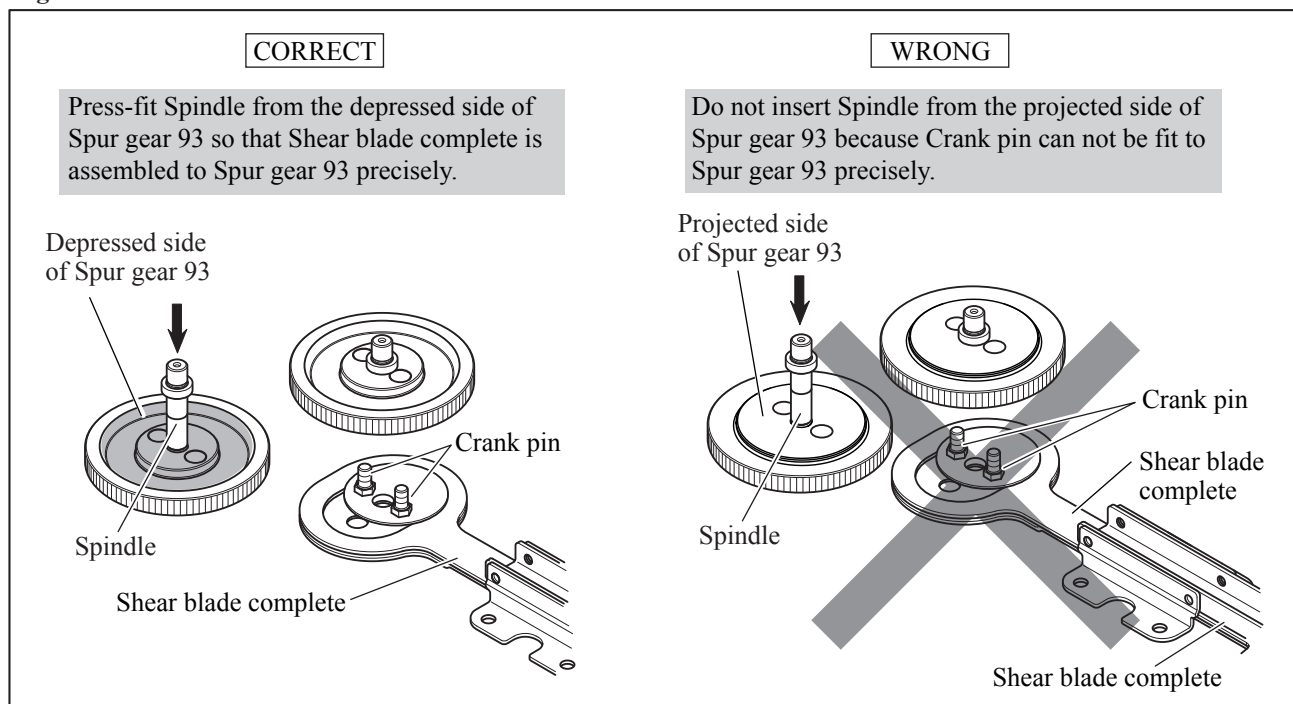

- (2) Face its grooved side of Spur gear 93 to Bearing box complete and assemble Spur gear section to Bearing box complete.

Note: Be sure to set two Flat washers 8 on both Spindle ends, two Nylon sleeves into holes of Shear blade complete as drawn in **Fig. 3**.

► **Repair**

[3] DISASSEMBLY/ASSEMBLY

[3] -4. Front grip

DISASSEMBLING

(1) Remove Front grip section without disassembling Under cover as drawn in **Fig. 13**.

Fig. 13

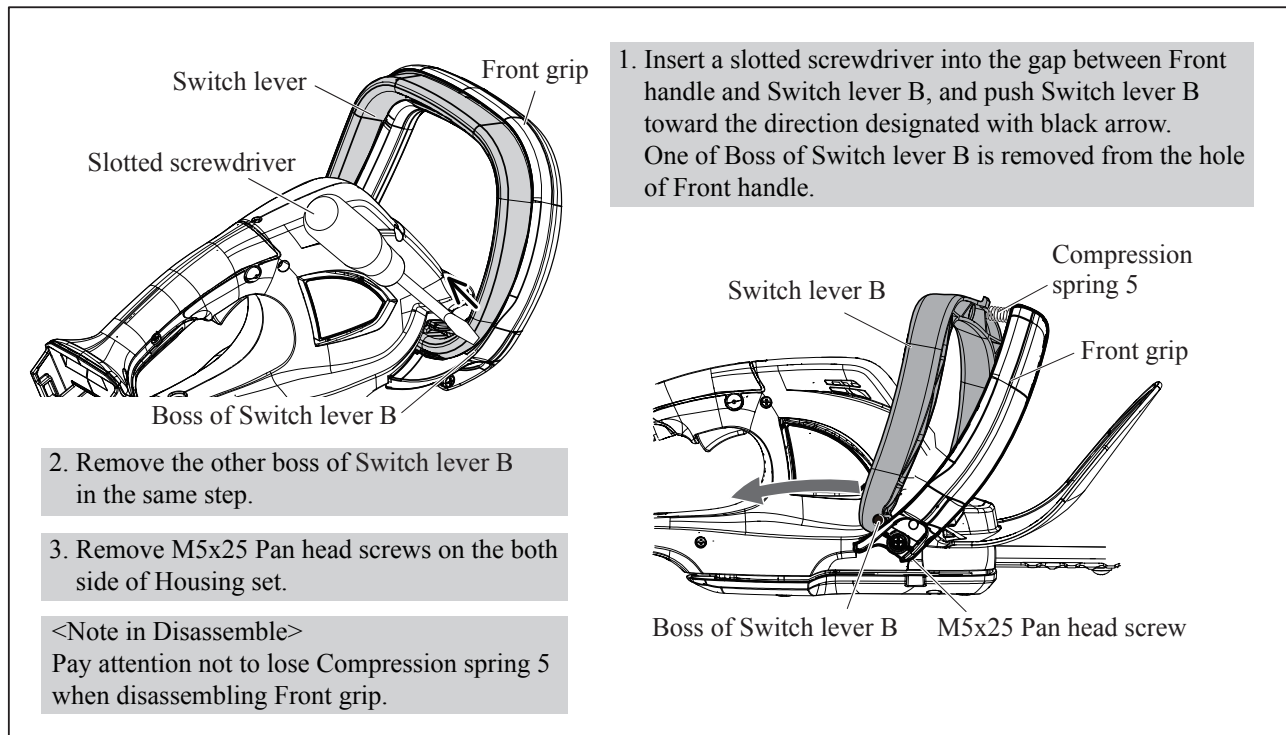

ASSEMBLING

(1) Assemble Front grip as drawn in **Fig. 14**.
(2) Assemble Protector to Front grip. Refer to **Fig. 4**.

Fig. 14

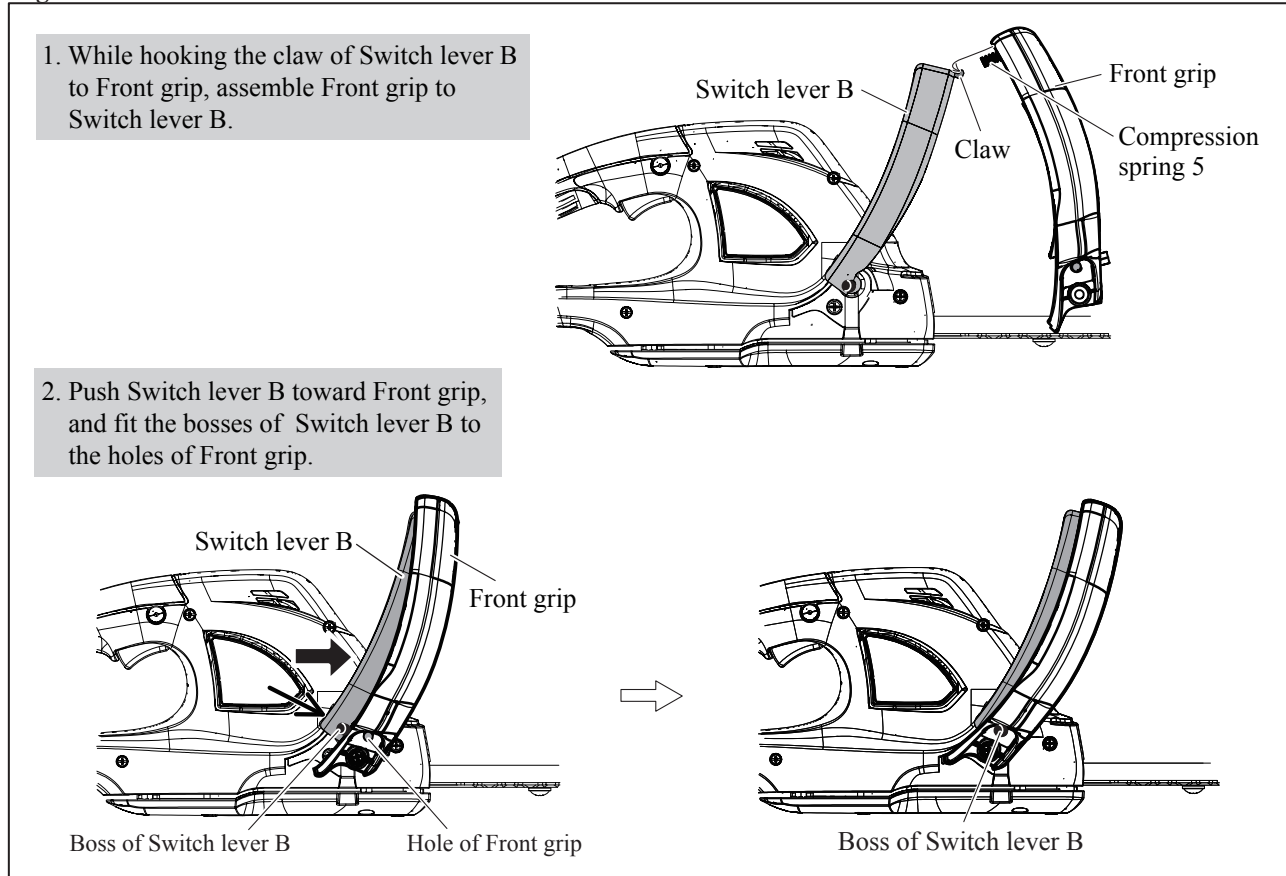

► Repair

[3] DISASSEMBLY/ASSEMBLY

[3] -5. Switch arm

DISASSEMBLING

- (1) Disassemble Front grip section as drawn in **Fig. 4**.
- (2) Remove Housing R as drawn in **Fig. 5**.
- (3) Switch arm is removed as drawn in **Fig. 15**.

Fig. 15

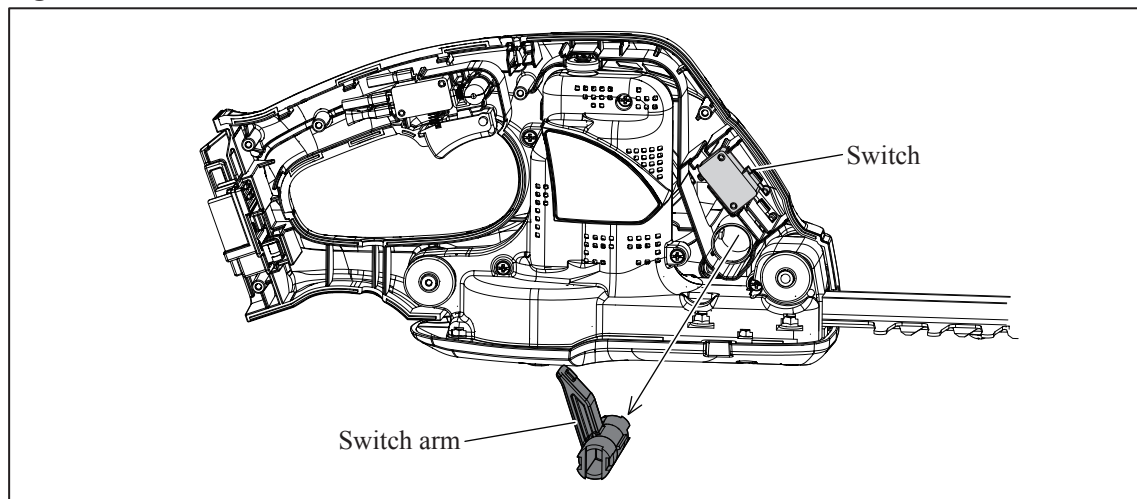

ASSEMBLING

Switch arm has to be assembled to Housing L so that it can push ON/OFF button of Switch to link with Switch lever B's action. See **Fig. 16**.



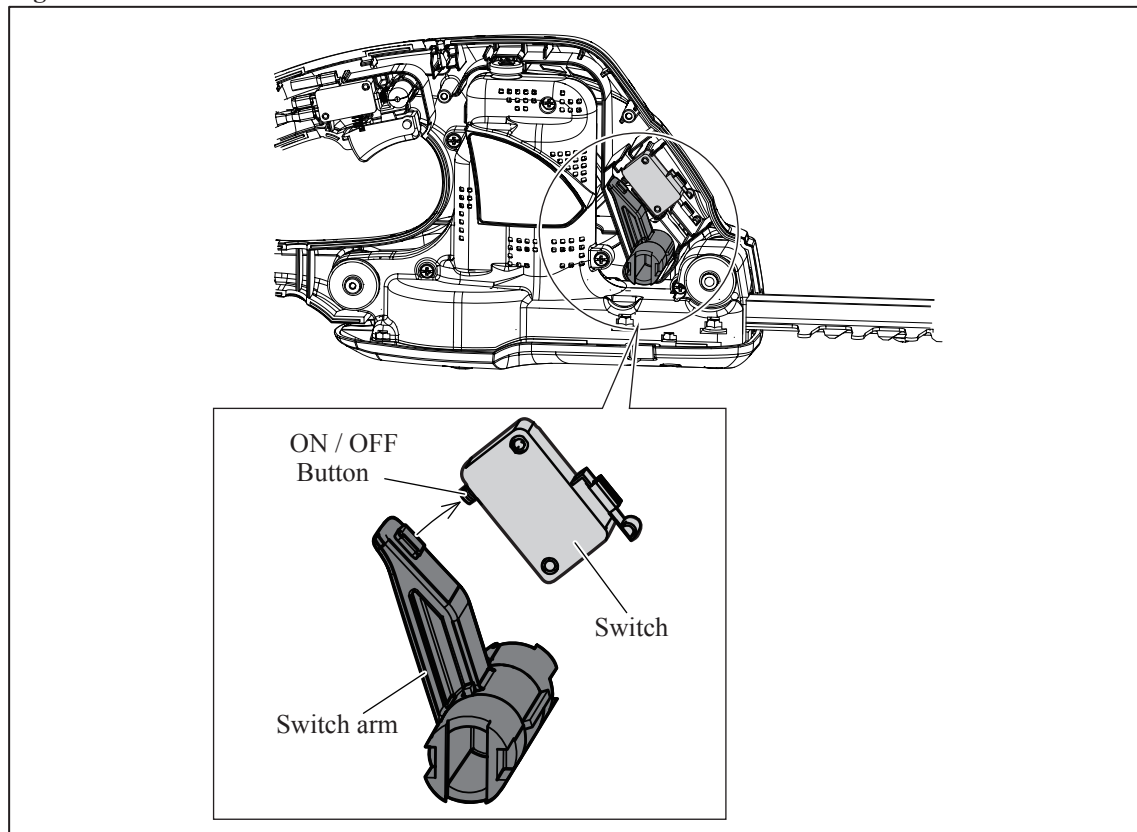



Fig. 16



► **Circuit diagram**

Fig. D-1

Model No.	Power source Battery
BUH481/ 521	BL1415, BL1430 14.4 V
BUH483/ 523	BL1815, BL1830 18 V

Color index of lead wires' sheath			
Black		Orange	
Purple		White	
		Red	
		Yellow	

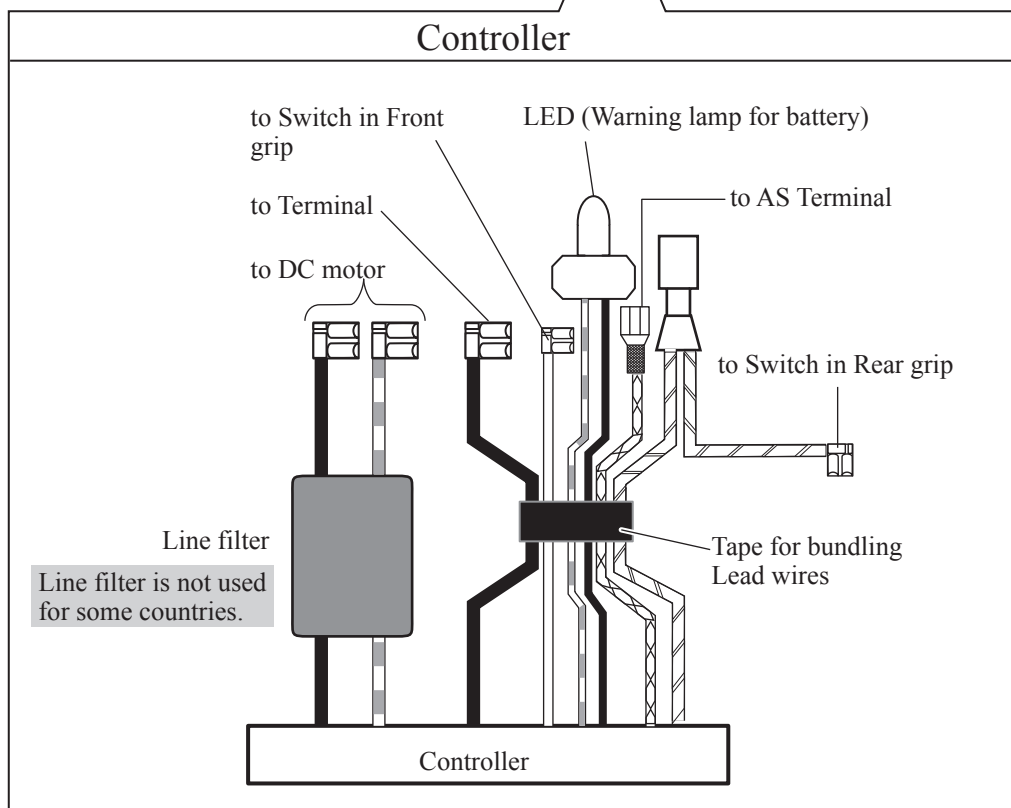
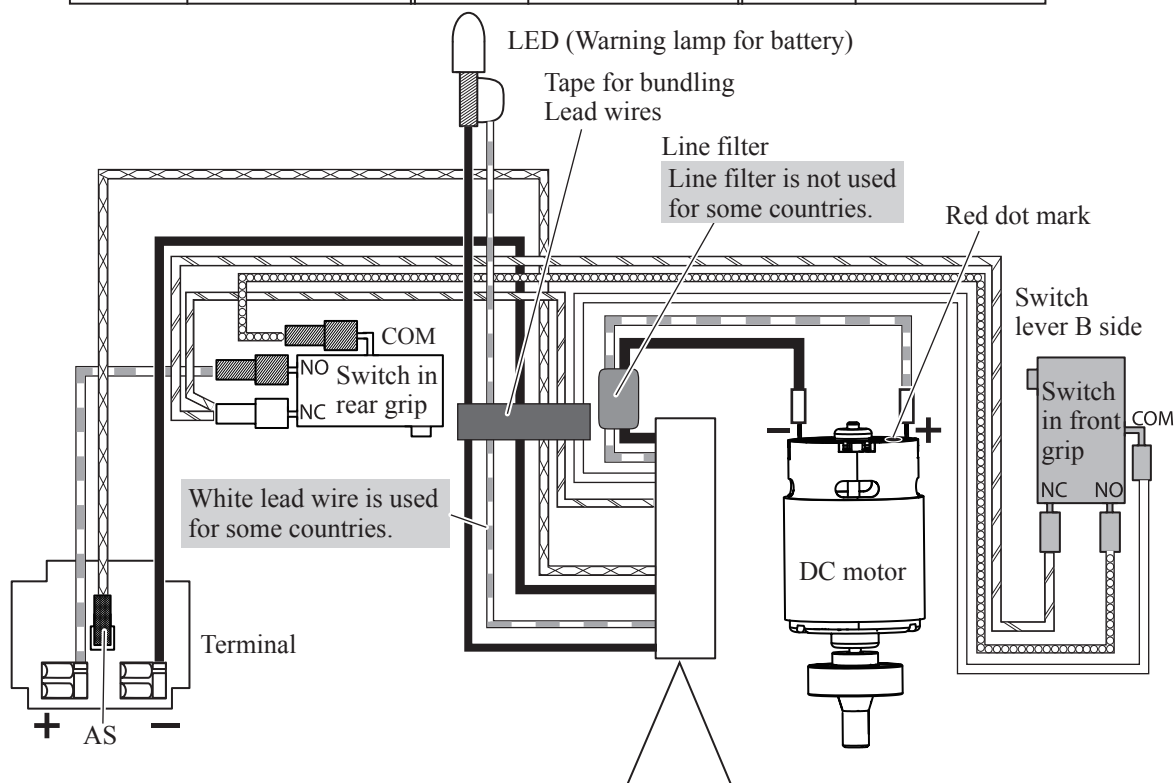

► **Circuit diagram (cont.)**

Fig. D-2

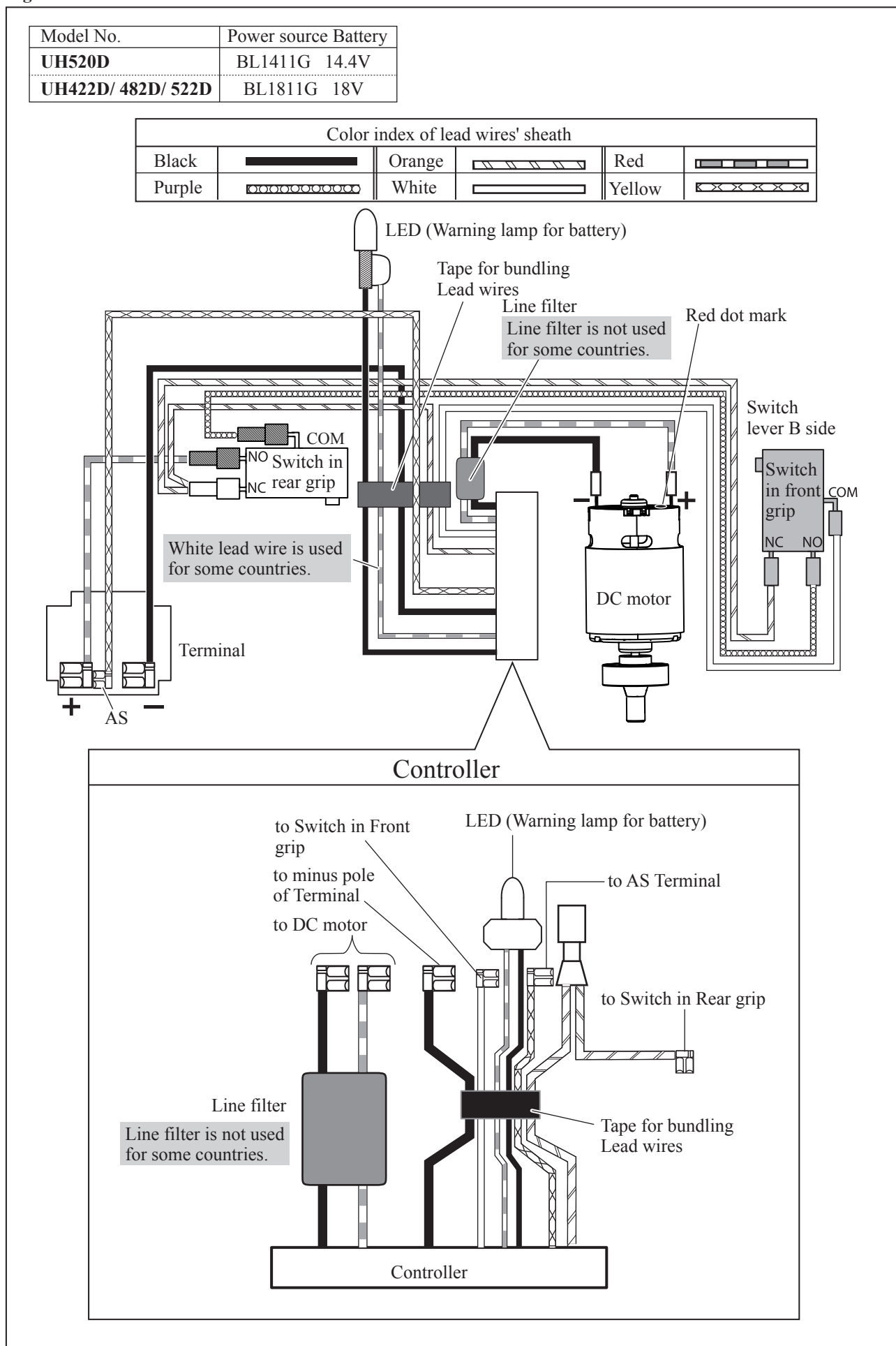

► **Wiring diagram**

Fig. D-3

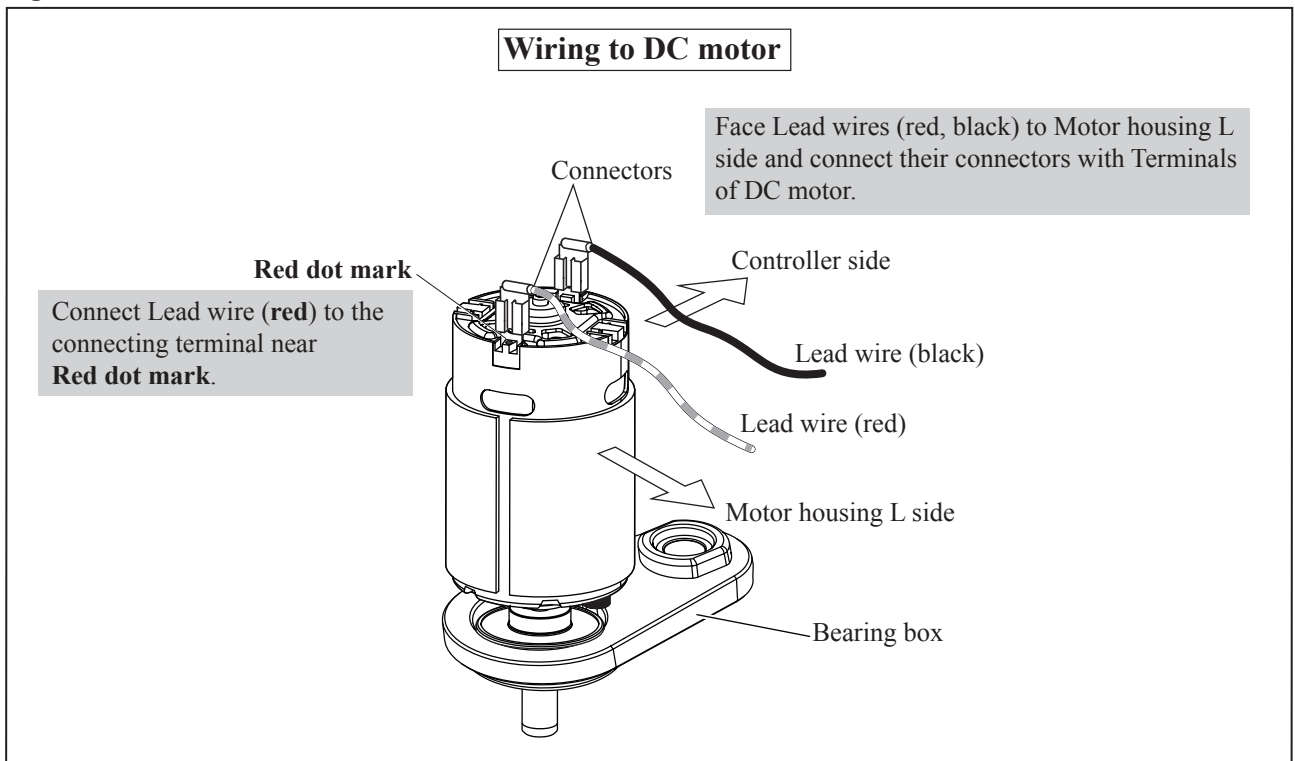
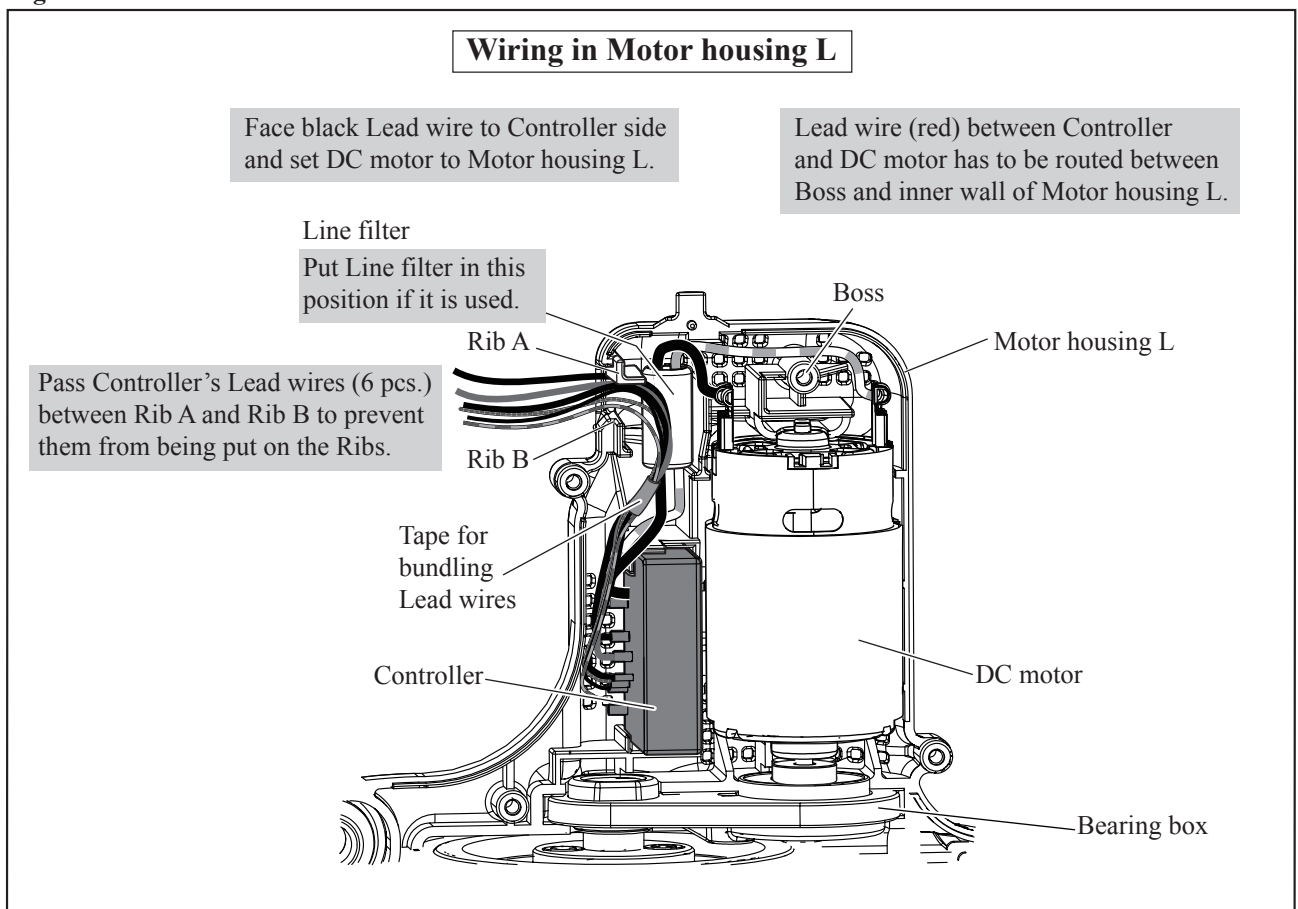

Fig. D-4



► **Wiring diagram (cont.)**

Fig. D-5

